

333 North Green Street



Convene at 333 North Green Street offers over 40,000 square feet of purpose-built meeting and event space for small to large programs. This property includes a dedicated meetings and events floor, sweeping views of downtown, optimal branding opportunities, and a unique design. The state-of-the-art meeting space is fully outfitted with seamless technology, an onsite AV team, and 5-star hospitality that will elevate your next meeting and event experience.

7
MEETING ROOMS

400
MAX ROOM CAPACITY

40,000
SQUARE FEET



HIGH SPEED
WIFI



STATE OF THE ART
TECHNOLOGY



FLEXIBLE MEETING
& EVENT SPACE



EVENT PLANNING
SERVICES



ON-SITE
GOURMET CHEF



UNLIMITED ON/SITE
DRINKS & SNACKS





Floorplan & capacities

6TH FLOOR

LEGEND

 BATHROOMS

 COAT CLOSET

 ELEVATOR

 ENTRANCE

GENERAL ACCESS

BATHROOMS

MEETING & EVENT ACCESS

GALLERY SPACE

MEETING ROOMS

NOURISH

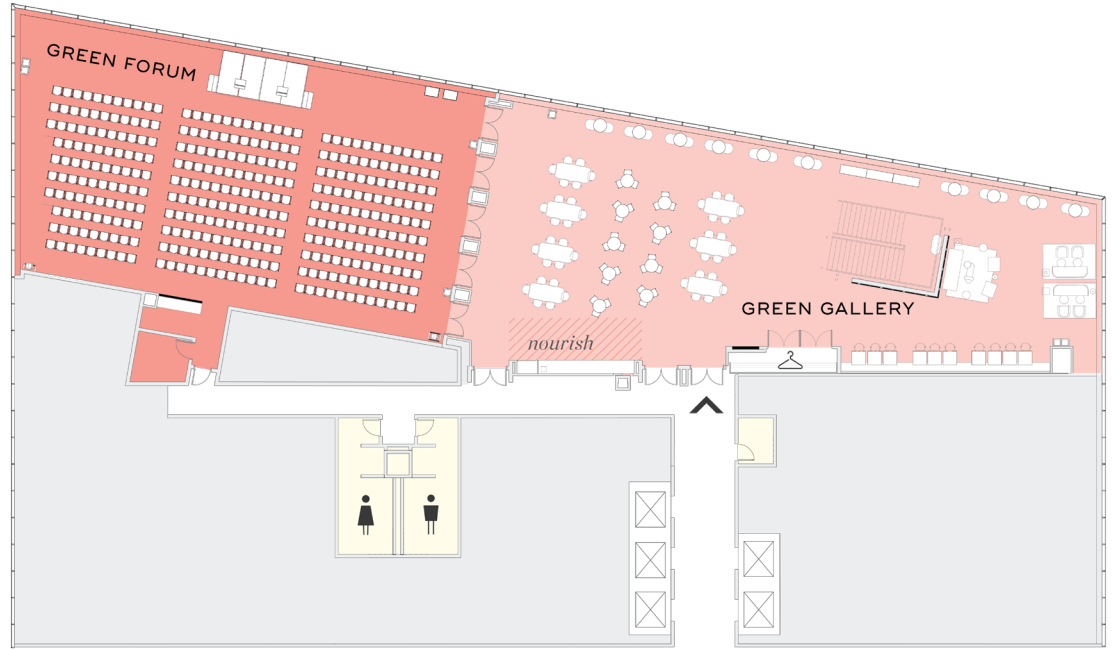

W. WAYMAN ST.

| | MAX OCCUPANCY | DIMENSION [FT] | AREA [SQ FT] | CEILING HT [FT] | RECEPTION (MAX OCCUPANCY) | THEATER | CLASSROOM | ROUNDS | PODS [6-TOP] |
|---------------|---------------|----------------|--------------|-----------------|---------------------------|---------|-----------|--------|--------------|
| Green Forum | 400 | 46' x 88' | 4,177' | 17' | 400 | 306 | 198 | 168 | 180 |
| Green Gallery | 100 | 48' x 117' | 4,741' | 17' | 100 | - | - | - | - |

Floorplan & capacities

7TH FLOOR

LEGEND

| | |
|---|--------------------------------------|
| <p> BATHROOMS</p> <p> RESPITE ROOM</p> <p> ELEVATOR</p> | <p> COAT CLOSET</p> <p> ENTRANCE</p> |
|---|--------------------------------------|

GENERAL ACCESS

BATHROOMS & RESPITES

MEETING & EVENT ACCESS

GALLERY SPACE

MEETING ROOMS

NOURISH & WELCOME

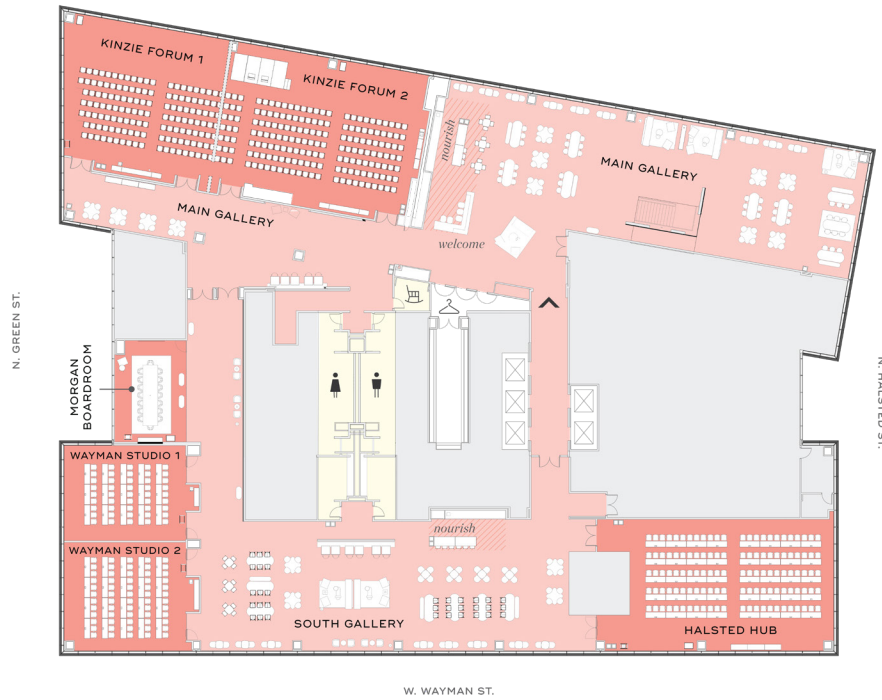

| | MAX OCCUPANCY | DIMENSION [FT] | AREA [SQ FT] | CEILING HT [FT] | RECEPTION (MAX OCCUPANCY) | THEATER | CLASSROOM | ROUNDS | U-SHAPE | CONFERENCE | PODS [6-TOP] |
|------------------|---------------|----------------|--------------|-----------------|---------------------------|---------|-----------|--------|---------|------------|--------------|
| Kinzie Forum | 400 | 42' x 109' | 4,592' | 13' | 400 | 269 | 189 | 208 | - | - | 198 |
| Kinzie Forum 1 | 165 | 42' x 50' | 2,058' | 13' | 165 | 142 | 75 | 88 | 39 | 36 | 72 |
| Kinzie Forum 2 | 235 | 42' x 58' | 2,535' | 13' | 235 | 168 | 96 | 112 | 42 | 42 | 108 |
| Halsted Hub | 250 | 39' x 60' | 2,534' | 13' | 250 | 168 | 105 | 120 | 42 | 42 | 108 |
| Wayman Studio 1 | 80 | 36' x 29' | 1,076' | 13' | 80 | 80 | 36 | 40 | 27 | 24 | 36 |
| Wayman Studio 2 | 80 | 36' x 31' | 1,181' | 13' | 80 | 80 | 45 | 40 | 27 | 24 | 36 |
| Morgan Boardroom | 20 | 21' x 30' | 624' | 11' | 20 | - | - | - | - | 16 | - |
| Main Gallery | 100 | - | - | 13' | 100 | - | - | - | - | - | - |
| South Gallery | 58 | - | - | 13' | 58 | - | - | - | - | - | - |
| Level 7 Gallery | 158 | - | 13,958' | 13' | 158 | - | - | - | - | - | - |

convene