

Convene One Liberty Plaza

1 Liberty Street, New York, NY 10006

MEETINGS & EVENTS



Convene One Liberty Plaza is a premium meeting and event venue in Lower Manhattan. Spanning more than 30,000 square-feet, this location offers four flexible meeting rooms, the largest of which can accommodate over 350 guests, and is ideal for company town halls, single-room conferences, trainings, product launches, corporate offsites, and networking receptions.

Convene One Liberty Plaza provides a white box space allowing for extensive client and event branding opportunities, in-house catering with customization options and dining private to each event, in-room A/V technology supported by an on-site team, and dedicated hospitality resources.

This venue is in close proximity to the World Trade Center and is easily accessible via public transportation.

4
MEETING ROOMS

660
FULL BUYOUT CAPACITY

30,000
SQUARE FEET



HIGH SPEED
WIFI



STATE OF THE ART
TECHNOLOGY



FLEXIBLE MEETING
& EVENT SPACE



EVENT PLANNING
SERVICES



ON-SITE
GOURMET CHEF



UNLIMITED ON-SITE
DRINKS & SNACKS



This collateral is based on the latest information reasonably available and may be updated on a periodic basis. Please check with your Convene Account Manager for the latest information.

convene

CONVENE.COM | 888-730-7307

Floorplan & capacities

2ND FLOOR

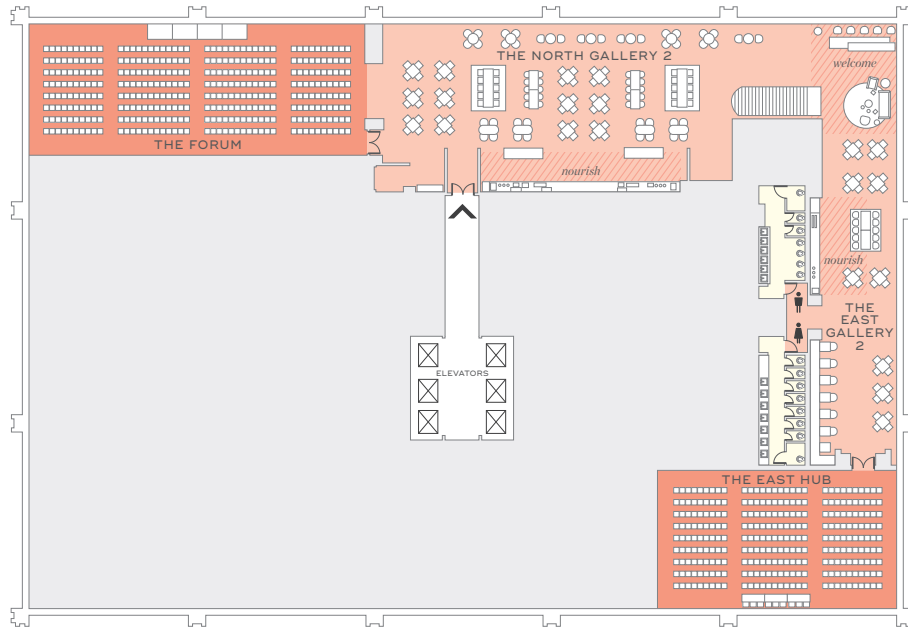
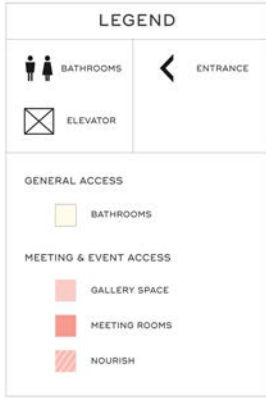

2ND FLOOR MEZZANINE

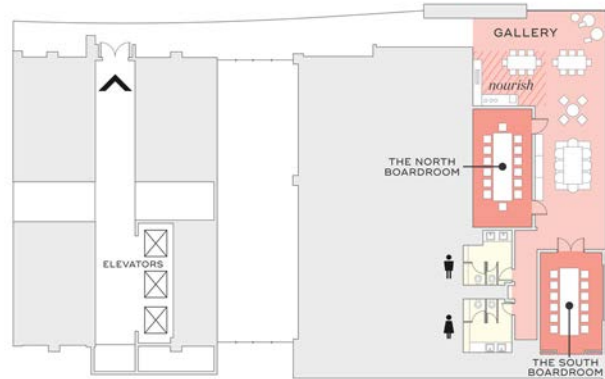

2ND FLOOR & MEZZANINE	DIMENSION [FT]	AREA [SQ FT]	CEILING HT [FT]	RECEPTION (MAX CAPACITY)	THEATER	CLASSROOM	ROUNDS [8-TOP]	U-SHAPE	CONFERENCE	PODS [6-TOP]
The Forum	36' x 90'	3,423'	17'	356	287	144	192	57	-	144
The Forum with Stage	36' x 90'	3,423'	17'	356	246	132	128	57	-	108
The North Gallery	41' x 117'	4,919'	21'	400	-	-	-	-	-	-
The East Hub	37' x 63'	2,576'	21'	252	184	120	120	51	-	102
The East Gallery	19' x 88'	2,846'	8'	150	-	-	-	-	-	-
The North Boardroom	14' x 27'	388'	8'	14	-	-	-	-	14	-
The South Boardroom	14' x 22'	335'	8'	14	-	-	-	-	14	-
The Mezzanine Gallery	16' x 54'	1,088'	8'	35	-	-	-	-	-	-

TPA may be required for some meeting room layouts