

County Hall



Our County Hall venue is as stunning on the inside as it is on the outside with over 68,000 sq ft of multi use event space over two floors. Situated on London's Southbank, it offers breathtaking views of The Houses of Parliament and Big Ben.

The County Suite can accommodate larger groups and is supported by a range of smaller conference suites and meeting rooms as well as exclusive use opportunities and private dining options. Our design team has intentionally restored this charming building keeping some of its original features coupled with high-quality design in classic copper and velvet tones. County Hall is conveniently located just minutes away from Waterloo and Westminster stations.

30
MEETING SPACES

400
MAX ROOM CAPACITY

6,317
SQUARE METERS



FLEXIBLE MEETING & EVENT SPACE



INNOVATIVE TECHNOLOGY



EVENT PLANNING & MANAGEMENT



FULLY STAFFED & SERVICED



ON-SITE GOURMET CATERING



PREMIUM DESIGN



Floorplan & Capacities

3 RD FLOOR

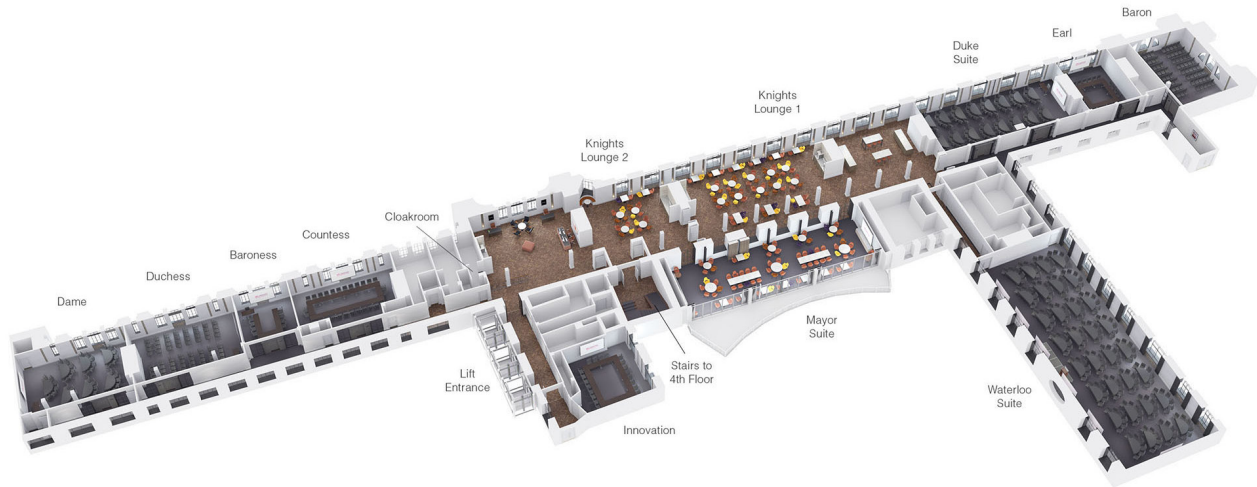

	AREA [m ²]	AREA [ft ²]	THEATER	CRESCENT CABARET	CLASSROOM	BANQUET	BOARDROOM	U-SHAPE	EXHIBITION [STANDS]
Knights Lounge	220 m ²	2368 ft ²	-	-	-	-	-	-	12
Baron	79 m ²	850 ft ²	80	48	40	60	32	28	-
Earl	51 m ²	548 ft ²	50	24	18	40	20	18	-
Duke Suite	139 m ²	1496 ft ²	160	96	72	100	52	48	8
Duke 1	57 m ²	613 ft ²	50	24	24	40	20	16	4
Duke 2	82 m ²	882 ft ²	70	48	36	60	32	24	5
Waterloo Suite	288 m ²	3100 ft ²	328	192	136	240	-	-	27
Mayor Suite	144 m ²	1550 ft ²	152	108	84	120	60	56	12
Mayor 1	91 m ²	979 ft ²	96	72	56	80	40	36	-
Mayor 2	53 m ²	570 ft ²	48	30	24	40	20	16	-
Countess	70 m ²	753 ft ²	56	36	24	50	28	20	-
Baroness	34 m ²	365 ft ²	32	18	12	20	12	12	-
Duchess	76 m ²	818 ft ²	64	36	30	50	28	24	-
Dame	76 m ²	818 ft ²	64	32	30	50	28	26	-
Innovation	56 m ²	602 ft ²	60	24	24	40	24	20	-

Floorplan & Capacities

4TH FLOOR

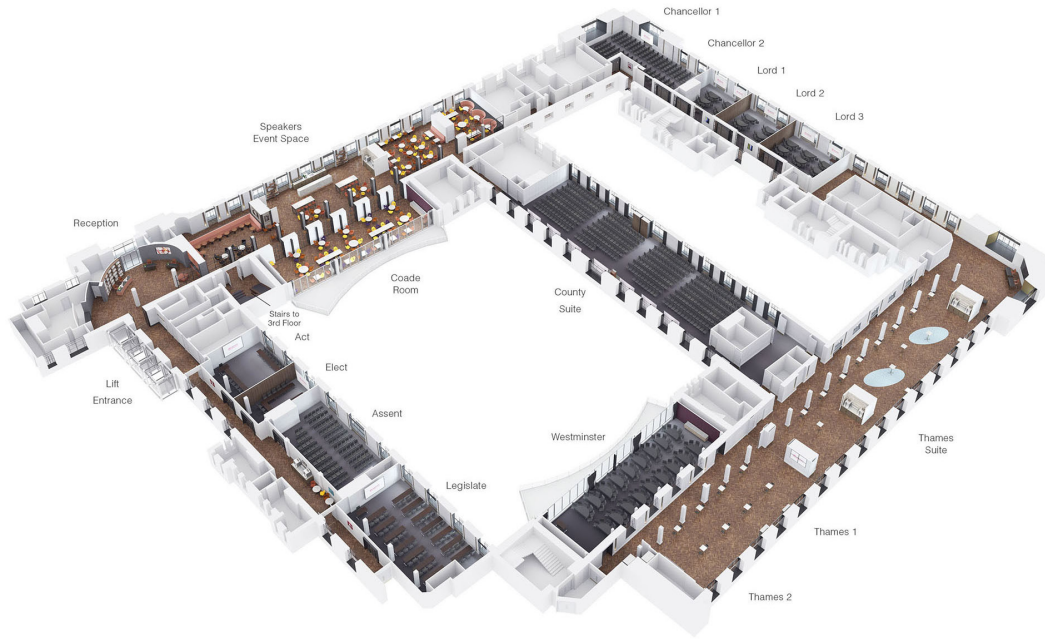

	AREA [m ²]	AREA [ft ²]	THEATER	CRESCENT CABARET	CLASSROOM	BANQUET	BOARDROOM	U-SHAPE	EXHIBITION [STANDS]
Chancellor Suite	151 m ²	1625 ft ²	150	96	72	100	56	50	-
Chancellor 1	93 m ²	1001 ft ²	100	60	42	60	32	24	-
Chancellor 2	58 m ²	624 ft ²	50	36	24	40	24	20	-
Lord Suite	193 m ²	2077 ft ²	200	123	84	120	72	44	-
Lord 1 & 2	119 m ²	1280 ft ²	120	72	60	80	44	30	-
Lord 2 & 3	137 m ²	1474 ft ²	150	90	72	100	56	36	-
Lord 1	56 m ²	602 ft ²	40	36	24	30	20	18	-
Lord 2	63 m ²	678 ft ²	60	36	24	40	24	20	-
Lord 3	74 m ²	796 ft ²	70	54	36	60	28	22	-
Thames Suite (Includes Thames Lounge and Thames 1 & 2)	678 m ²	7297 ft ²	-	-	-	280	-	-	54
Thames Lounge	444 m ²	4779 ft ²	-	-	-	160	-	-	33
Thames 1 & 2	167 m ²	1797 ft ²	200	108	88	120	64	56	-

Floorplan & Capacities

4TH FLOOR

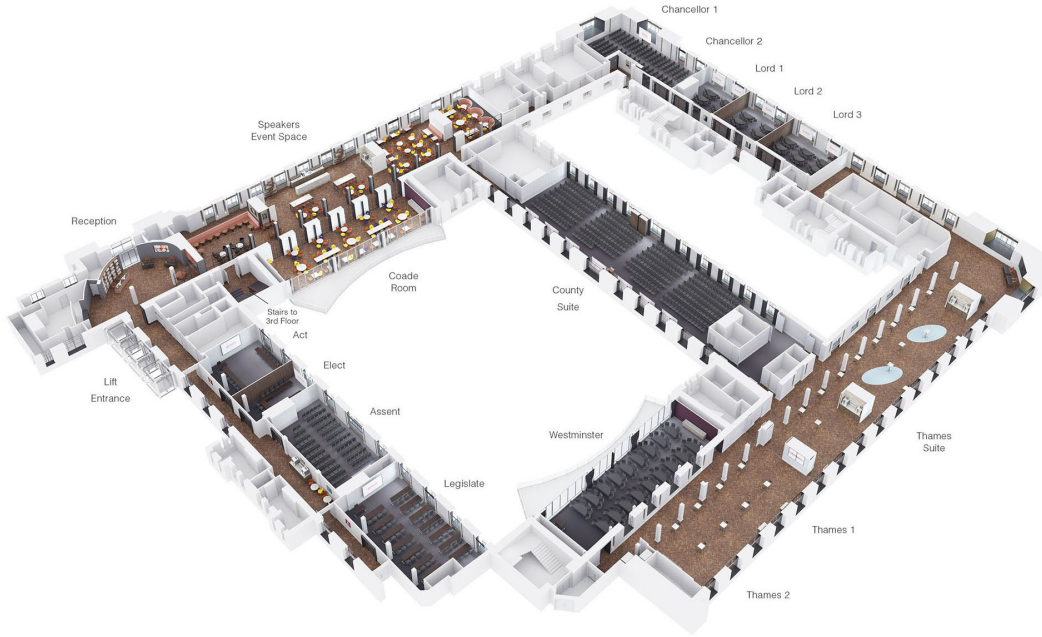

	AREA [m ²]	AREA [ft ²]	THEATER	CRESCENT CABARET	CLASSROOM	BANQUET	BOARDROOM	U-SHAPE	EXHIBITION [STANDS]
Thames 1	83 m ²	893 ft ²	84	48	40	60	32	28	-
Thames 2	84 m ²	904 ft ²	84	48	40	60	32	28	-
Westminster	143 m ²	1539 ft ²	150	108	88	120	60	56	-
County Suite	384 m ²	4133 ft ²	400	252	180	260	-	-	36
County 1	227 m ²	2443 ft ²	224	140	96	150	-	-	20
County 2	157 m ²	1689 ft ²	160	96	72	120	-	-	13
The Coade Room	143 m ²	1539 ft ²	-	-	-	120	-	-	8
Act & Elect	96 m ²	1033 ft ²	100	60	40	60	40	34	-
Act	61 m ²	656 ft ²	60	30	24	40	28	22	-
Elect	35 m ²	376 ft ²	30	12	12	16	16	16	-
Assent	92 m ²	990 ft ²	100	48	44	70	40	36	-
Legislate	115 m ²	1237 ft ²	110	48	56	80	44	38	-