

# Convene 100 Stockton

MEETINGS & EVENTS

40 O'Farrell Street, San Francisco, CA 94108



Convene 100 Stockton is located in the heart of San Francisco's Union Square neighborhood. The venue features seven unique meeting spaces across 53,000 square-feet and can accommodate events up to just under 470; it is ideal for large conferences, company town halls, product launches, annual kick-offs, and corporate receptions.

The location celebrates the city's illustrious weather phenomenon "Karl, the Fog" with an ethereal statement light fixture as well as reflective art and decor. The design is reminiscent of the surrounding landmarked architecture and coastal contemporary elements, including dramatic natural light, stonework, warm woods, and lush greenery. Convene 100 Stockton provides a white box space allowing for client and event branding opportunities, in-house catering with customization options and dining private to each event, in-room A/V technology supported by an on-site team, and dedicated hospitality resources.

The location is conveniently adjacent to several paid parking garages and is easily accessible via public transportation.

7  
MEETING ROOMS

---

1,116  
FULL BUYOUT CAPACITY

---

53,000  
SQUARE FEET



HIGH SPEED  
WIFI



STATE OF THE ART  
TECHNOLOGY



FLEXIBLE MEETING  
& EVENT SPACE



EVENT PLANNING  
SERVICES



ON-SITE  
GOURMET CHEF



UNLIMITED ON-SITE  
DRINKS & SNACKS



This collateral is based on the latest information reasonably available and may be updated on a periodic basis. Please check with your Convene Account Manager for the latest information.

convene

CONVENE.COM | 888-730-7307

# Convene 100 Stockton

MEETINGS & EVENTS

40 O'Farrell Street, San Francisco, CA 94108

## Floorplan & capacities

### 4TH FLOOR

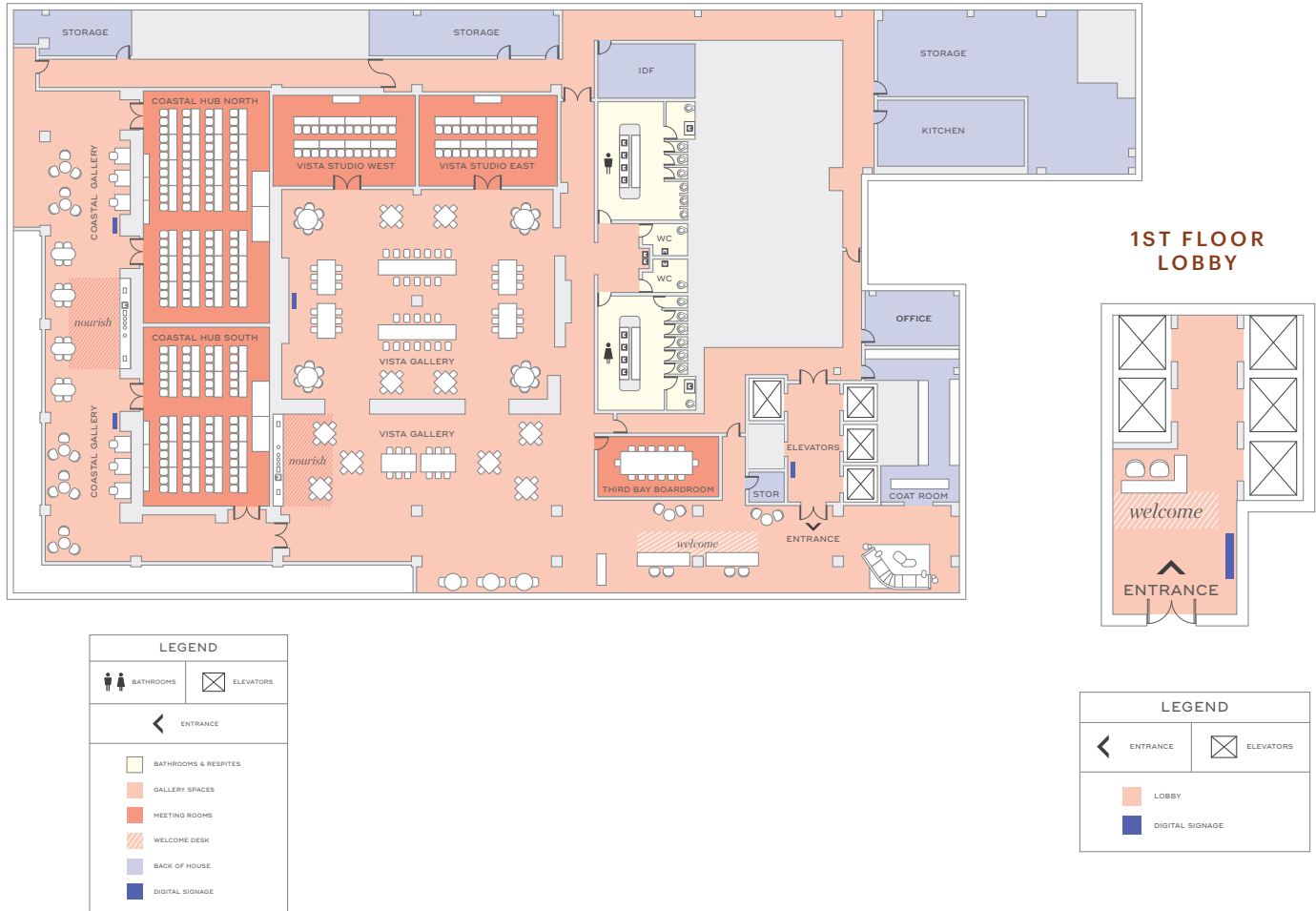

	AREA [SQ FT]	MAX CAPACITY	THEATER	CLASSROOM	BANQUET	PODS [6-TOP]	U-SHAPE	HOLLOW SQUARE	CONFERENCE
<b>Coastal Gallery</b>	2,106	160	-	-	-	-	-	-	-
<b>Vista Gallery</b>	5,206	348	-	-	-	-	-	-	-
<b>Coastal Hub South</b>	1,180	100	100	45	72	48	27	42	-
<b>Coastal Hub North</b>	1,481	150	150	84	96	60	33	54	-
<b>Vista Studio West</b>	670	64	64	36	18	18	15	30	-
<b>Vista Studio East</b>	662	64	64	36	18	18	15	30	-
<b>Third Bay Boardroom</b>	386	26	-	-	-	-	-	-	14

TPA may be required for some meeting room layouts

This collateral is based on the latest information reasonably available and may be updated on a periodic basis. Please check with your Convene Account Manager for the latest information.

convene

CONVENE.COM | 888-730-7307

# Convene 100 Stockton

MEETINGS & EVENTS

40 O'Farrell Street, San Francisco, CA 94108

## Floorplan & capacities

### 5TH FLOOR

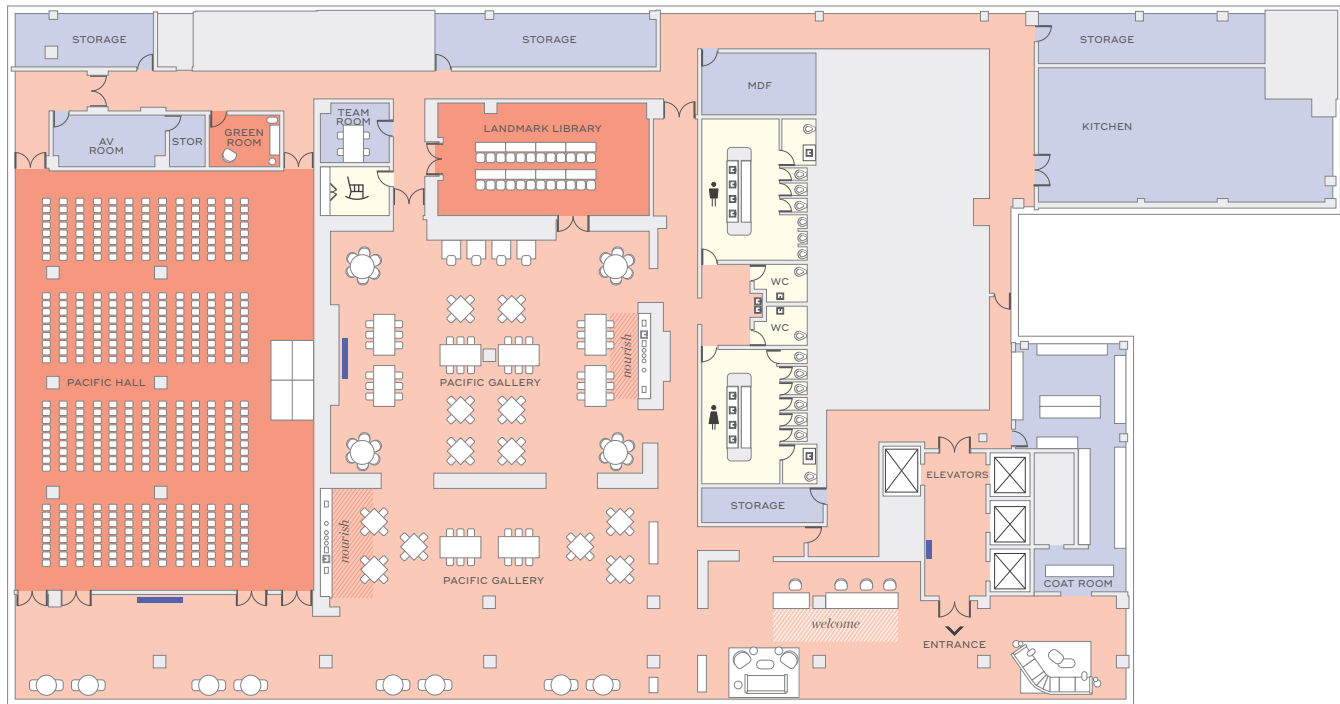

	AREA [SQ FT]	MAX CAPACITY	THEATER	CLASSROOM	ROUNDS	PODS [6-TOP]	U-SHAPE	HOLLOW SQUARE
<b>Pacific Hall</b>	4,742	468	468	270	288	260	-	-
<b>Pacific Hall with Stage</b>	4,742	432	432	240	224	212	-	-
<b>Pacific Gallery</b>	5,732	396	-	-	-	-	-	-
<b>Landmark Library</b>	914	80	80	24	-	24	24	-

TPA may be required for some meeting room layouts

This collateral is based on the latest information reasonably available and may be updated on a periodic basis. Please check with your Convene Account Manager for the latest information.

convene

CONVENE.COM | 888-730-7307