



magazzino italian art pavilion by alberto campo baeza and miguel quismondo completes

[architecture](#)

[192 shares](#)

[connections: +2030](#)

MAGAZZINO MUSEUM EXTENSION – ROBERT OLNICK PAVILION

The Magazzino Italian Art Museum's extension in Cold Springs, NY, is now complete. Designed by architects **Alberto Campo Baeza** and **Miguel Quismondo**, the expansion is titled Robert Olnick Pavilion and takes shape as a rectangular two-story building with square openings strategically carved into its cubic **concrete** structure. These openings allow natural light to flood the interior throughout the day, creating a captivating spatial ambiance that enhances the exhibition space.



the exterior of the Robert Olnick Pavilion | image by Marco Anelli (head image by William Mulvihill)



Discover the collections >

FLORIM



ALBERTO CAMPO BAEZA AND MIGUEL QUISMONDO DESIGN ISOTROPIC SPACE FOR EXHIBITIONS

The new pavilion at Magazzino Museum (find more [here](#)) houses the Murano glass collection, the cafeteria, and more exhibition spaces. Alberto Campo Baeza (find more [here](#)) and Miguel Quismondo (find more [here](#)) put special emphasis on the main exhibit area, which is a white, cubic, isotropic space that accommodates temporary exhibitions and serves as a focal point of the museum. *'Isotropic space, as defined by the dictionary of the Royal Academy, has the same characteristics in all directions and from any point. If we could fly from the center, the space would be identical in all directions,'* the architects explain.

Within this cubic, white, and isotropic space, strategically designed openings are meticulously placed to invite sunlight throughout the day. These openings not only enhance the spatial experience but also serve as doorways when positioned on walls in contact with the floor. *'Following simple logic, we eliminated the opening corresponding to the floor plane. In addition, we created a particularly interesting feature by drilling a 2.10 x 2.10 deep hole in the center of the wall, so that the entire spatial operation can be understood at a glance,'* Alberto Campo Baeza and Miguel Quismondo share.



Discover the collections >

FORIM

publish my work

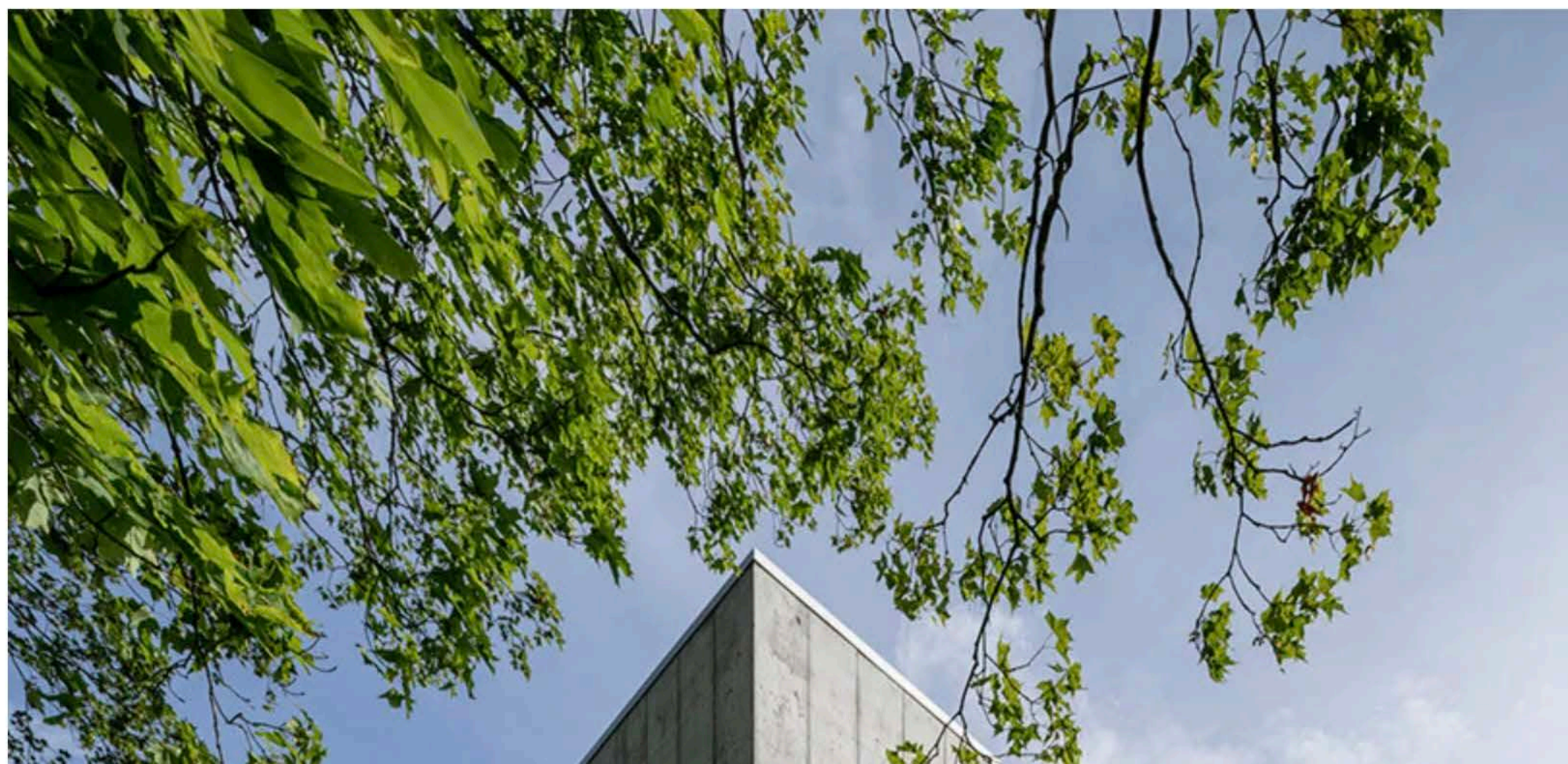



the pavilion takes shape as a rectangular two-story building with square openings | image by Javier Callejas

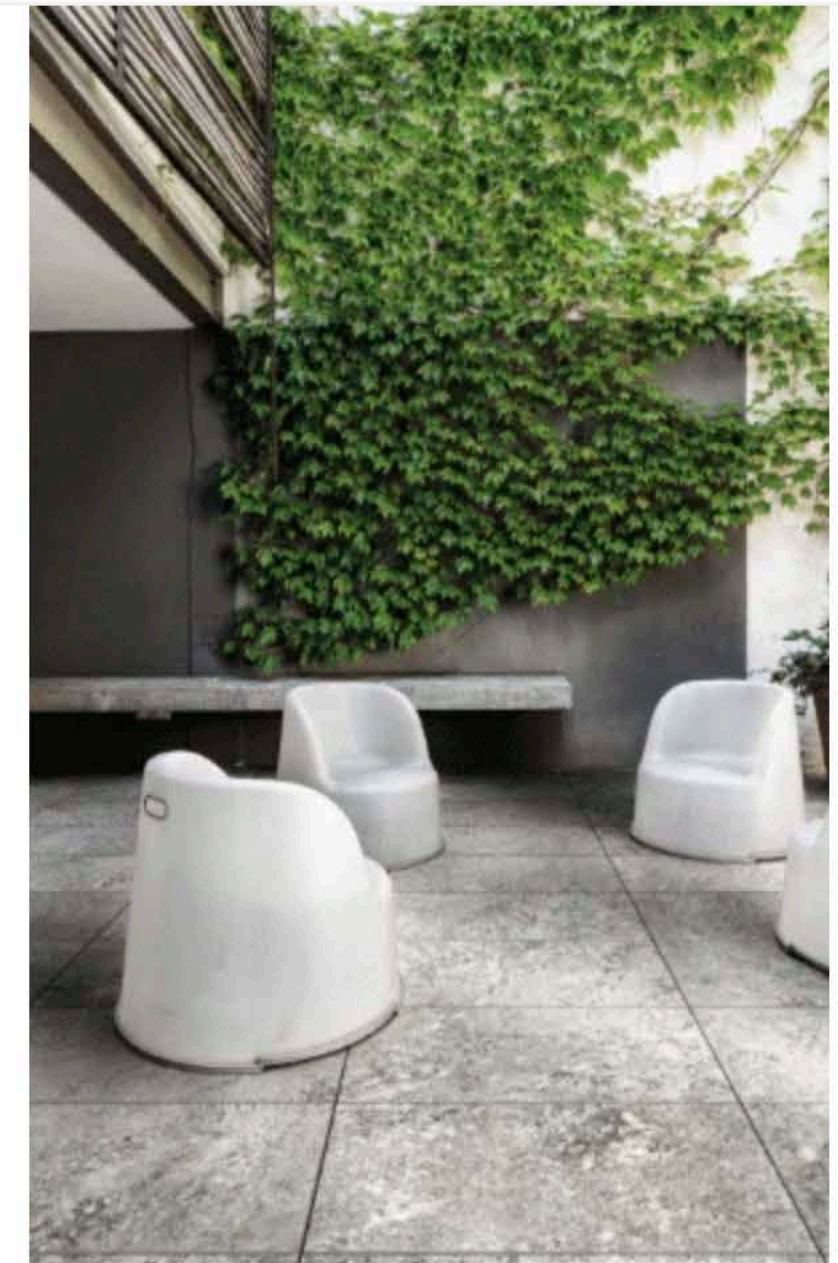

Discover the collections >

FLORIM

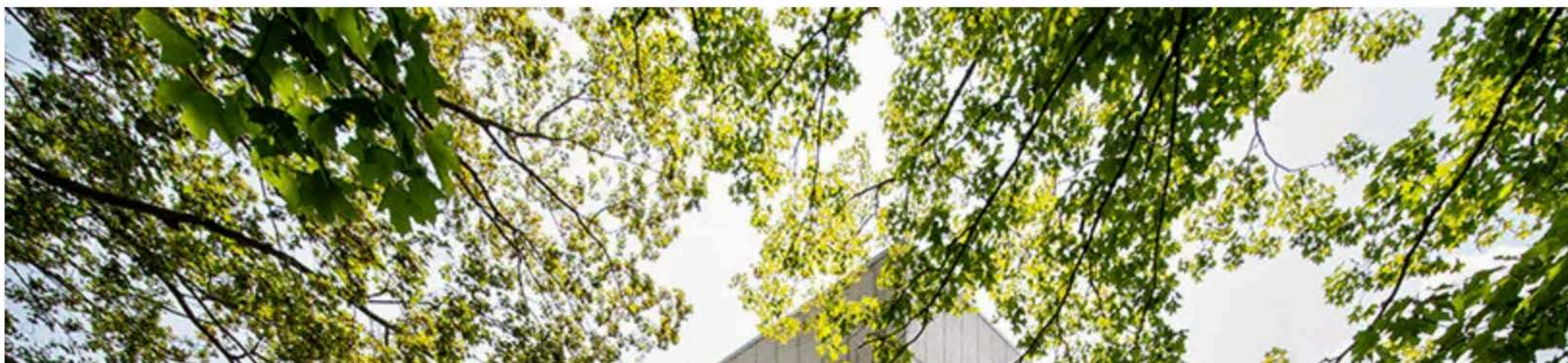



the concrete building against its lush green surroundings | image by William Mulvihill

Outdoor
porcelain
slabs



F^{OR}ORIM

share my vision





inner courtyards of the new pavilion | image by William Mulvihill

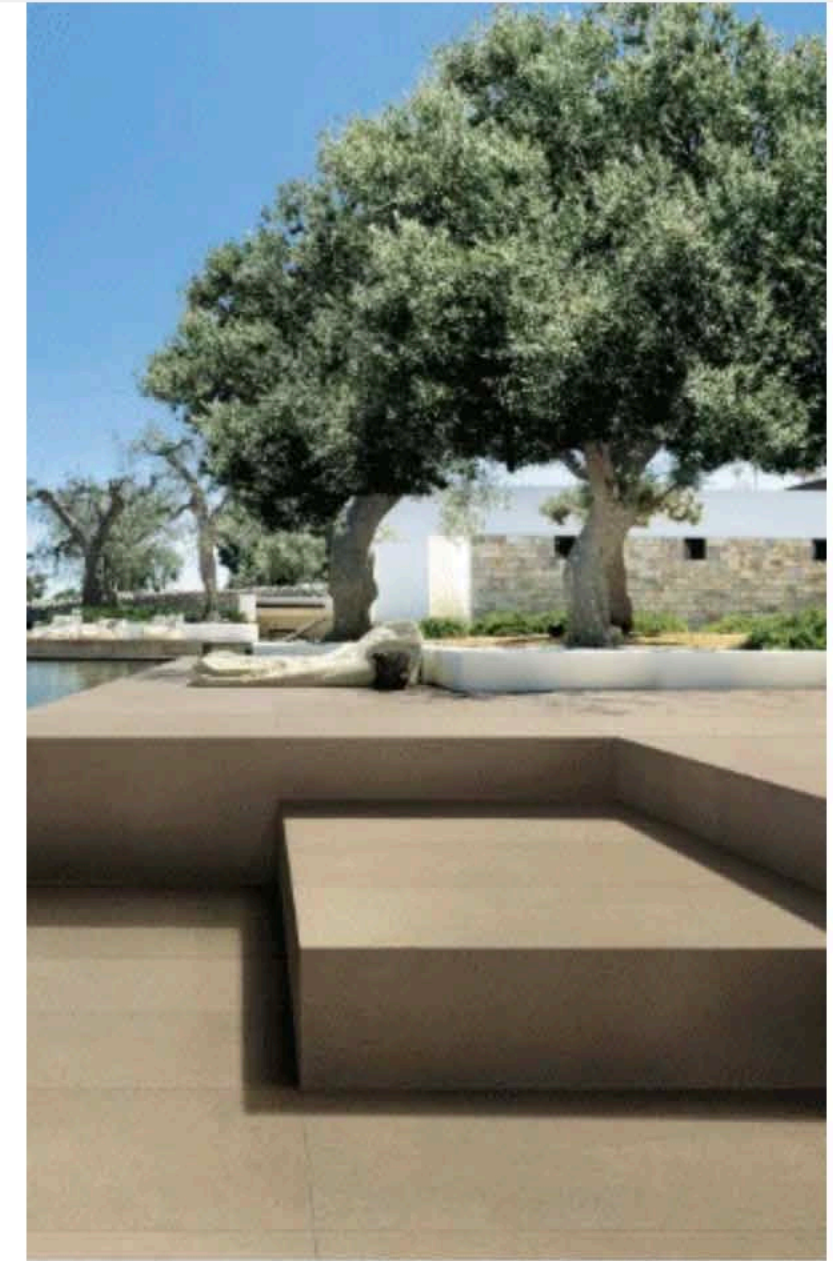
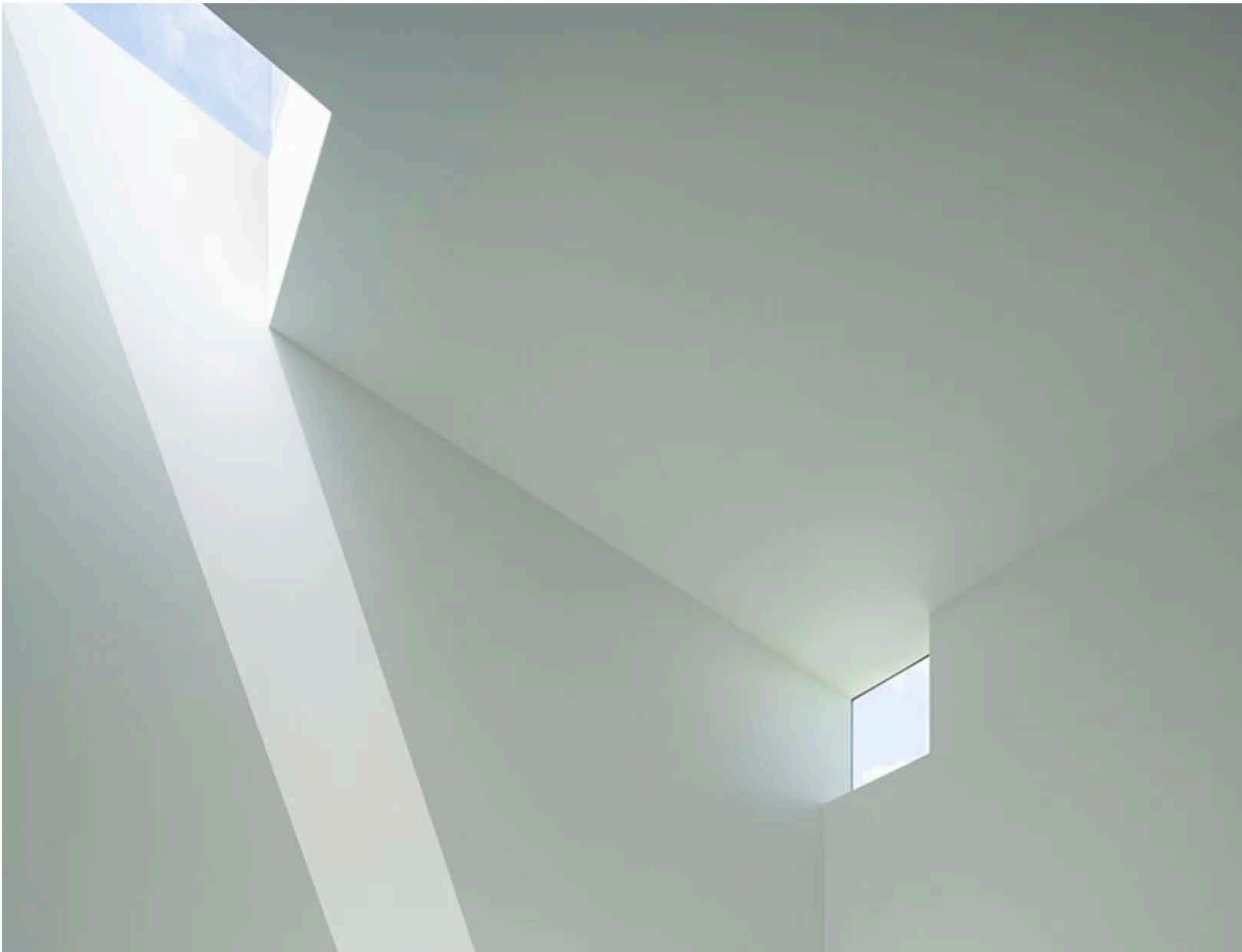

Discover the collections >

FORIM

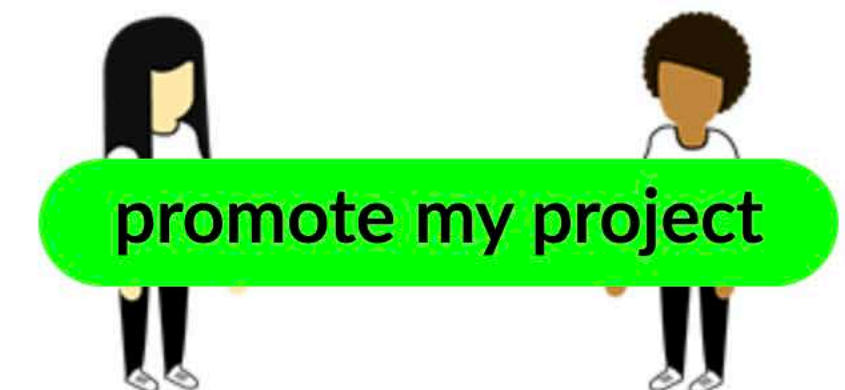

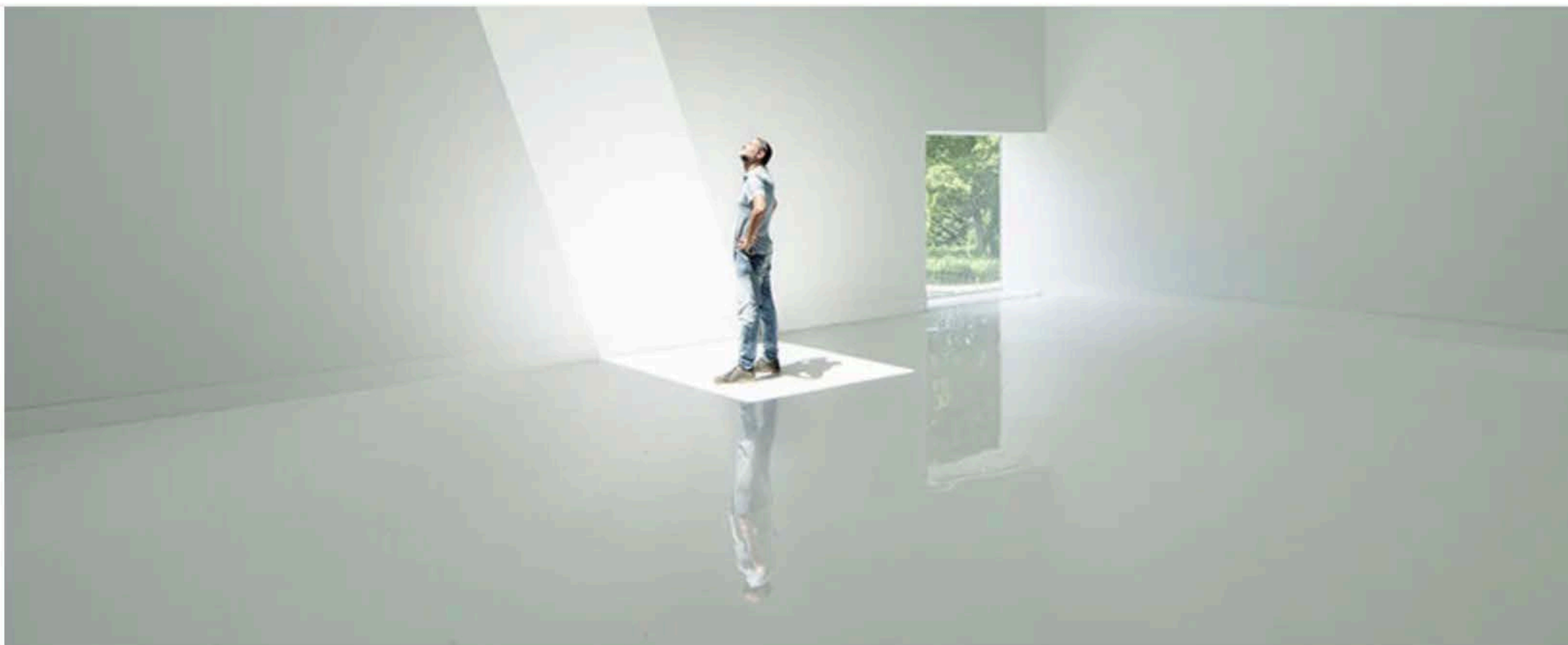

strategically designed openings are meticulously placed to invite sunlight throughout the day | image by Javier Callejas



Discover the collections >

FLORIM



publish my work

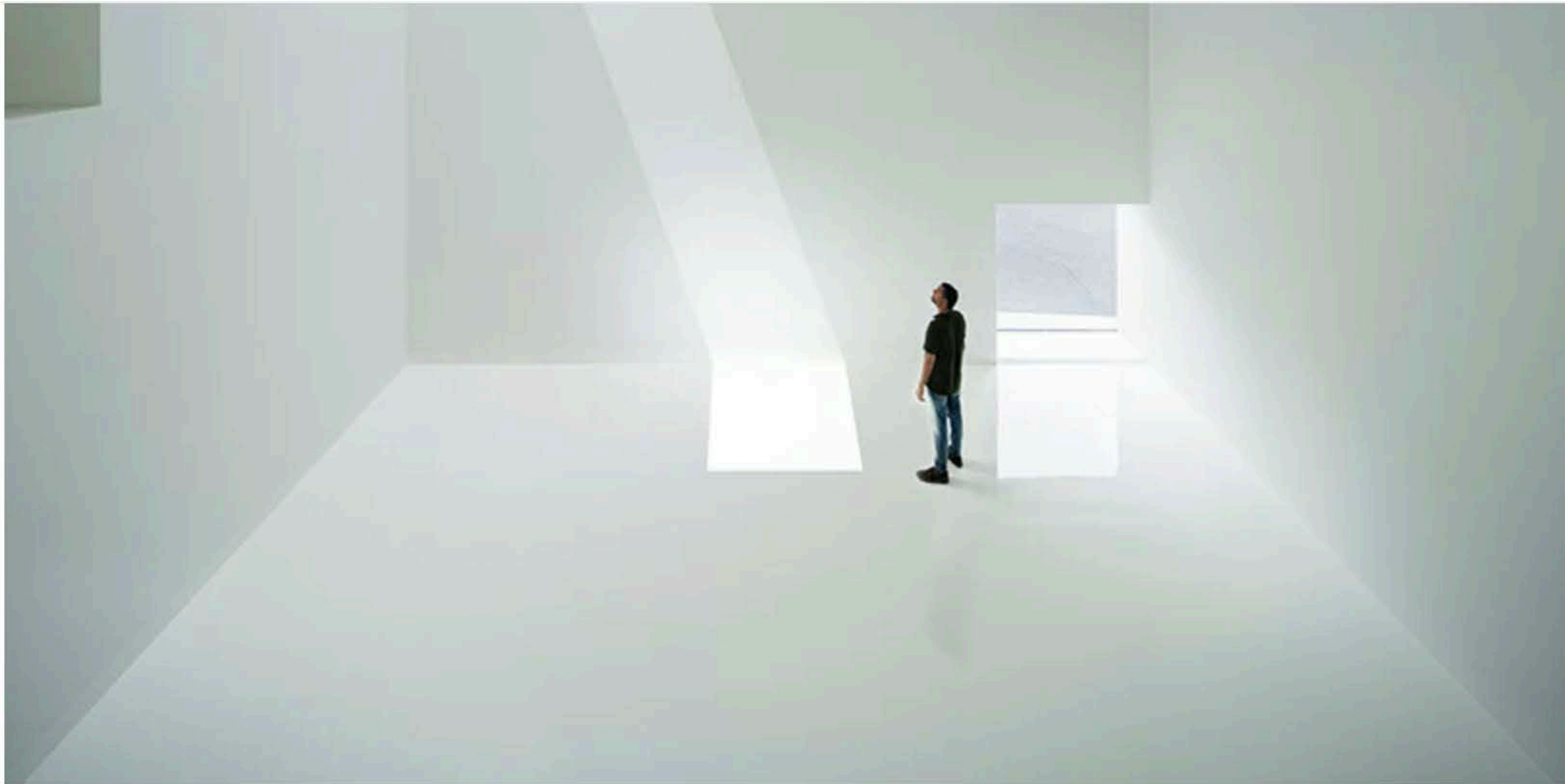

the openings and the resulting lighting effects enhance the spatial experience | image by Javier Callejas

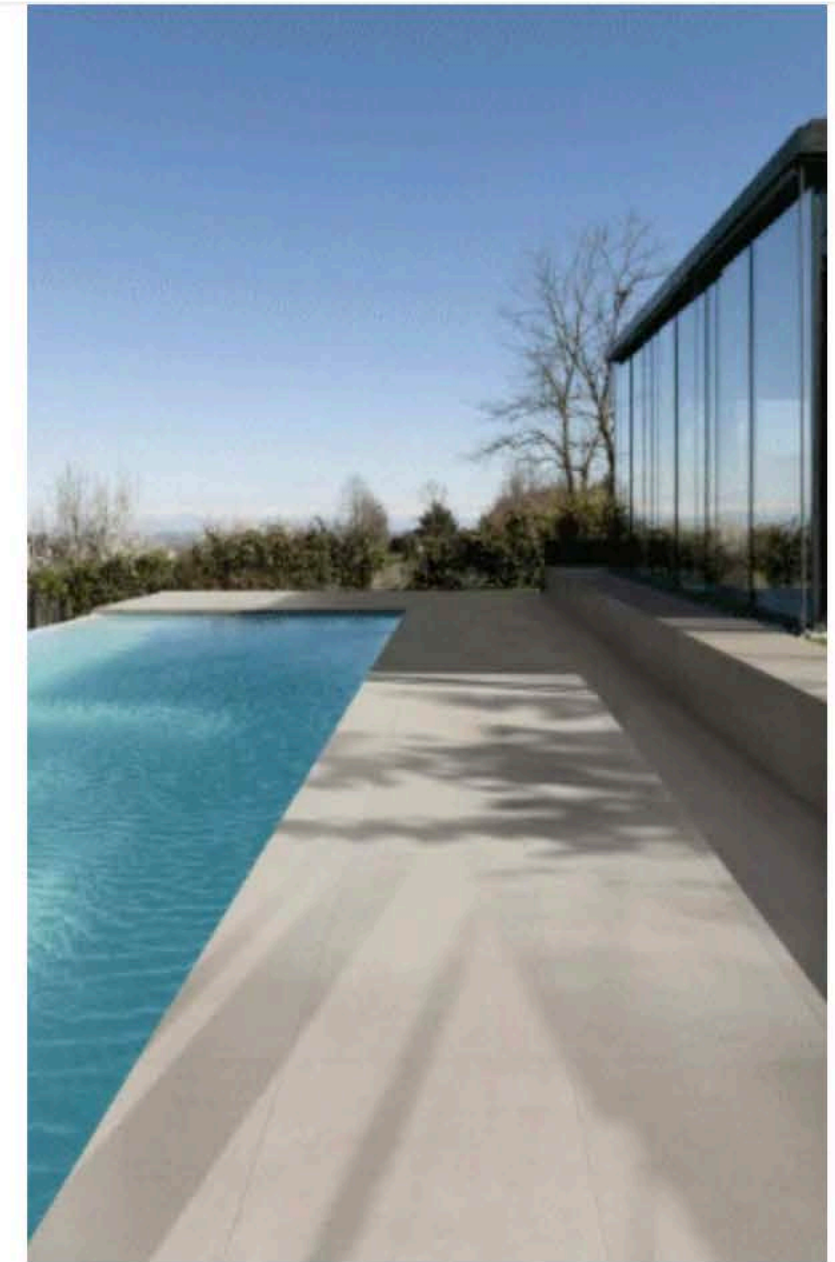

Discover the collections >

FORIM

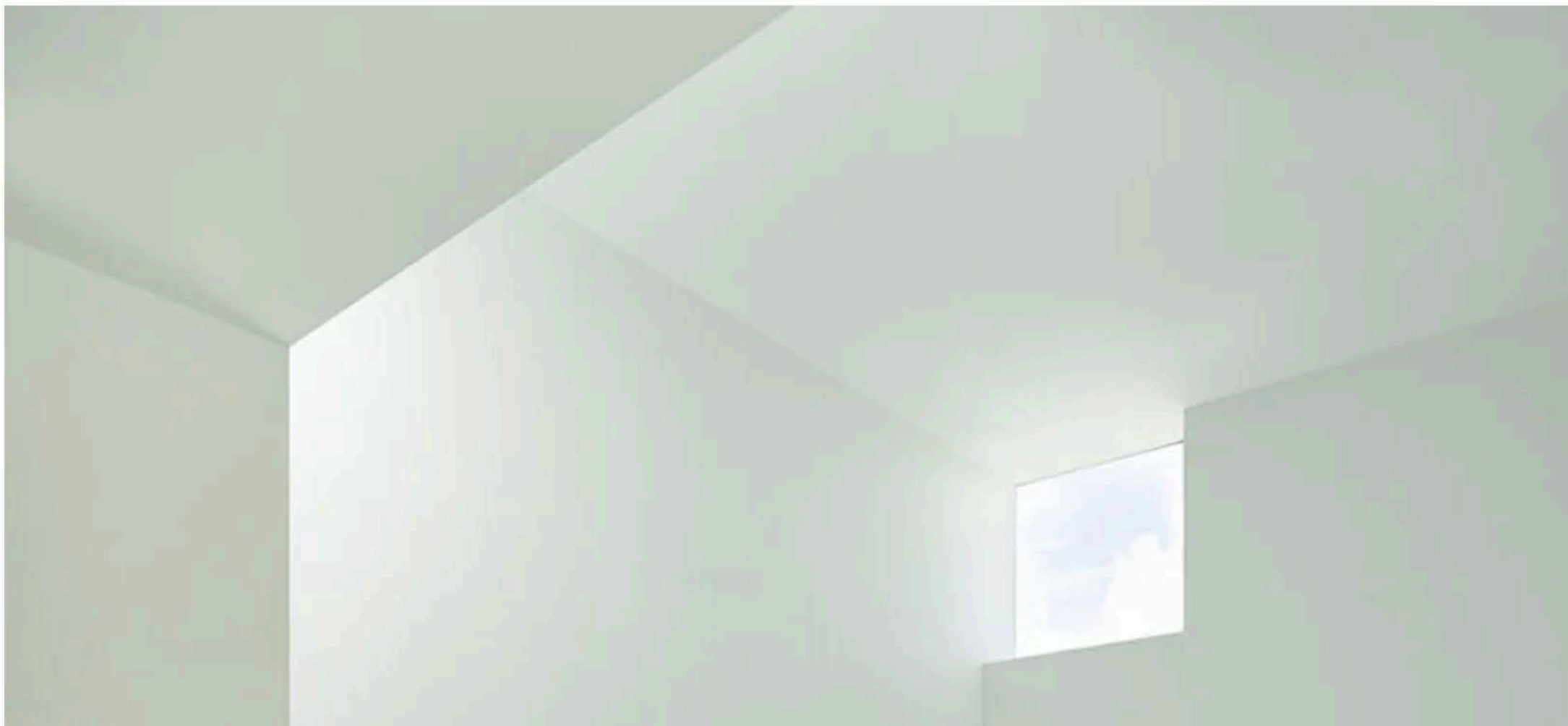

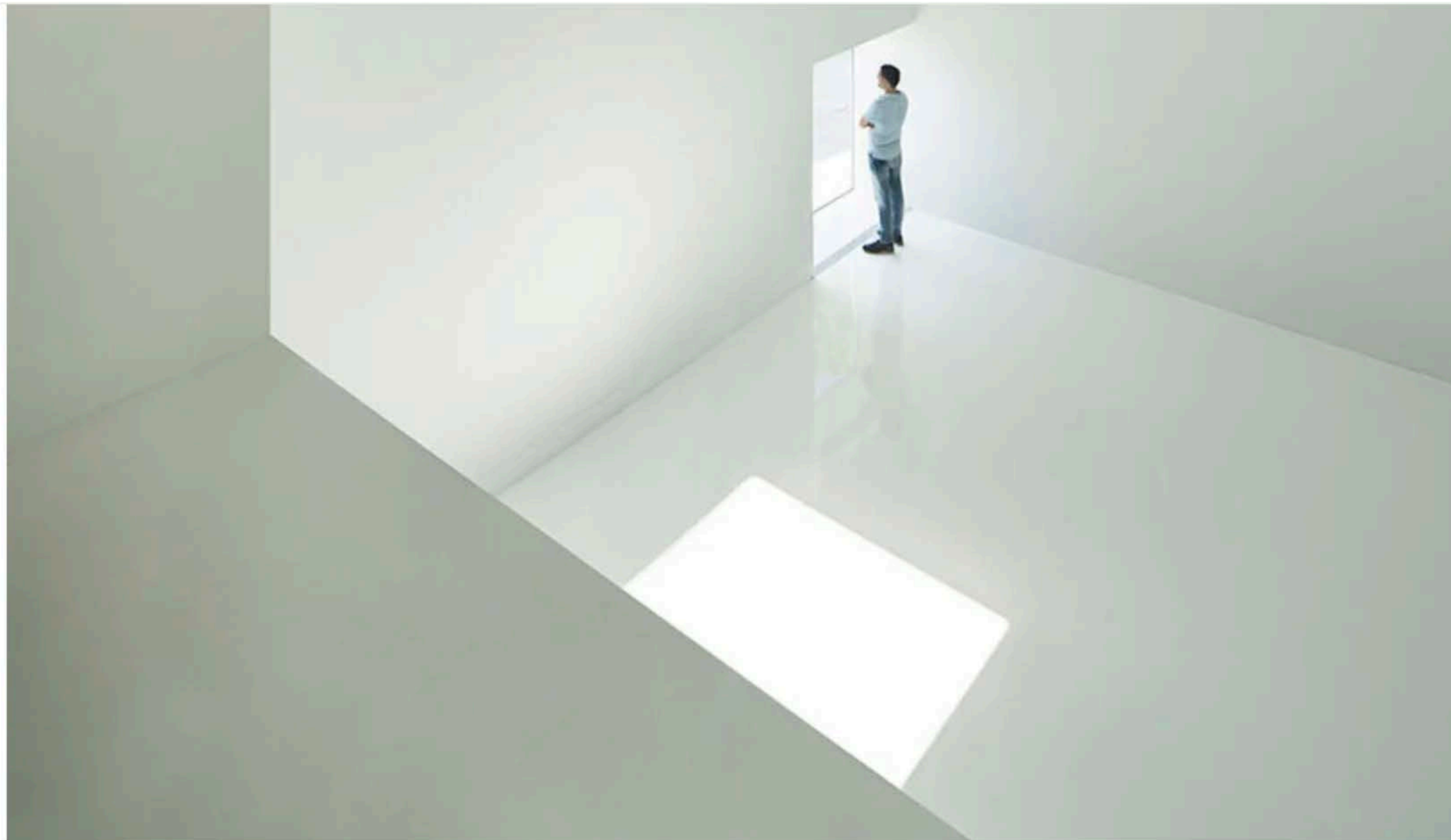

the openings also serve as doorways when positioned on walls in contact with the floor | image by Javier Callejas

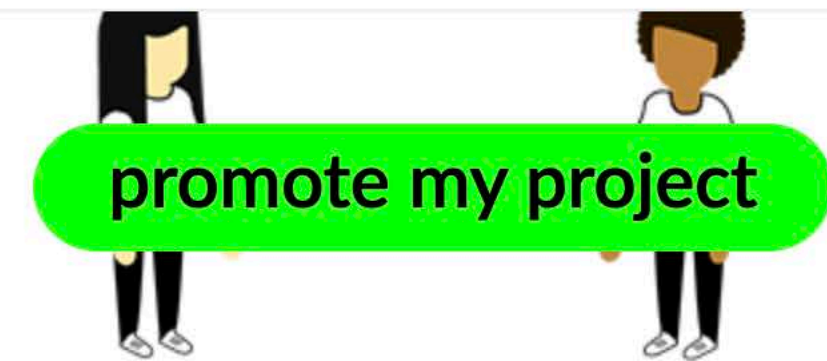
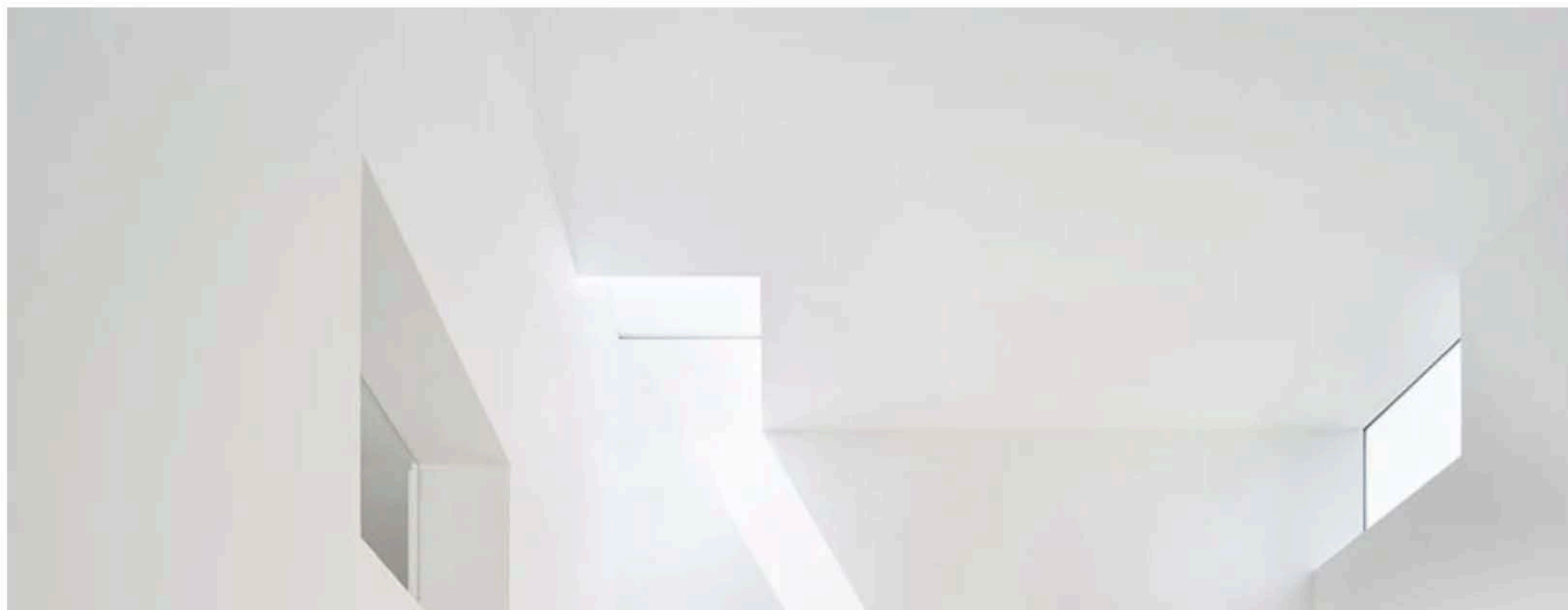

keep up with our daily and weekly stories



✓ daily - see sample

✓ weekly - see sample

enter your email for newsletter

subscribe

POPULAR NOW ARCH!

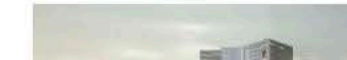

dhaka tower breaks



the interior of the pavilion is described as a cubic, white, and isotropic space | image by William Mulvihill

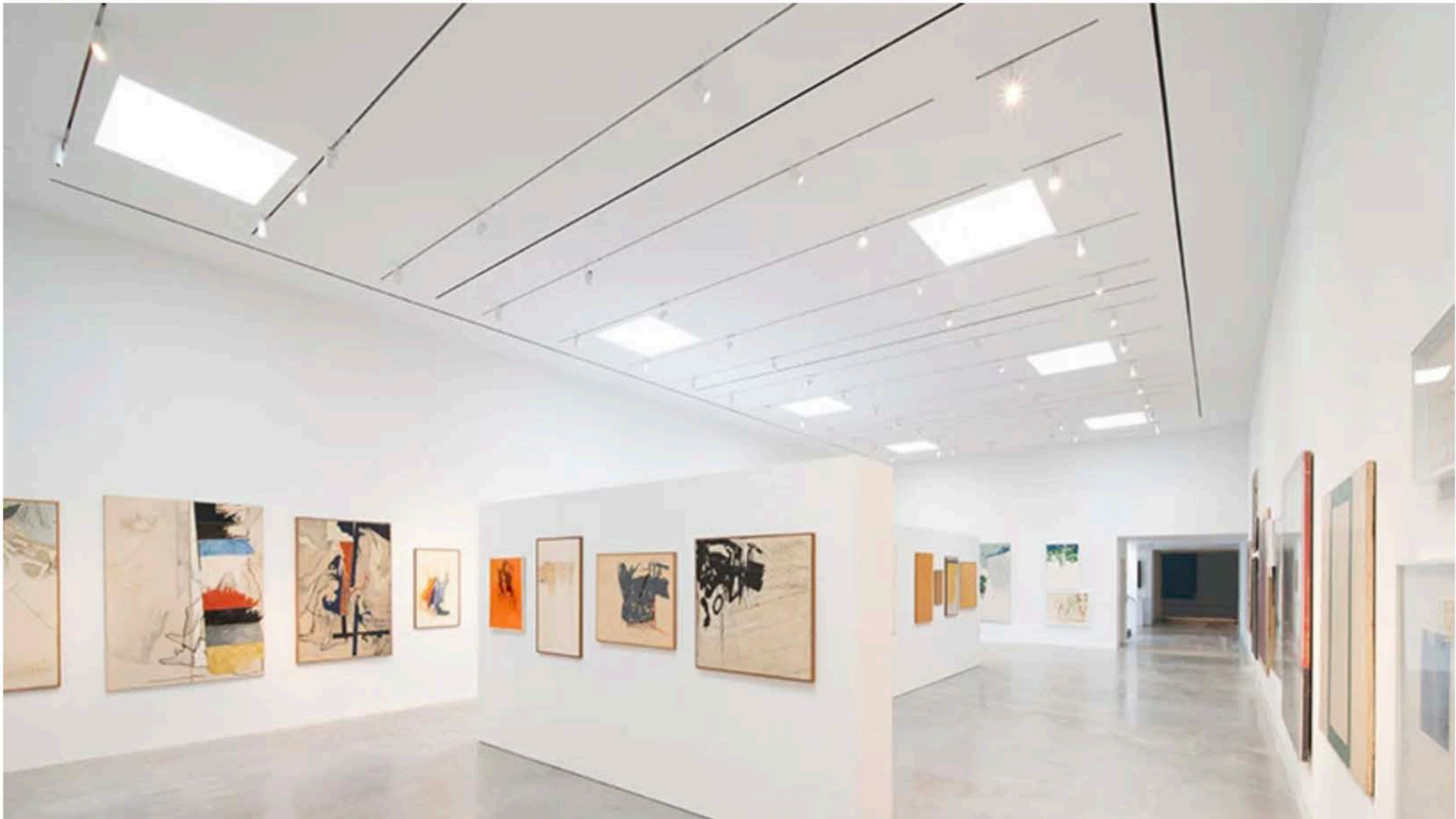

bangladesh
54k views



spotted gum-clad
'treehouse' by suzanne
hunt floats among
australian woods
14k views

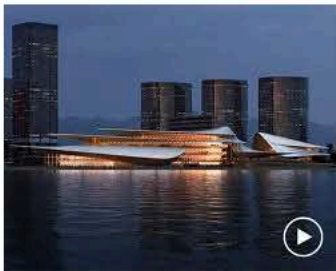

zaha hadid architects
plans sanya cultural
district with cascading
rooftops
17k views

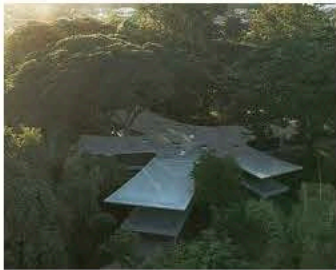

all(zone) joins five
curved wings to
compose 'under the
rain trees' house in
13k views

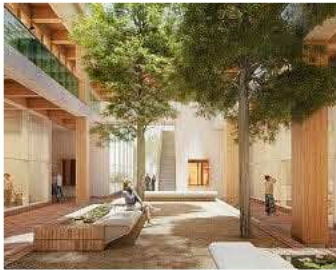

herzog & de meuron's
first project in texas
will bring mass-timber
to austin
14k views

PRODUCT LIBRARY





the new pavilion at Magazzino Museum houses the Murano glass collection, the cafeteria, and more exhibition spaces | image by William Mulvihill

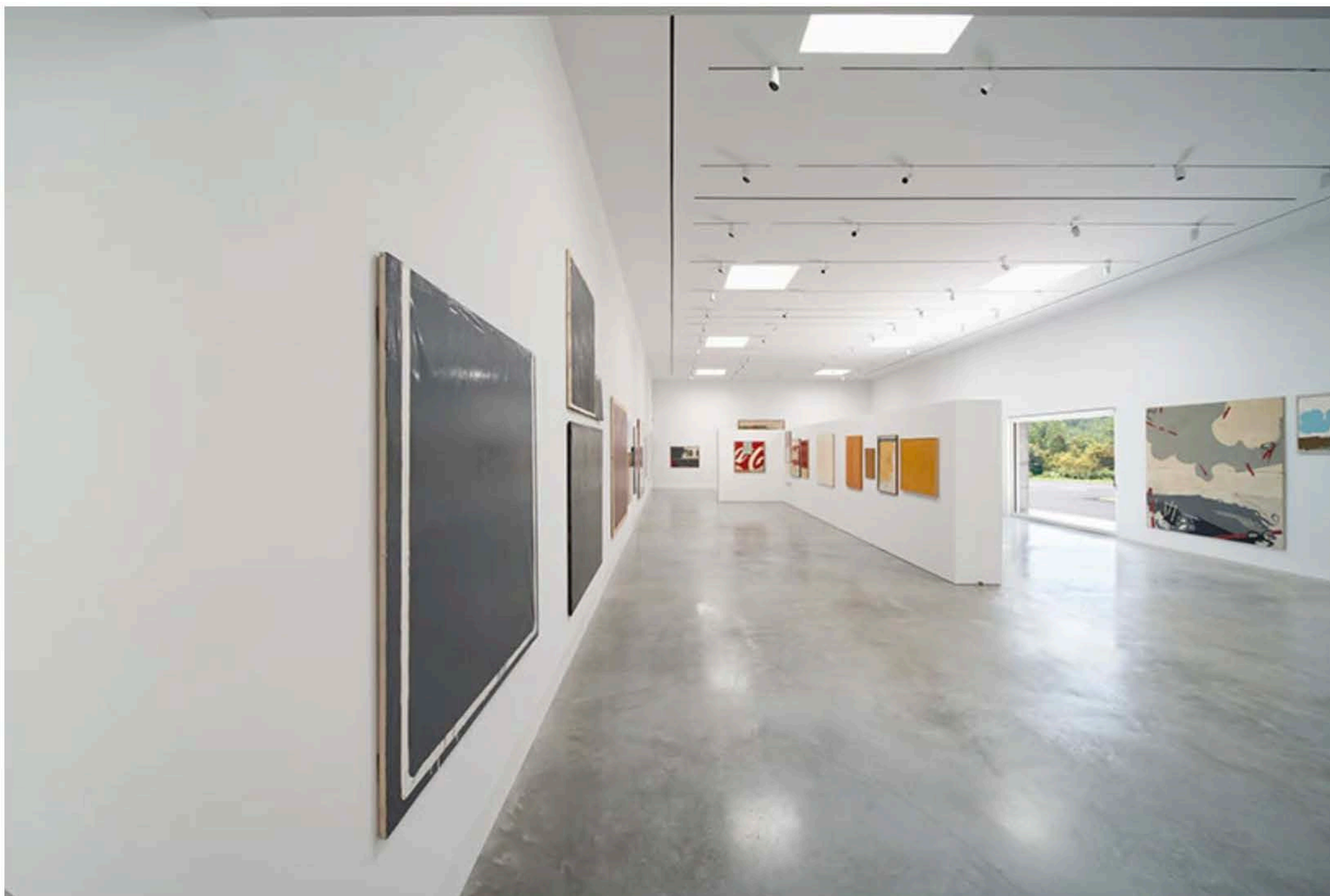

repeated rectangular shapes are featured throughout the pavilion design | image by William Mulvihill

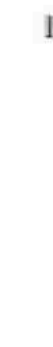

in alliance with **ARCHITONIC**

 **HOLCIM** |  **NFF** Norman Foster Foundation

**ESSENTIAL HOMES
RESEARCH PROJECT**

DISCOVER NOW



interior view of the new pavilion | image by William Mulvihill

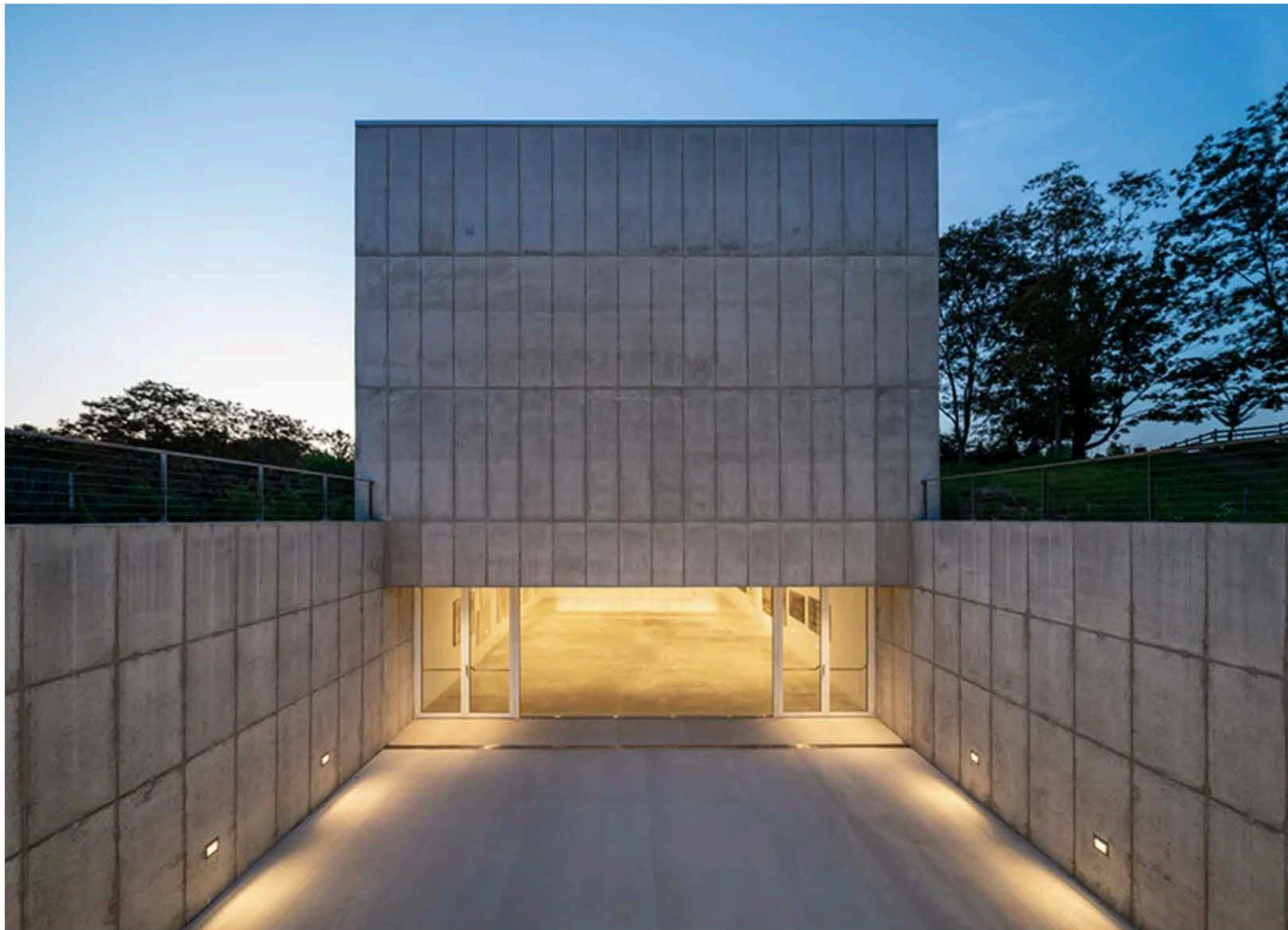

the exterior of the new pavilion in the evening | image by William Mulvihill



the exterior of the new pavilion in the evening | image by William Mulvihill

project info:

name: Robert Olnick Pavilion

architects: Alberto Campo Baeza & Miguel Quismondo

client: Magazzino Italian Art Foundation

location: Cold Springs, NY

built area: 1,208 sqm (13,000 sqft)

construction manager: Miguel Quismondo

project architect: Jacobo Mingorance

collaborator: Ignacio Aguirre López, Alejandro Cervilla García, Tommaso Campiotti, Juan Carlos Bragado, Ignacio

built area: 1,200 sqm (13,000 sqft)

construction manager: Miguel Quismondo

project architect: Jacobo Mingorance

collaborator: Ignacio Aguirre López, Alejandro Cervilla García, Tommaso Campiotti, Juan Carlos Bragado, Ignacio de Silóniz, Alfonso Guajardo-Fajardo Cruz, María Pérez de Camino Díez, David Vera García, Sara Fernández Trucios, Luca Redaelli, Gloria Saá García, William Mulvihill

structural engineer: Michael P. Carr, P.E., María Concepción Pérez Gutiérrez

MEP engineers: CES-Consulting Engineering Services Engineers

lighting consultant: MAP Design Studio Cost Consultant: Slocum Construction Consulting, Inc

photography: Javier Callejas, William Mulvihill, Marco Anelli

myrto katsikopoulou | designboom

oct 02, 2023

ALBERTO CAMPO BAEZA (11)



magazzino italian art to expand campus with building by alberto campo baeza and miguel quismondo



campo baeza expresses minimalistic tomb in venice with marble and concrete



a colosseum of books by alberto campo baeza illuminates the pleasure of reading