PRESTIGE Front Display/ Control Panel Replacement



Kit Part Number: PSCS01

Parts Kit:

- Display/Control Panel
- (4) 6-19 x 1/4" Phillips Screws

Recommended Tools:

- Phillips Screwdriver

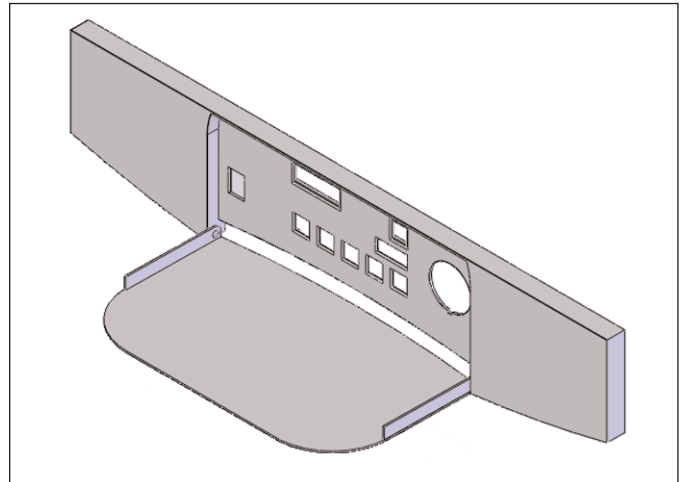

WARNING

Indicates a potentially hazardous situation which, if ignored, can result in serious injury or substantial property damage.

NOTICE

Indicates special instructions on installation, operation or maintenance, which are important to equipment but not related to personal injury hazards.

WARNING

For your safety, turn off electrical power supply at service panel and allow unit to cool before proceeding. Failure to do so can cause severe personal injury or death.

WARNING

Failure to follow instructions below can result in severe personal injury or damage if ignored.

- Instructions are for a qualified installer/ service technician.
- Read all instructions before proceeding.
- Follow instructions in proper order.

PRESTIGE Front Display/ Control Panel Replacement

Instructions

1. Disconnect the electrical power to the unit at the service panel.

WARNING

For your safety turn off electrical power supply at service panel before proceeding to avoid possible electrical shock hazard. Using the service switch provided on the boiler is not adequate in disconnecting power to unit. Failure to do so can cause severe personal injury or death.

2. Remove the front jacket panel.
3. Disconnect the pressure gauge fitting from the boiler piping mounting adapter.

NOTICE

The boiler piping mounting nut for the pressure gauge fitting contains an internal check valve. There should be no need in isolating the boiler or draining the boiler when removing the pressure gauge fitting.

4. Lift the Display / Control panel up to disengage the mounting screws from the bottom jacket panel.

NOTICE

The mounting screws for the Display / Control panel are accessible from the rear of the bottom jacket panel and may require to be loosened for removal of the panel.

5. Disengage the ON-OFF switch from the Display / Control panel by depressing the upper and lower retaining clips on the switch.
6. Remove the wire connections from the switch. Note and label the location of the wires to the switch prior to removal.

7. Disengage the pressure gauge from the Display / Control panel by depressing the retaining clips on the side of the pressure gauge.

8. Remove the pressure gauge tubing through the bottom jacket panel. Ensure the tubing does not become crimped or damaged during removal.

9. Dismount the Display panel from the Display / Control panel by removing the (4) mounting screws. Do not discard the mounting screws as they will be required for re-assembly of the panel.

10. Pass the switch wiring through the backside of the new Display / Control panel. Reconnect the wiring to the switch as shown in Figure 1.

11. Remount the switch onto the new Display / Control panel. Ensure the switch snaps into place and is secured.

12. Pass the pressure gauge tubing through the front side of the new Display / Control panel. Re-route the tubing through the bottom jacket panel.

NOTICE

Ensure the pressure gauge tubing does not become crimped or damaged.

13. Remount the pressure gauge fitting onto the boiler piping mounting adapter. Ensure fitting is tight. Pipe sealant is not required.

14. Remount the Display panel on the back side of the new Display / Control panel using the existing (4) mounting screws.

15. To mount the new Display / Control panel onto the unit, ensure the (2) mounting screws are 1 to 2 full turns out from full insertion into the panel.

PRESTIGE Front Display/ Control Panel Replacement

- Align the panel mounting screws with the keyhole slots on the back jacket panel.
- Press the panel downward engaging the mounting screws into the back jacket panel. If the panel does not engage and snap into place, remove the panel and tighten the mounting screws.

NOTICE

The panel mounting screws may be tightened by accessing them through the rear of the bottom jacket.

- Remount the front jacket panel.
- Reconnect service power to the unit. The unit is now ready for operation.

