

---

# Burner Head Replacement Kit for PERFORMANCE Products



## Kit Part Numbers:

**PG-25/30/35: PGRKIT09,  
PG-40/45: PGRKIT10**

## Parts List

1. Burner head (PG-25/30/35) or (PG-40/45).
2. Burner head gasket (PG-25/30/35) or (PG-40/45).
3. 4 -phillips screws. (For attaching the new burner head to the burner mounting plate.) PG-25/30/35 burners use a size M5 screw and the PG-40/45 use a size M4 screw.
4. Burner plate insulation.

## Recommended tools:

1. Pipe wrench.
2. Phillips screw driver.
3. 17 mm socket or 17 mm open ended wrench.
4. Flat bladed putty knife.

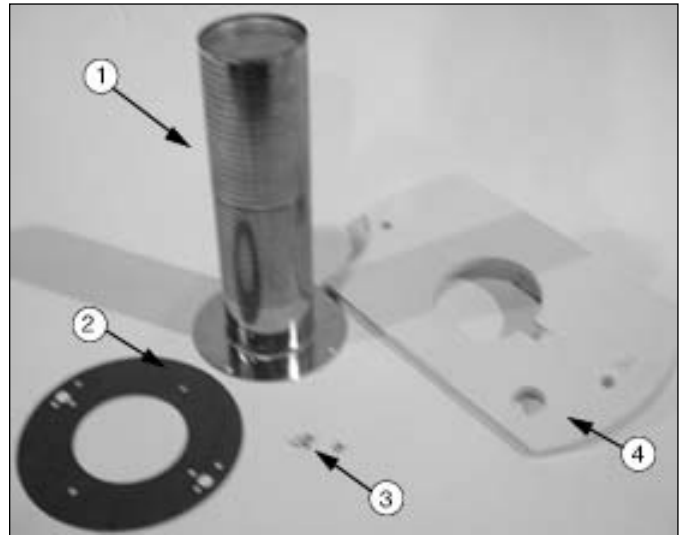

---

### WARNING

**Indicates a potentially hazardous situation which, if ignored, can result in serious injury or substantial property damage.**

### NOTICE

**Indicates special instructions on installation, operation or maintenance, which are important to equipment but not related to personal injury hazards.**

### WARNING

Failure to follow instructions below can result in severe personal injury or damage if ignored.

- Instructions are for a qualified installer/ service technician.
- Read all instructions before proceeding.
- Follow instructions in proper order.

### WARNING

**For your safety, turn off electrical power supply at service panel before proceeding to avoid possible electrical shock hazard. Failure to do so can cause severe personal injury or death.**

---

# Burner Head Replacement Kit for PERFORMANCE Products

## Instructions:

1. Turn power the unit "OFF".
2. Shut off gas supply to the inlet of the unit at the main manual shutoff valve to the unit.
3. Disconnect the gas supply piping to the PERFORMANCE product.
4. Remove the corrugated hose at the air inlet elbow.
5. Disconnect the 6 port snap-set by depressing the snap-set "lock" located in the center of the snap-set.
6. Loosen the two 17mm nuts and remove the burner mounting plate from the PERFORMANCE body, removing the burner assembly from the combustion chamber.
7. Remove the burner mounting plate insulation. If the insulation "sticks" to the mounting plate use a flat bladed putty knife to remove any insulation.

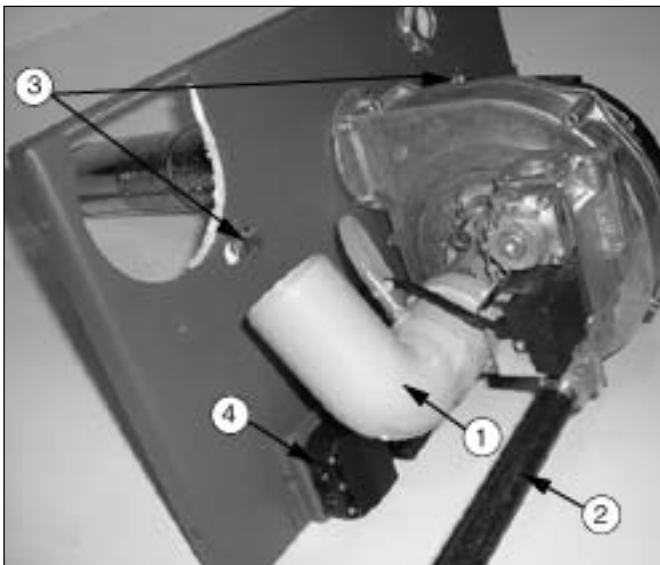

1. Air inlet elbow
2. Gas inlet pipe
3. Two bolts for burner mounting plate
4. Burner snap set connector

## NOTICE

**There is a gasket between the burner head and the inside surface of the burner mounting plate. If the gasket "sticks" to the burner mounting plate use a flat bladed putty**

**knife to remove any gasket material. Make sure not to scratch or score the mating surface.**

8. Loosen the four Phillips head screws attaching the burner head to the burner mounting plate. Remove and discard the old burner head.

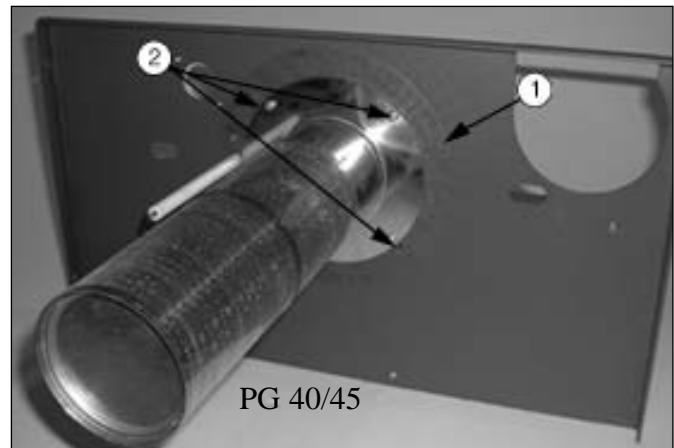
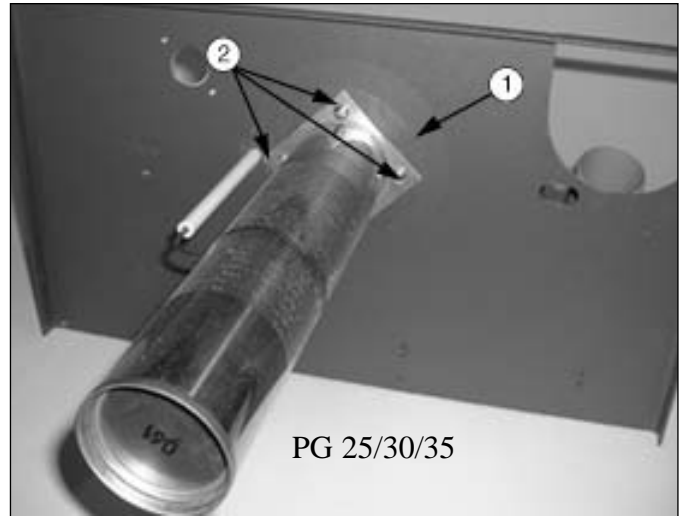

1. Burner head gasket
2. Burner head mounting screws. (3 of 4 shown)

## NOTICE

For the reassembly process do not use adhesives on ANY gasket surface.

9. With the new gasket in place attach the new burner head to the burner mounting plate. (Use the 4 screws supplied in the kit.)

---

## Burner Head Replacement Kit for PERFORMANCE Products

---

10. Check the gap from the ignitor Tip to the burner head surface minimum distance 1/8", maximum distance 1/4"
11. Slide the burner plate insulation to the back of the two studs on the unit. Make sure the cut-out in the insulation for the sight port is in the proper orientation.
12. Hand tighten the two 17mm nuts to hold the burner assembly in place.
  
13. Using a wrench tighten each nut approximately 2 additional full turns past hand tight.

### WARNING

**Do not over tighten. Crushing of the burner plate insulation may occur causing the possible escape of combustion gases from the combustion chamber can result in death, serious injury or substantial property damage.**

14. Reattach the corrugated hose at the air inlet elbow.
15. Reconnect the 6 port snap-set.
16. Using pipe dope compatible with propane gas reconnect the gas supply piping to the PERFORMANCE product.  
Before placing the PERFORMANCE unit back into operation check and test all gas connections for leaks. Repair leaks if found.

### WARNING

**Do not check for gas leaks with an open flame. Use a bubble test. Failure to check for gas leaks can cause severe personal injury, death or substantial property damage.**

17. Turn on gas supply to the inlet of the unit at the main manual shutoff valve to the unit.
18. Turn power to the unit "ON". The unit is now ready to be placed back into service.
19. It is recommended that the installer performs a complete combustion test to ensure

the following levels are met and the burner is operating at optimum conditions:

- O<sub>2</sub>: 4.0% to 4.5%
- CO<sub>2</sub>: 9.5 to 10.0% (natural)
- CO: 0 to 50

### WARNING

**Failure to perform a complete combustion test may result in incomplete combustion and the production of CO, which can cause several personal injury, death or substantial property damage.**

---