

# Pillar Bench

Designed with clean lines, subtle curves, and a geometric silhouette, the Pillar Bench makes for the perfect addition to any room in the home.

THUMA

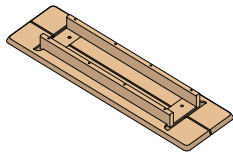

## Step 1

Use the cardboard packaging, or any soft surface, as an underlay during assembly to protect from damage. Flip the bench top over so the bottom side faces up.

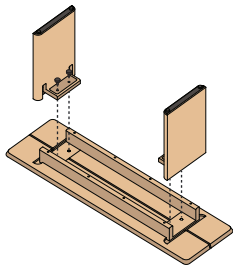

## Step 2

Insert each leg into the bench top. Use two short screws to secure each leg to the bench top and tighten by hand. Then flip the bench upright. Enjoy.