

### FEATURES

- INCLUDES MOUNTING PLATES — 1<sup>3</sup>/<sub>16</sub>" [46mm] x 1<sup>1</sup>/<sub>16</sub>" [30mm]; NYLON ANCHORS AND STEEL PHILLIPS HEAD SCREWS — #8 x 1<sup>1</sup>/<sub>4</sub>" [32mm]
- ZINC DIE-CAST CONSTRUCTION (POSTS)

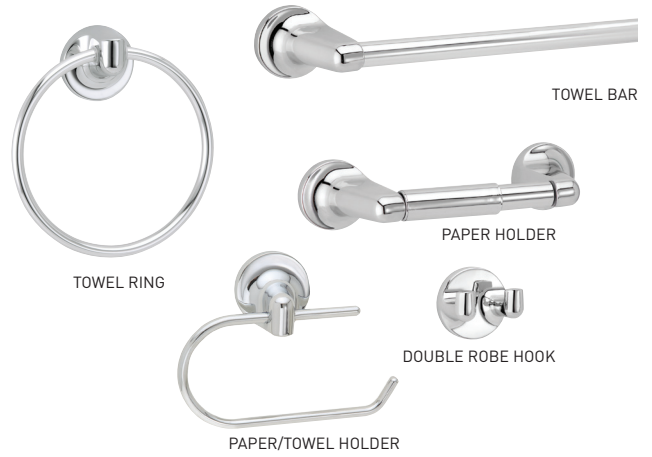

LIFETIME WARRANTY



### TOWEL BAR

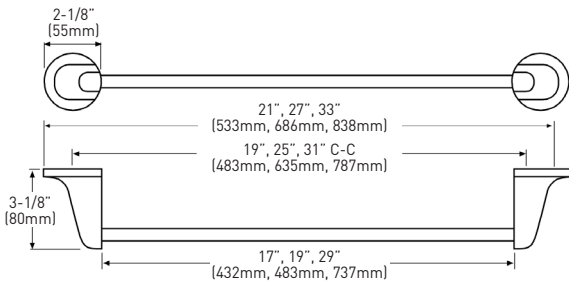

### DOUBLE ROBE HOOK

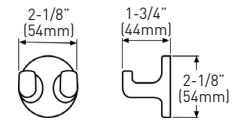

### TOWEL RING

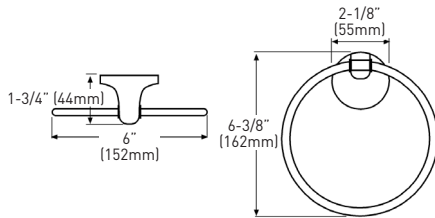

### PAPER/TOWEL HOLDER

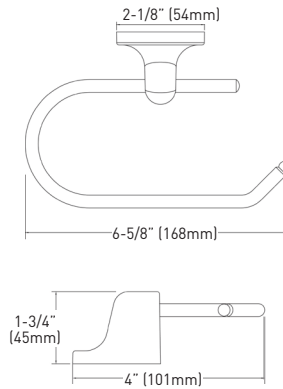

### STANDARD PAPER HOLDER

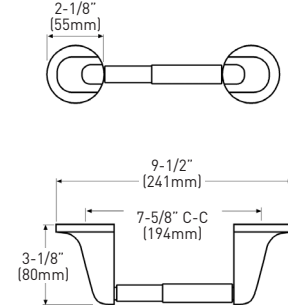

MEASUREMENTS SUBJECT TO A 3% VARIANCE.

### MEASUREMENTS SUBJECT TO A 3% VARIANCE

MEASUREMENTS ARE FOR REFERENCE ONLY. TAYMOR RESERVES THE RIGHT TO CHANGE THE PRODUCT SPECS WITHOUT NOTICE. FOR PRODUCT WARRANTY, PLEASE VISIT TAYMOR WEBSITE FOR DETAILS

DESCRIPTION	SATIN NICKEL 15	POLISHED CHROME 26	MATERIAL	CASE QTY.
18" x 3/4" TOWEL BAR	04-SN8418	04-8418	ZINC/ALUMINUM	10
24" x 3/4" TOWEL BAR	04-SN8424	04-8424	ZINC/ALUMINUM	10
30" x 3/4" TOWEL BAR	04-SN8430	04-8430	ZINC/ALUMINUM	10
DOUBLE ROBE HOOK	04-SN8402	04-8402	ZINC	10
TOWEL RING	04-SN8404	04-8404	ZINC/ALUMINUM	10
PAPER/TOWEL HOLDER	04-SN8448	04-8448	ZINC/ALUMINUM	10
STANDARD PAPER HOLDER	04-SN8408	04-8408	ZINC/PLASTIC	10

