

FEATURES

- › ANSI/BHMA 156.2 GRADE 1
- › MAXIMUM DUTY CYLINDRICAL CONSTRUCTION
- › CLUTCH MECHANISM* ON ALL LOCKING FUNCTIONS
- › FIXED BACKSET 2-3/4"
- › 1-1/8" x 2-1/4" SQUARE MORTISE LATCH
- › FITS DOORS 1-3/8" (35 mm) - 2" (51 mm) THICK
- › SUPPLIED WITH ASA STRIKE - STANDARD



GRADE 1
ANSI GRADE 1



10 YEAR MECHANICAL WARRANTY



ENTRY
ENTRANCE/OFFICE
INSIDE TURN BUTTON



PRIVACY
RESTROOM
INSIDE PUSH BUTTON



PASSAGE
HALL/CLOSET



STOREROOM



CLASSROOM

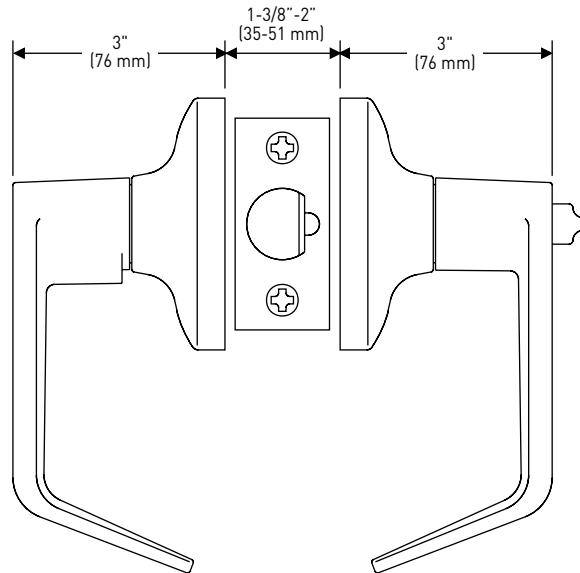
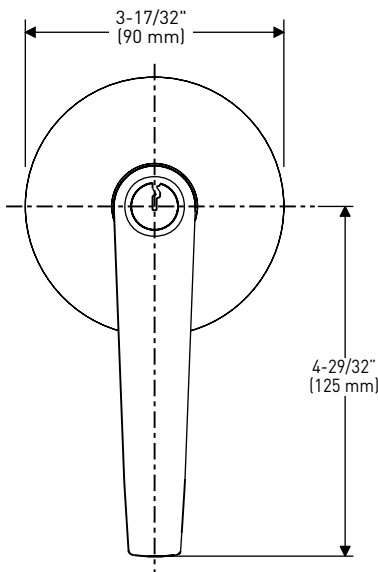

GRADE 1 CYLINDRICAL - BUILDER PACK

		26D SATIN CHROME	CASE PACK
ENTRY - ENTRANCE/OFFICE LEVERSET (INSIDE TURN BUTTON)	*CLUTCH MECHANISM	32-6953	10
PRIVACY - RESTROOM LEVERSET (INSIDE PUSH BUTTON)	*CLUTCH MECHANISM	32-6940	10
PASSAGE - HALL/CLOSET LEVERSET		32-6910	10
STOREROOM	*CLUTCH MECHANISM	32-6980	10
CLASSROOM	*CLUTCH MECHANISM	32-6970	10

