

FEATURES

- > 304 STAINLESS STEEL CONSTRUCTION
- > 19 GAUGE BAR TUBE
- > 23 GAUGE FLANGE COVERS
- > MAXIMUM WEIGHT LOAD 250 lbs (113 kg)
- > MOUNTING HARDWARE INCLUDED
- > IN COMPLIANCE WITH ANSI A117.1
- > IN COMPLIANCE WITH CSA- B651-18
- > MEETS ADA STANDARDS



REFER TO BUILDING CODES HAVING JURISDICTION FOR ALL GRAB BAR COMPLIANCE REQUIREMENTS

1-1/4" DIAMETER GRAB BAR

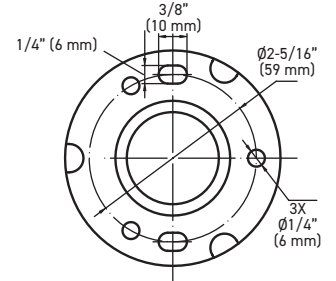
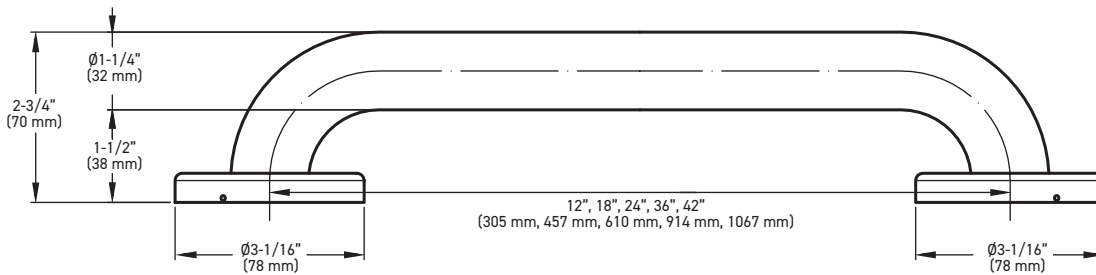

1-1/2" DIAMETER GRAB BAR

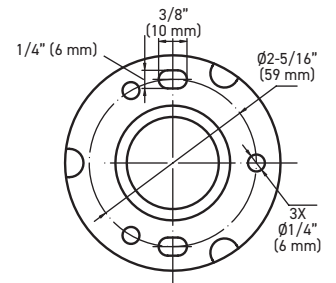
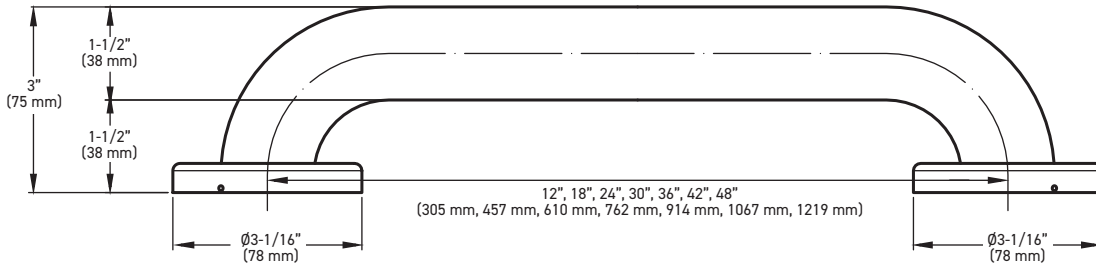

MEASUREMENTS SUBJECT TO A 3% VARIANCE

MEASUREMENTS ARE FOR REFERENCE ONLY. TAYMOR RESERVES THE RIGHT TO CHANGE THE PRODUCT SPECS WITHOUT NOTICE. FOR PRODUCT WARRANTY, PLEASE VISIT TAYMOR WEBSITE FOR DETAILS

STAINLESS STEEL SMOOTH CONCEALED MOUNT GRAB BARS

	SATIN STAINLESS STEEL 32D	CASE QTY		MATTE BLACK 19	SATIN STAINLESS STEEL 32D	CASE QTY
1-1/4" DIAMETER, 18 GAUGE - GRAB BAR - BUILDER PACK			1-1/2" DIAMETER, 18 GAUGE - GRAB BAR - BUILDER PACK			
1-1/4" x 12" (32 mm x 305 mm) SMOOTH GRAB BAR	01-C220012	10	1-1/2" x 12" (38 mm x 305 mm) SMOOTH GRAB BAR	01-C230012BLK	01-C230012	10
1-1/4" x 18" (32 mm x 457 mm) SMOOTH GRAB BAR	01-C220018	10	1-1/2" x 18" (38 mm x 457 mm) SMOOTH GRAB BAR	01-C230018BLK	01-C230018	10
1-1/4" x 24" (32 mm x 610 mm) SMOOTH GRAB BAR	01-C220024	10	1-1/2" x 24" (38 mm x 610 mm) SMOOTH GRAB BAR	01-C230024BLK	01-C230024	10
1-1/4" x 36" (32 mm x 914 mm) SMOOTH GRAB BAR	01-C220036	10	1-1/2" x 30" (38 mm x 762 mm) SMOOTH GRAB BAR	-	01-C230030	10
1-1/4" x 42" (32 mm x 1067 mm) SMOOTH GRAB BAR	01-C220042	10	1-1/2" x 36" (38 mm x 914 mm) SMOOTH GRAB BAR	01-C230036BLK	01-C230036	10
			1-1/2" x 42" (38 mm x 1067 mm) SMOOTH GRAB BAR	01-C230042BLK	01-C230042	10
			1-1/2" x 48" (38 mm x 1219 mm) SMOOTH GRAB BAR	01-C230048BLK	01-C230048	10



CARACTÉRISTIQUES

- > TUBE DE BARRE JAUGE DE 19
- > COLS DE BRIDE JAUGE DE 23
- > CHARGE MAXIMALE 250 lb (113 kg)
- > QUINCAILLERIE DE MONTAGE INCLUSE
- > CONFORME À ANSI A117.1
- > CONFORME À CSA-B651-18
- > RÉPOND AUX NORMES ADA



RÉFÉREZ-VOUS AU CODE DU BÂTIMENT DE VOTRE JURIDICTION
POUR TOUTES LES EXIGENCES DE CONFORMITÉ DES BARRES D'APPUI

BARRE D'APPUI D.E. 1-1/4 po

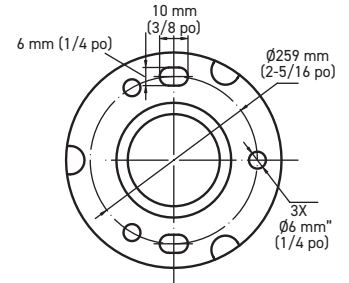
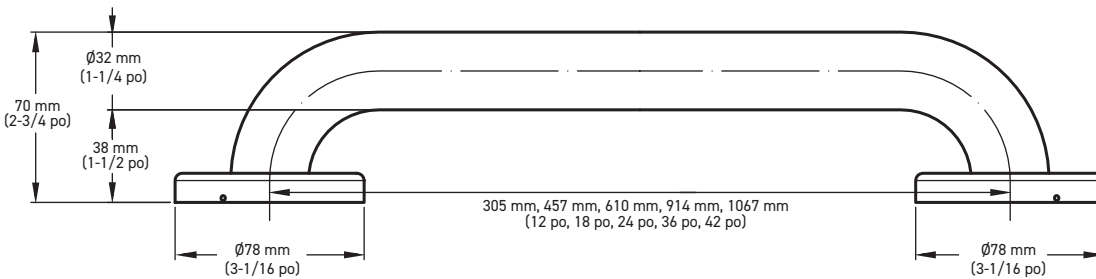

BARRE D'APPUI D.E. 1-1/2 po

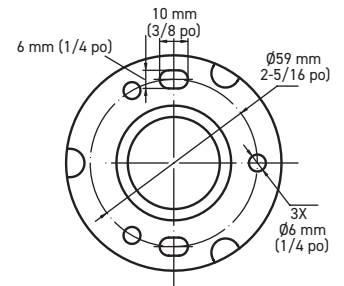
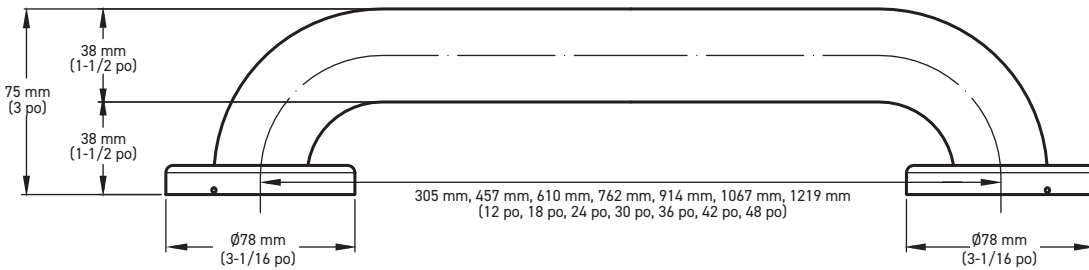

*LES MESURES PEUVENT VARIER DE 3 %
LES MESURES SONT À TITRE DE RÉFÉRER LES SPÉCIFICATIONS DU P IT SANS DONNER D'AVIS. POUR CONSULTER LES DÉTAILS DE LA GARANTIE DU PRODUIT, VEUILLEZ VISITER LE SITE WEB DE TAYMOR.*

BARRES D'APPUI - MONTAGE DISSIMULE ACIER INOXYDDABLE

1-1/4 po D.E., JAUGE DE COL 18- BARRES D'APPUI - EMBALLAGE POUR CONSTRUCTEUR	ACIER INOXYDDABLE SATINÉ 32D	QTÉ LA CAISSE
32 mm x 305 mm (1-1/4 po x 12 po) BARRE D'APPUI LISSE	01-C220012	10
32 mm x 457 mm (1-1/4 po x 18 po) BARRE D'APPUI LISSE	01-C220018	10
32 mm x 610 mm (1-1/4 po x 24" po) BARRE D'APPUI LISSE	01-C220024	10
32 mm x 914 mm (1-1/4 po x 36 po) BARRE D'APPUI LISSE	01-C220036	10
32 mm x 1067 mm (1-1/4 po x 42 po) BARRE D'APPUI LISSE	01-C220042	10

1-1/2 po D.E., JAUGE DE COL 18- BARRES D'APPUI - EMBALLAGE POUR CONSTRUCTEUR	NOIR MAT 19	ACIER INOXYDDABLE SATINÉ 32D	QTÉ LA CAISSE
32 mm x 305 mm (1-1/2 po x 12 po) BARRE D'APPUI LISSE	01-C230012BLK	01-C230012	10
32 mm x 457 mm (1-1/2 po x 18 po) BARRE D'APPUI LISSE	01-C230018BLK	01-C230018	10
32 mm x 610 mm (1-1/2 po x 24" po) BARRE D'APPUI LISSE	01-C230024BLK	01-C230024	10
38 mm x 762 mm (1-1/2 po x 30 po) BARRE D'APPUI LISSE	-	01-C230030	10
32 mm x 914 mm (1-1/2 po x 36 po) BARRE D'APPUI LISSE	01-C230036BLK	01-C230036	10
32 mm x 1067 mm (1-1/2 po x 42 po) BARRE D'APPUI LISSE	01-C230042BLK	01-C230042	10
38 mm x 1219 mm (1-1/2 po x 48 po) BARRE D'APPUI LISSE	01-C230048BLK	01-C230048	10