

SPECIFICATIONS

- › ZINC DIE-CAST CONSTRUCTION
- › COMPLETE WITH SCREW AND EXPANSION SHIELD
- › RUBBER BUMPER

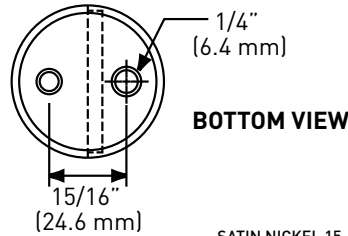
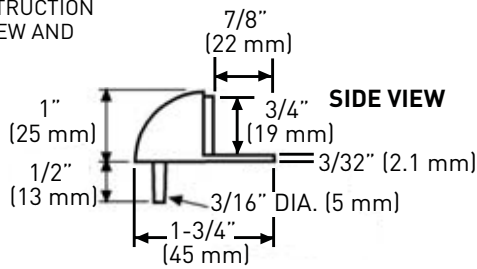

POLY BAGGED WITH UPC

LOW PROFILE DOOR STOP

SATIN NICKEL 15

25-4609SN

CASE QTY

20

SPECIFICATIONS

- › ZINC DIE-CAST CONSTRUCTION
- › COMPLETE WITH SCREW AND EXPANSION SHIELD
- › RUBBER BUMPER

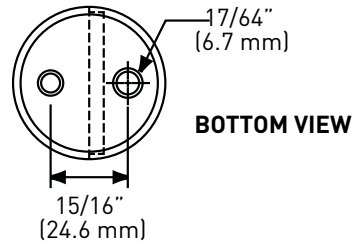
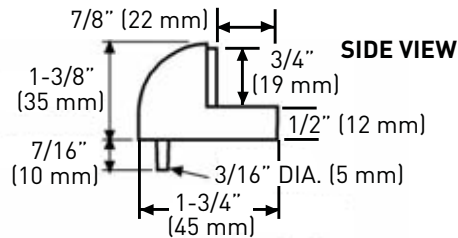

POLY BAGGED WITH UPC

HIGH PROFILE DOOR STOP

DULL CHROME

25-4610DC

CASE QTY

20

SPECIFICATIONS

- › STEEL CONSTRUCTION
- › COMPLETE WITH RUBBER STOPS

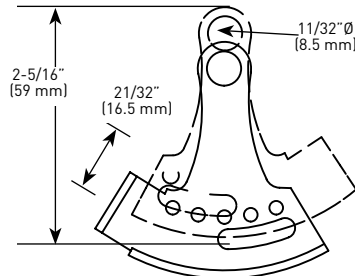

POLY BAGGED WITH UPC

HEAVY DUTY GAUGE STEEL HINGE PIN DOOR STOP

OIL RUBBED BRONZE 10B

25-4636ORB

SATIN NICKEL 15

25-4636SN

POLISHED CHROME 26

25-4636PC

CASE QTY

24

SPECIFICATIONS

- › COMPLETE WITH SCREW AND EXPANSION SHIELD
- › ZINC DIE-CAST CONSTRUCTION
- › RUBBER BUMPERS



CONVEX

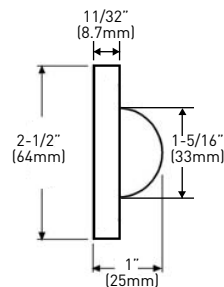

CONCAVE

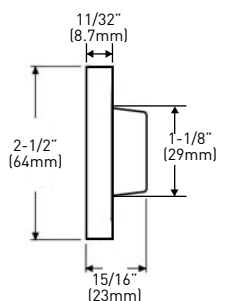

POLY BAGGED WITH UPC

CONVEX WALL STOP

15
SATIN NICKEL

-

26D
SATIN CHROME

25-4611DC

CASE
PACK

10

CONCAVE WALL STOP

25-4612DN

25-4612DC

10

MEASUREMENTS SUBJECT TO A 3% VARIANCE

MEASUREMENTS ARE FOR REFERENCE ONLY. TAYMOR RESERVES THE RIGHT TO CHANGE THE PRODUCT SPECS WITHOUT NOTICE. FOR PRODUCT WARRANTY, PLEASE VISIT TAYMOR WEBSITE FOR DETAILS

