

This document provides installation instructions for the SmartBox+ Quick Attach Latch

SmartBox is a registered trademark of AMVAC Chemical Corporation

Installation overview:

The quick attach latch mounts underneath the SmartBox base, it provides an easy attachment process for installing and removing the granular meter.

To complete the installation; first, the latch and its components are installed onto the base unit. Second the meter funnel is installed onto the meter.

The order of installation is as follows:

- Base unit → Thick orange gasket → Quick attach plate → Blue funnel gasket → Quick attach latch assembly
- Meter → Thin orange gasket → Meter Funnel

Tools required:

- 7/16th wrench
- 3/8th wrench

Parts required:

All necessary parts for Quick Attach Latch installation are shipped with the SmartBox+ row unit kit, which is shipped with every SmartBox+ system.

The following list describes the parts required to complete installation of the Quick Attach Latch:

1. SmartBox base unit
2. Thick orange gasket
 - The thick orange gasket is included in the box with the granular meter
3. Quick attach plate
4. Blue 'funnel' gasket
5. Quick attach latch assembly
6. 'Long ¼" 20 bolts/nuts – for quick attach assembly – 4 sets
7. Granular Meter
8. 'Thin' orange gasket
9. Meter 'funnel'
10. 'Short' ¼" 20 bolts/nuts – for Meter 'Funnel – 4 sets

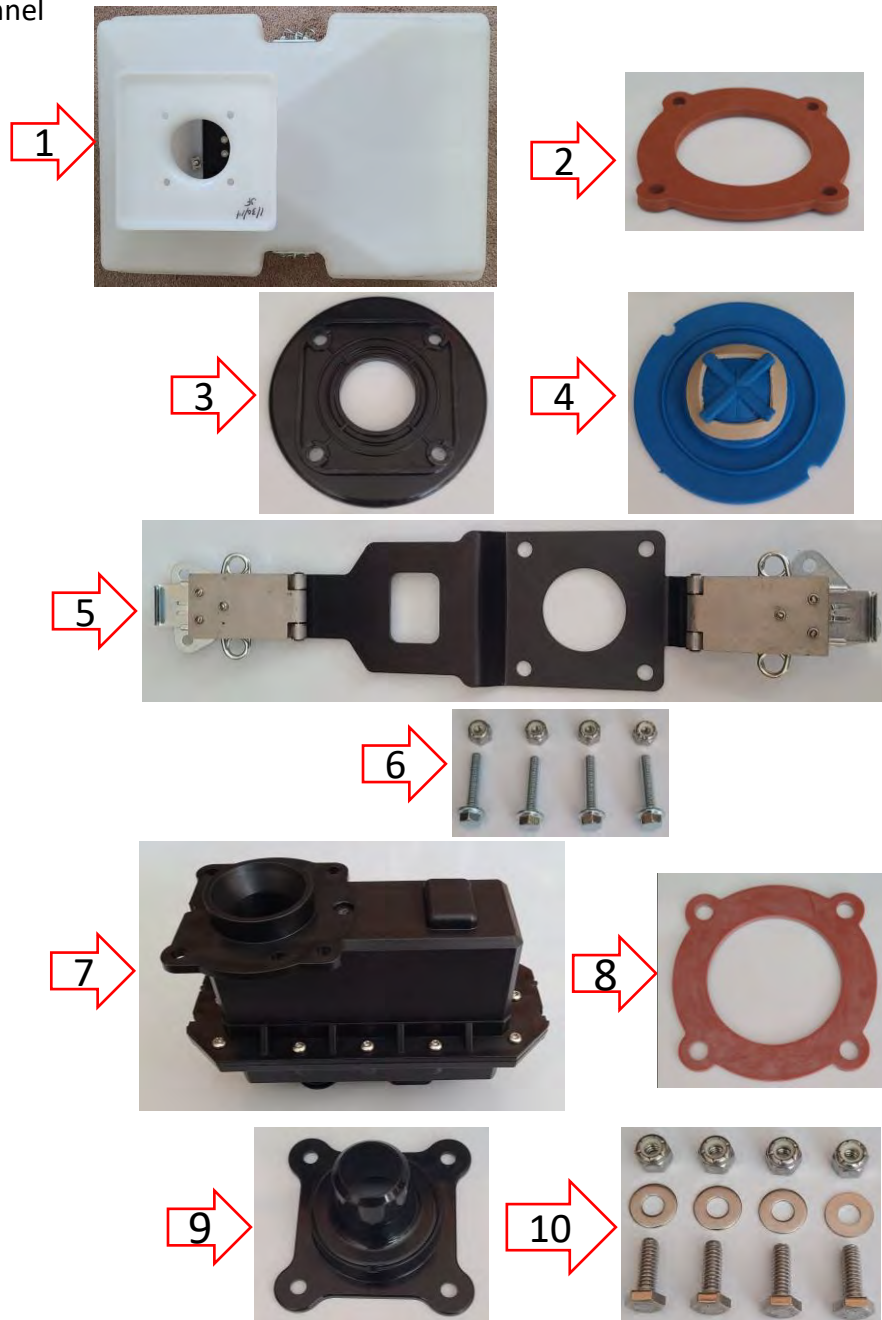

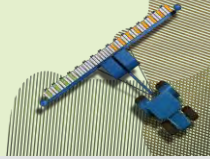

This document provides installation instructions for the SmartBox+ Quick Attach Latch

SmartBox is a registered trademark of AMVAC Chemical Corporation

Quick attach latch installation:

Use the longer ¼" #20 bolts, supplied, to fasten all parts to the base unit.

The quick attach latch is installed with the parts in the following order:

1. Base Unit
2. Thick Gasket
 - Note: this gasket is supplied with the Granular meter
3. Quick attach plate
 - Note: the smooth side of this plate faces down, the side with 'ribs' faces up
4. Blue funnel gasket
5. Quick attach latch assembly
6. 'Long ¼" 20 bolts/nuts

Orientation:

The quick attach latch will be oriented with the longer end under the base unit, as shown in image 5 to the right.

Installation tips:

- When inserting the bolt, hold the nut behind using a finger
- Once all 4 nuts/bolts are in place tighten using a 7/16 wrench on the nut and the 3/8wrench on the bolt
 - Be careful not to overtighten. The plastic of the Base Unit will deform very easily and potentially crack if over-tightened

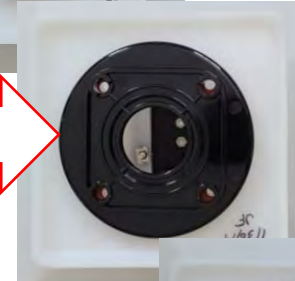
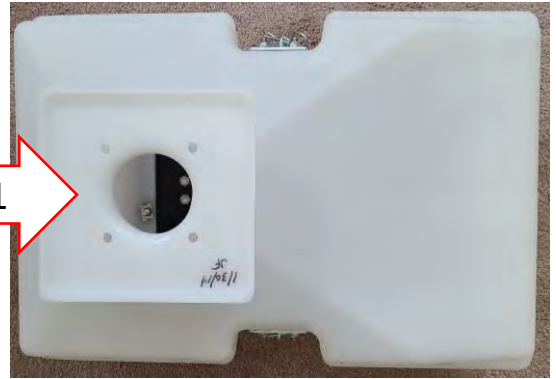

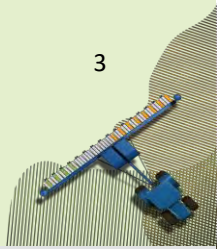

This document provides installation instructions for the SmartBox+ Quick Attach Latch

SmartBox is a registered trademark of AMVAC Chemical Corporation

Install the meter funnel:

Use the shorter ¼" #20 bolts, supplied, to fasten all parts to the base unit.

The meter funnel is installed with the parts in the following order:

7. Meter
8. Thin Gasket
 - Note: this gasket is supplied with the Quick Attach Latch
9. Meter funnel
10. 'Short' ¼" 20 bolts/nuts

Installation tips:

- When tightening, ensure the bolt passes fully through the nyloc nut
- Be careful not to overtighten. The gasket will deform and possibly split if overtightened.

