

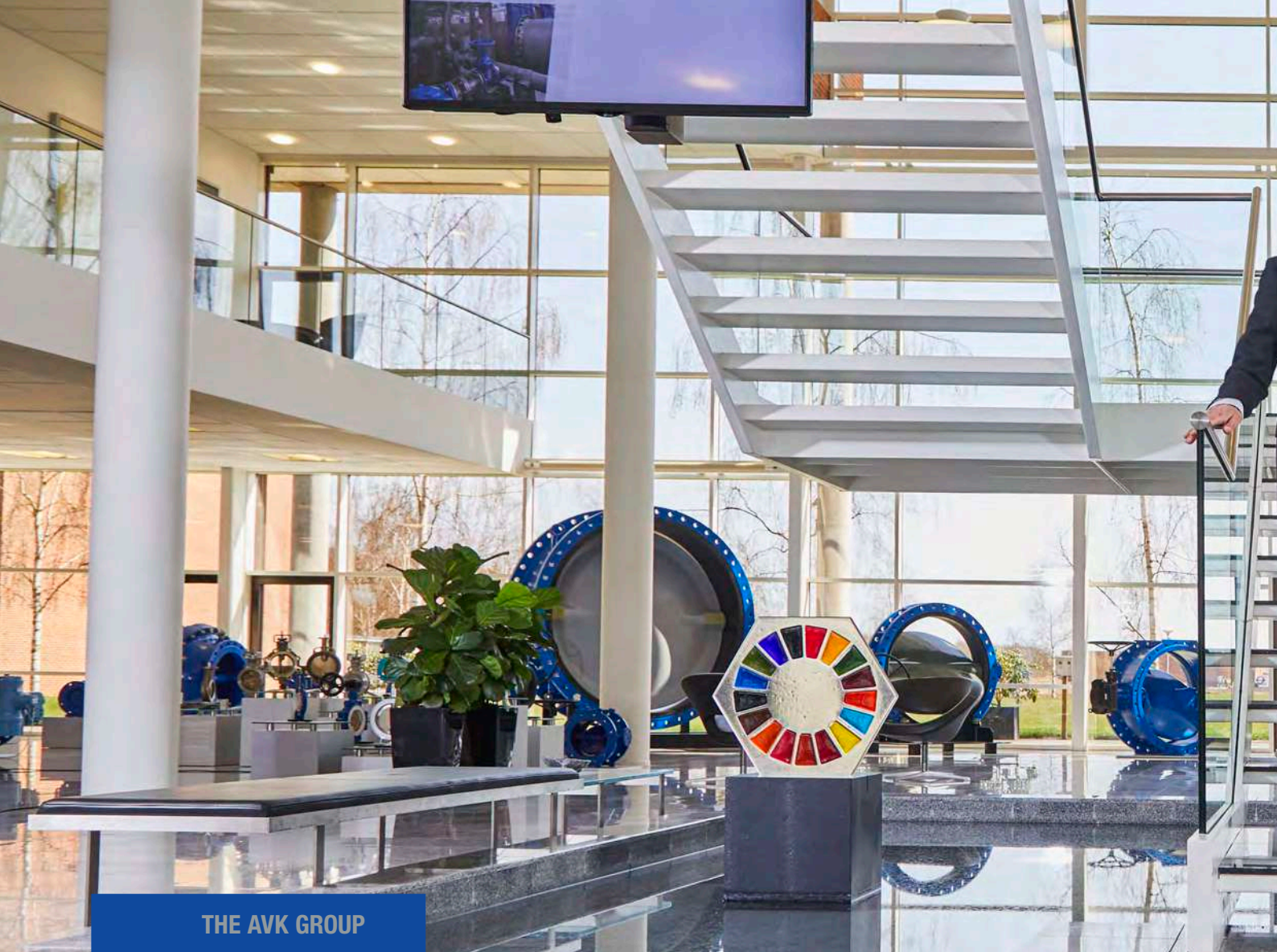

THE SOLUTIONS
YOU NEED
**THE STANDARDS
YOU EXPECT**

Expect... **AVK**





THE AVK GROUP



DEDICATED PEOPLE

5,300+ employees,
hereof approx. 230 in
AVK International A/S



GLOBAL ORGANISATION

100+ AVK companies
worldwide



CONTINUOUS GROWTH

Net turnover EUR 1200
million (2023/24)

AVK YOUR LONG-TERM PARTNER



AVK has been in the valve business for more than 50 years. Today AVK is a global leader within valves, hydrants and accessories for water supply, gas supply, wastewater treatment and fire protection.

The wide AVK range

AVK International A/S specialise in manufacturing gate valves, double eccentric butterfly valves, ball check valves, service connection valves, Supa Maxi™ couplings, extension spindles and selected types of hydrants and accessories.

We add numerous products to our range from the more than 20 other AVK factories in Europe as well as from AVK factories worldwide. These AVK factories specialise in other types of valves, hydrants and accessories, and jointly we are capable of offering a very wide selection of high quality products.

Global leadership and local commitment

Our geographical presence and product range is global, but our focus is local. Our customers are serviced by local sales organisations, in AVK's own sales companies or within our carefully selected distributors, who engage in their customers' needs. We are therefore able to offer tailor-made solutions that match local specifications.

A beneficial partnership

We want to build and invest in a longterm partnership with our customers. To earn our role as a long-term partner, we strive to deliver value for money. We deliver error-free, durable and maintenance-free products that constitute the most cost-efficient solution for our partners in the long run.

EXPECT QUALITY IN EVERY STEP

State-of-the-art rubber technology

It is crucial that the rubber components inside valves, hydrants and accessories are of the highest quality to ensure a safe, watertight seal and trouble-free operation, even after many years without use. In our rubber factory, AVK GUMMI A/S, we develop and produce our own rubber components to make sure that they meet our uncompromising standards of excellence.

Our gate valve wedge design and other market-leading innovations provide the reliability you need to safeguard your network, your supply and the health and safety of your customers. This is especially important within water supply to avoid contamination and within gas supply to avoid even the tiniest leakage. AVK is the safe choice since we give high priority to quality and compliance.

For over 40 years, AVK GUMMI has made rubber components for the water, natural gas, healthcare and food industries. Our complete production control and one of the world's most advanced mixing plants enable us to offer rubber compounds of exceptional quality and uniformity, which are approved worldwide for drinking water, gas and many other applications.

Streamlined processes facilitate short lead times

In our factories, all our products undergo careful surface treatment and rigorous testing to ensure durability and to make certain they can withstand even the harshest environments. We are in full control of the supply chain from raw materials to finished product with meticulous attention to quality control, traceability and pressure testing of every single valve.

Based on LEAN principles, we have streamlined our work processes and flow of goods to ensure the fastest possible lead time. We store a large selection of AVK's product range in our 13,000 m² warehouse fitted with AGVs for automated internal transport, and our warehouse management system enables us to optimise our inventory and handling. Altogether, this allows us to offer great delivery service.

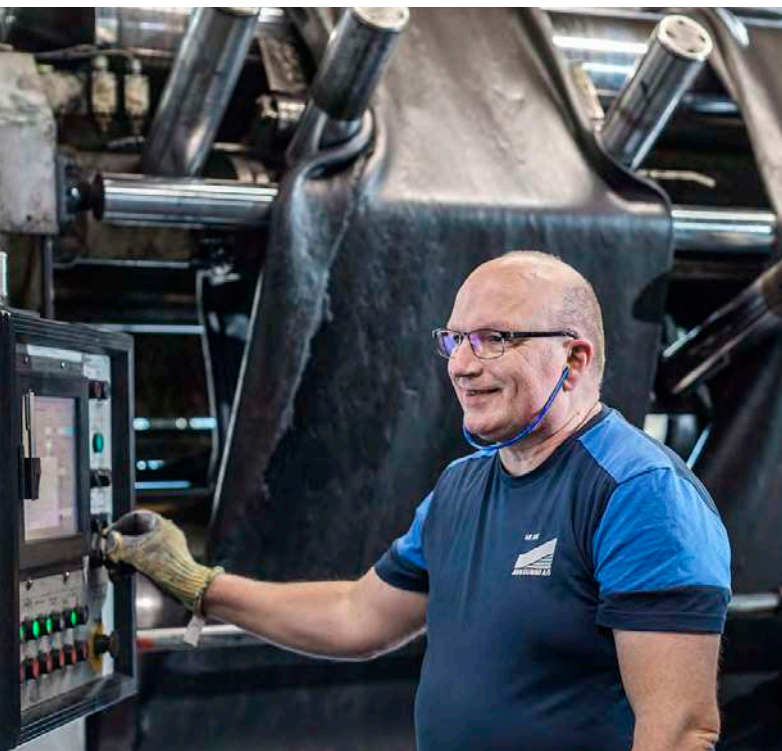

EXPECT US TO TAKE RESPONSIBILITY

Water is a scarce resource

Access to clean water is often taken for granted, just like the fresh air we breathe. But we are facing an invisible, yet crucial problem of water loss, also referred to as non-revenue water. Non-revenue water is water that has been produced and cleaned but which is lost somewhere in the water distribution system without being used or paid for. The levels of non-revenue water range from about 5% to as much as 80% in certain areas.

AVK offers a wide range of reliable and long-lasting valves ensuring tightness many years after the valves have been installed, no matter if they have been used frequently or not at all. Our control valves contribute to efficient water supply management by maintaining a certain pressure, flow or level, regardless of changes in the supply network. Our digital monitoring solutions make it possible to save resources, reduce water loss and optimise network

activities. Our air valves and check valves contribute to extending the life span of the water network by reducing pipe stress. And in case of pipe leakages, we offer a wide range of collars and clamps for efficient pipe repair.

Focus on sustainability

Our products are parts of vital infrastructure including water supply, wastewater treatment and energy supply that all together contribute to sustainable development, the health of people and a better environment. By delivering high-quality and long-lasting solutions we minimise environmental impacts caused by excavation, repair or replacement.

We have initiated the process of mapping, tracking and measuring the CO₂ emissions in our operations and per product. Minimum energy consumption is a core criterion of our design and production process and of our investments, and we have implemented the

ISO 50001 standard for Energy Management and the ISO 14001 standard for Environment Management. In addition, AVK suppliers must comply with our ethical standards to be a certified supplier of the AVK Group.

Supporting world-transforming goals

Our solutions contribute to the UN sustainable development goals by ensuring clean water and sanitation, by reducing water loss, electricity consumption and CO₂ emissions, and by turning wastewater into affordable and clean energy. AVK has entered into partnerships with other leading Danish companies with the purpose of sharing knowledge within water technology and offering joint solutions for a more sustainable world.



EXPECT LASTING INNOVATIONS



Inhouse R&D

In our Development Department in Denmark, ideas and suggestions for new products are gathered, and existing products are updated continuously.

We use FEA (Finite Element Analysis) to optimise the strength and geometry of our components and CFD (Computational Fluid Dynamics) analyses to validate different product designs prior to creating physical prototypes. This enables us to predict consequences in cases where it is impossible to create full scale tests on physical products.

We make our own test and production equipment, and in our flow lab, we conduct thorough prototype and life cycle tests prior to release for production. New product types are generally field tested in co-operation with end users before final launch.

Quality certifications

AVK's quality management system is certified according to ISO 9001 and the ISO 29001 standard for the oil and gas industry. Moreover, we are certified to the ISO 14001 standard for environmental management, the ISO 50001 standard for Energy Management, and the ISO 45001 standard for occupational health and safety.



EXPECT US TO EXCEED MARKET STANDARDS

Third party certification

Authorities such as DVGW (Germany), KIWA (Netherlands) and UL & FM (the US) offer certification of finished valves, and these are also recognized and accepted by other countries that do not have their own certification schemes.

By obtaining and maintaining the most widely accepted certification, we show our customers that AVK valves always meet the highest quality and safety standards.



Expect... AVK

In our business there are five cornerstones that must be in place in order to meet customer expectations: Quality, reliability, innovation, sustainability and customer service.

But we need to go further than that. We go further to exceed our customers' needs and expectations.

"Expect... AVK" means that our customers should rightfully expect us to exceed market standards. "Expect... AVK" means that we relentlessly strive for increased customer benefits!

To ensure that we keep pushing the boundaries of what the market can expect, we have formulated promises that we will strive to deliver in all our markets:

- EXPECT** A LONG-TERM PARTNERSHIP
- EXPECT** QUALITY IN EVERY STEP
- EXPECT** LASTING INNOVATIONS
- EXPECT** TOTAL SAVINGS
- EXPECT** SOLUTIONS, NOT JUST PRODUCTS
- EXPECT** GLOBAL LEADERSHIP AND LOCAL COMMITMENT
- EXPECT** PROMPT RESPONSE
- EXPECT** IT TO BE EFFECTIVE AND EASY

See more on www.avkvalves.eu





Water supply

Gate valves and accessories, butterfly valves, check valves, regulating valves, air valves, hydrants, couplings, repair collars and clamps, fittings etc



Wastewater treatment

Gate valves, knife gate valves, ball and swing check valves, butterfly valves, air valves, penstocks, couplings, repair collars and clamps.

CORE BUSINESSES

Part of vital infrastructures

AVK has delivered gate valves to the water supply sector since the company was established in 1969, and today AVK is a global leader offering an extensive range of valves, hydrants and accessories. In the 70s we obtained our first DVGW approval for gas valves, and due to our high uniform quality and focus on safety and traceability, AVK is still a trusted supplier to the gas supply sector worldwide. For wastewater treatment we offer a very wide valve range according to all major standards as well as customized solutions. The AVK Group is among the largest manufacturers of fire hydrants worldwide and our range

includes UL/FM/VdS approved hydrants, gate and butterfly valves for fire protection.

AVK's products are securing:

- Clean drinking water without contamination or waste of water in the distribution network
- Efficient handling and cleaning of wastewater from households and industries
- Safe distribution of natural gas enabling a wide use of this eco-friendly energy source for heating, cooking and production
- Reliable fire equipment and water supply enabling firefighters to react fast and efficiently in dangerous situations

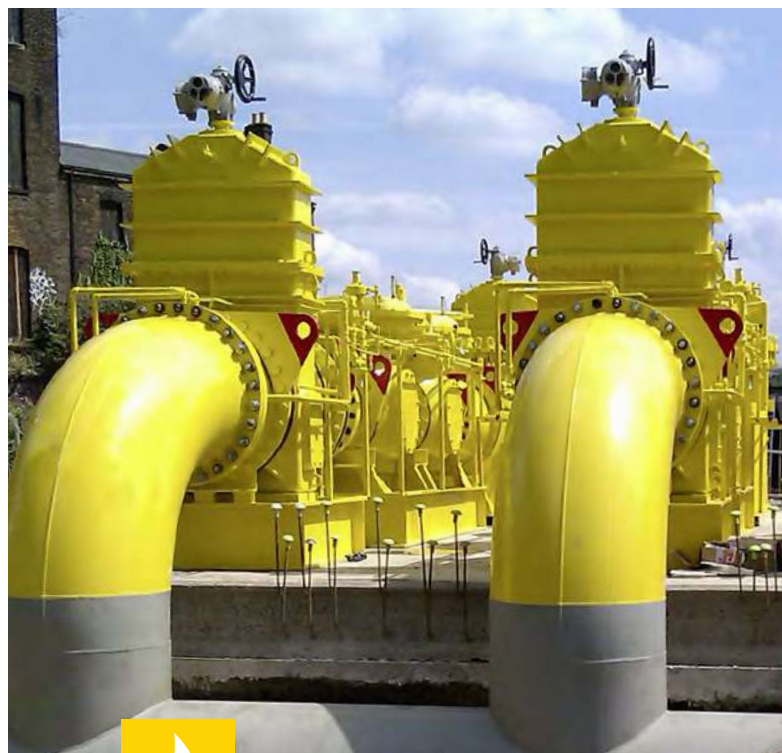

Gas supply

Gate valves and accessories, ball valves, butterfly valves, couplings and repair clamps.



Fire protection

Fire hydrants, monitors, gate valves, post indicators, butterfly valves, check valves and accessories.

PRODUCT FEATURES AND BENEFITS

Product range brochures

Brochures for each of our core businesses are available for download from our website. Here we explain the features and benefits of each main product group and give a detailed overview of AVK's range within water supply, wastewater treatment, gas supply and fire protection.

Find much more information at
www.avkvalves.eu



FLANGED GATE VALVES FOR WATER



Series 06/30

Flanged gate valve
Face-to-face DIN F4
DN40-1200
PN10/16
Ductile iron

Options:

- internal enamel
- duplex stem
- replaceable stem sealing



Series 06/52

Premium 100 gate valve
Flanged
Face-to-face DIN F4
DN40-600
PN10/16
Ductile iron
External PUR coating



Series 06/35

Flanged gate valve
with position indicator
Face-to-face DIN F4
DN50-400
PN10/16
Ductile iron

Options:

- face-to-face DIN F5



Series 15/42

Flanged gate valve
with ISO top flange for actuator
Face-to-face DIN F4
DN40-400
PN10/16
Ductile iron

Options:

- face-to-face DIN F5



Series 02/60

Flanged gate valve
Face-to-face DIN F5
DN40-500
PN10/16
Ductile iron

Options:

- internal enamel
- PN25
- duplex stem
- to GOST



Series 02/75

Flanged gate valve
Face-to-face DIN F5
Replaceable stem sealing
DN40-500
PN10/16
Ductile iron

Options:

- PN25



Series 02/52

Premium 100 gate valve
Flanged
Face-to-face DIN F5
DN40-500
PN10/16
Ductile iron
External PUR coating



Series 02/20

Flanged gate valve
Face-to-face BS
DN50-400
PN10/16
Ductile iron



Series 55/30

Flanged gate valve
DN450-500-600-800
Face-to-face DIN F5
PN10/16
Ductile iron
Resilient seated
Replaceable stem sealing

Options:

- DN80 By-pass



Series 54

Flanged gate valve
DN700-800-900
Face-to-face BS
PN10/16
Ductile iron
Metal seated

Options:

- DN80 By-pass



Series 18/70

Combi-cross
with 4 outlets
DN100-300
PN10/16
Ductile iron

Options:

- with ball valve service outlets
- with blind flange on DN100 centre outlet
- with 3 outlets
- DN80 center outlet



Series 18/01

Combi-cross
flexible design
DN100-400
PN10/16
Ductile iron

Options:

- with ball valve service outlets
- with blind flange on centre outlet
- duplex stem



GATE VALVES WITH PE-ENDS, SPIGOT, COUPLINGS AND SOCKET ENDS FOR WATER

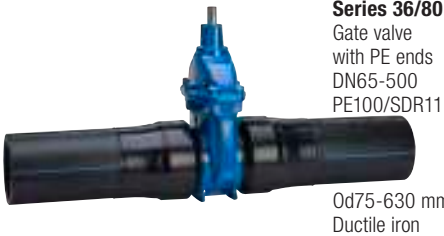

Series 36/80
Gate valve
with PE ends
DN65-500
PE100/SDR11

Od75-630 mm
Ductile iron

- Options:
- SafeTech ends
 - duplex stem
 - PE100/SDR17



Series 36/52
Premium 100 gate valve
with PE ends
DN65-400
PE100/SDR11

Od75-400 mm
Ductile iron
External PUR coating

- Options:
- black/blue pipe ends up to 630 mm
 - PE100/SDR17

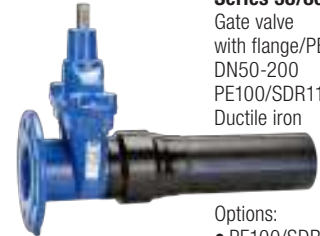

Series 38/80
Gate valve
with flange/PE end
DN50-200
PE100/SDR11
Ductile iron

- Options:
- PE100/SDR17



Series 638
Gate valve
with Supa Maxi™/PE end
DN80-300
PE100/SDR11
Ductile iron

- Options:
- PE100/SDR17



Series 636
Supa Maxi™ gate valve
Universal and tensile
coupling ends for all pipes
DN80-300
PN16
Ductile iron



Series 01/70
Supa Plus™ gate valve
with tensile coupling ends
for PE and uPVC pipes
DN40-300
PN16
Ductile iron

- Options:
- duplex stem



Series 12/51
Gate valve
with flange/spigot end
for cast iron pipes
DN50-300
PN10/16
Ductile iron

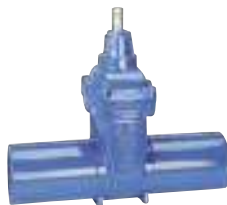

Series 32/40
Gate valve
with long spigot ends
for cast iron pipes
DN80-300
PN16
Ductile iron

- Options:
- short spigot ends for D.I. pipes or AC pipes



Series 06/38
Gate valve
with grooved ends
DN50-300
PN16
Ductile iron



Series 01/80
Gate valve
with "Euro" socket ends
for uPVC-pipes
DN40-400
PN16
Ductile iron

- Options:
- duplex stem



Series 33/00
Gate valve
with socket ends
for cast iron pipes
DN80-300
PN16
Ductile iron
With internal enamel

- Options:
- internal epoxy



Series 33/50
Gate valve
with BLS® socket end/
BLS® spigot end
for cast iron pipes
DN80-300
PN16
Ductile iron



CHECK VALVES AND BUTTERFLY VALVES FOR WATER



Series 41/60
Swing check valve
Resilient seated
Free shaft
DN50-300
PN10/16
Ductile iron

- Options:
- lever and weight
 - lever and spring
 - closed bushings
 - prepared for limit switch



Series 41/36
Swing check valve
Metal seated
With lever and weight
DN350-600
PN10/16
Ductile iron

- Options:
- free shaft



Series 876
Nozzle check valve
Single stem
DN50-350
PN10/16
Ductile iron

- Options:
- multi stem



Series 903
Silent check valve
Metal seat
PN10/16
Ductile iron

- Options:
- PN25
 - stainless steel



Series 820/00
Butterfly valve
Centric with loose liner
Wafer type
DN25-1000
PN10/16
Ductile iron

- Options:
- various actuators



Series 820/10
Butterfly valve
Centric with loose liner
Lug type
DN25-600
PN10/16
Ductile iron

- Options:
- various actuators



Series 820/20
Butterfly valve
Centric with loose liner
U-section type
DN150-1600
PN10/16
Ductile iron

- Options:
- various actuators



Series 75
Butterfly valve
Centric with fixed liner
Wafer type
DN40-1400
PN10/16
Ductile iron

- Options:
- semi lug type
 - full lug
 - various actuators



Series 75
Butterfly valve
Centric with fixed liner
Double flanged short
DN50-2000
PN10/16
Ductile iron

- Options:
- double flanged long
 - various actuators



Series 756/100
Butterfly valve
Double eccentric
Double flanged
Integral seat
IP 67 gearbox
DN150-2800
PN10/16
Ductile iron

- Options:
- internal enamel
 - stainless steel seat
 - IP 68 gearbox
 - ISO-input gearbox
 - PN25 in DN150-1200



Series 756/102
Butterfly valve
Double eccentric
Double flanged
Stainless steel seat
ISO-input gearbox
DN150-2800
PN10/16
Ductile iron

- Options:
- integral seat
 - IP 67 gearbox
 - IP 68 gearbox
 - PN25 in DN150-1200



Series 756/106
Butterfly valve
Double eccentric
Double flanged
Welded stainless steel seat
IP 68 gearbox
DN150-1400
PN10/16
Ductile iron

- Options:
- IP67 gearbox



CONTROL VALVES, NEEDLE VALVES, AIR VALVES AND FLOAT VALVES FOR WATER



Series 859
Control valve
Pressure reducing
DN50-600
PN10/16
Ductile iron/AISI 316



Series 859
Control valve
Pressure sustaining
DN50-600
PN10/16
Ductile iron/AISI 316



Series 859
Control valve
Constant flow
DN50-600
PN10/16
Ductile iron/AISI316



Series 872
Needle valve
DN 80-1600
PN 10/16/25/40
Stainless steel DN80-150
Ductile iron from DN200

- Options:
- various actuators and accessories
 - up to PN100 and DN2000



Series 701/10
Automatic air valve
Threaded BSP ¾" or 1"
DN20-25
PN16
Reinforced polyamide

- Options:
- brass base
 - ductile iron



Series 701/30
Air & vacuum valve
Inlet flange
DN50-300
PN16
Ductile iron



Series 701/40
Combination air valve
DN20, 25 and 50
Threaded BSP ¾", 1" or 2"
PN16
Reinforced polyamide



Series 701/46
Combination air valve
High flow
Threaded BSP 2"/DN50-150 inlet flange
PN16
Ductile iron



Series 701/50
Combination air valve
Inlet flange
DN50-300
PN16
Grey cast iron/reinforced polyamide

- Options:
- ductile iron



Series 701/84
Underground air valve installation system
DN50-100
PN16
Air valve box of PVC



Series 851/41
Combination air valve
DN50-200
ABS float

- Options:
- stainless steel float

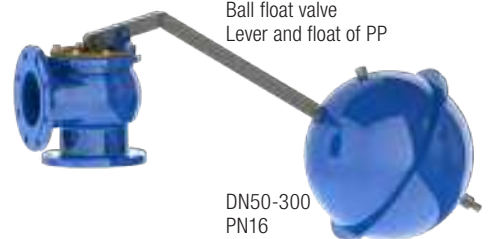

Series 854
Ball float valve
Lever and float of PP

DN50-300
PN16
Ductile iron

- Options:
- lever and float of stainless steel



SERVICE CONNECTION VALVES FOR WATER



Series 03/00
Service connection valve
with internal BSP thread
DN25-50
PN16
Ductile iron

Options:
• internal enamel



Series 03/30
Service connection valve
with tensile socket ends for
PE pipes
DN20-50
PN16
Ductile iron

Options:
• for side tapping with
internal thread/external
thread



Series 03/65
Service connection valve
with tensile screw
couplings for PE pipes
DN25-50
PN16
Ductile iron

Options:
• tensile screw coupling
for PE pipes/external
thread



Series 03/90
Service connection valve
with PRK couplings for
PE pipes
DN20-50
PN16
Ductile iron

Options:
• internal enamel



Series 16/05
Service connection valve
with tensile screw
couplings for PE pipes
DN25-50
PN16
Brass

Options:
• PRK couplings
• T-type bonnet



Series 36/8X
Service connection valve
with PE ends
DN25-50
PE100/PN10
Ductile iron

Options:
• PE100/PN16
• duplex stem



Series 36/5X
Premium 100 service
connection valve
with PE ends
DN25-50
PE100/PN10

Ductile iron
External PUR coating

Options:
• PE100/PN16



Series 16/50
Service connection valve
with tensile socket ends
for PE pipes
DN25-50
PN16
POM (Polyoxymethylene)

Options:
• external thread/tensile
socket end
• T-type bonnet
• duplex stem



Series 16/59
Service connection
valve with Pentomech™
couplings
DN25-50
PN16
POM (Polyoxymethylene)

Options:
• duplex stem



Series 16/80
Service connection valve
with PE ends
DN25-50
PE100/PN16

POM (Polyoxymethylene)

Options:
• T-type bonnet
• duplex stem



Series 16/90
Service connection valve
with PRK couplings
DN25-50
PN16
POM (Polyoxymethylene)

Options:
• PRK coupling/external
thread
• T-type bonnet
• duplex stem



Series 11/30
Service connection angle
valve with external thread
on inlet and tensile socket
end for PE pipes on outlet
DN25-50
PN16
Ductile iron

Options:
• internal thread on outlet



SUPA LOCK™ THREADLESS CONNECTION SYSTEM FOR WATER



Series 103/00
Service connection valve
with Supa Lock™ spigot/
socket end
DN32
PN16
Ductile iron

- Options:
- Supa Lock™ spigot end/PRK coupling
 - duplex stem



Series 103/31
Angle service connection
valve with Supa Lock™
spigot/push-in socket end
DN32
PN16
Ductile iron

- Options:
- Supa Lock™ spigot/
socket end
 - duplex stem



Series 343/81
Ball valve with Supa Lock™
spigot end/BSP thread
1"-1½"
DN32, PN16
Brass

- Options:
- Supa Lock™ spigot end/
PRK coupling
 - Supa Lock™ spigot end/
screw coupling
 - with T-type bonnet



Series 100/14
Tapping saddle
for iron/steel pipes
Ø 60-223 mm
DN32
Ductile iron

- Options:
- for PE/PVC pipes



Series 100/85
Tapping saddle
with blade shut-off
for iron/steel pipes
Ø 50-360 mm
DN32
Ductile iron/stainless steel

- Options:
- for PE/PVC pipes



Series 107/74
Tapping head
with blade shut-off
DN32
Ductile iron



Series 107/31
90° push-in fitting
for PE pipes
Ø 32-63 mm
DN32
Ductile iron

- Options:
- straight push-in fitting
for PE pipes
 - 45° push-in fitting
 - Supa Lock™ socket
end



Series 107/36
Fitting with PE pipe end
Ø 32-40 mm
DN32
Ductile iron



Series 106/01
Fitting with PRK coupling
for PE pipes
Ø 32-40 mm
DN32
Ductile iron

- Options:
- double spigot fitting



Series 106/02
Fitting with screw
coupling for PE pipes
Ø 32-50 mm
DN32
Brass

- Options:
- PRK coupling
 - sensor fitting



Series 106/02
Threaded connector
For connection to drilling
machines
1"-2"
DN32
Brass

- Options:
- ductile iron
 - threaded transition
connector



Series 109/10
Spacer for flanged
connections
DN80-400
DN32
Ductile iron

- Options:
- 3-way socket fitting
 - socket/tyton fittings
 - blind flange



HYDRANTS FOR WATER



Series 84/05

Above ground fire hydrant
Break-away design with
additional ball shut-off
Model P7
DN80/100
PN16
Ductile iron

Options:
• lateral flange



Series 84/72

Above ground fire hydrant
Break-away design with
additional ball shut-off
Model P7
DN80/100
PN16
Stainless steel

Options:
• lateral flange



Series 84/45

Above ground fire hydrant
Break-away design with
additional ball shut-off
Model P7
"NOSTALGIA"
DN80
PN16
Ductile iron

Options:
• lateral flange
• various coatings



Series 84/91

Above ground fire hydrant
Breakable single shut-off
Model N7
DN80/100
PN16
Stainless steel

Options:
• non breakable
• double shut-off
• ductile iron



Series 84/93

Tunnel fire hydrant
Breakable double shut-off
Model N7
DN80
PN16
Stainless steel



Series 09/30

Above ground fire hydrant
Screw down type B
DN80
PN10
Ductile iron

Options:
• manual or automatic
drainage
• aluminium body
• gate valve operated



Series 29/40

Underground fire hydrant
with bayonet coupling
DN100
PN16
Ductile iron

Options:
• 3" stortz oupling
• 3" NOR coupling
• 4" stortz coupling



Series 29/50

Underground fire hydrant
with bayonet coupling
With AVK extension
spindle and riser pipe in
stainless steel
DN100
PN16
Ductile iron



Series 29/78

Underground fire hydrant
Free flow
Single shut-off
DN80
PN16
750-1500 mm
Ductile iron



Series 35/31

Underground fire hydrant
Single shut-off
DN80
PN16
750-1500 mm
Ductile iron

Options:
• stainless steel seat
• backflow prevention



Series 35/8X

Underground fire hydrant
Additional ball shut-off
DN80
PN16
750-1500 mm
Ductile iron
Stainless steel seat



Series 35/72

Underground fire hydrant
DN100-125
PN16
1000-3500 mm
Ductile iron

Options:
• drilling according to
GOST



GATE VALVES, BUTTERFLY VALVES AND KNIFE GATE VALVES FOR WASTEWATER



Series 06/80
Flanged gate valve
Face-to-face DIN F4
DN40-600
PN10/16
NBR wedge
Ductile iron

- Options:
- AISI 316 stem
 - face-to-face DIN F5



Series 06/35
Flanged gate valve
with position indicator
Face-to-face DIN F4
DN50-400
PN10/16
EPDM wedge
Ductile iron

- Options:
- NBR wedge
 - face-to-face DIN F5
 - OS&Y



Series 15/42
Flanged gate valve
for electric actuator
Face-to-face DIN F4
DN40-400
PN10/16
Ductile iron

- Options:
- face-to-face DIN F5
 - hydraulic/pneumatic actuator
 - NBR wedge



Series 36/84
Gate valve
with PE ends
DN65-300
PE100/SDR11

Od75-315 mm
NBR wedge
Ductile iron



Series 715
Flanged gate valve
with hydraulic actuator
Face-to-face DIN F4
DN65-300
PN10/16
NBR wedge
Ductile iron

- Options:
- solenoid valve kit and proximity switches



Series 16/54
Service connection valve
with tensile socket ends
for PE pipes
DN25-50
PN16
POM (Polyoxymethylene)

- Options:
- ductile iron



Series 820/00
Butterfly valve
Centric with loose liner
Wafer type
DN25-1000
PN10/16
Ductile iron

- Options:
- for frequent operation
 - various actuators



Series 820/10
Butterfly valve
Centric with loose liner
Lug type
DN25-600
PN10/16
Ductile iron

- Options:
- for frequent operation
 - U-section type
 - various actuators



Series 75
Butterfly valve
Centric with fixed liner
Wafer type
DN40-1400
PN10/16
Ductile iron

- Options:
- various actuators



Series 75
Butterfly valve
Centric with fixed liner
Semi lug type
DN50-300
PN10/16
Ductile iron

- Options:
- full lug type
 - various actuators



Series 75
Butterfly valve
Centric with fixed liner
Double flanged short
DN50-2000
PN10/16
Ductile iron

- Options:
- double flanged long
 - various actuators



Series 702/20
Knife gate valve
with handwheel and rising
stem
DN50-1200
PN10
Ductile iron

- Options:
- handwheel and non-rising stem
 - chainwheel
 - electric or pneumatic actuator
 - lever



CHECK VALVES, AIR VALVES AND PENSTOCKS FOR WASTEWATER



Series 41/61
Swing check valve
Closed bushings
Resilient seated
DN50-300
PN10/16
Ductile iron



Series 41/60
Swing check valve
Free shaft
Resilient seated
DN50-300
PN10/16
Ductile iron

Options:

- lever and weight
- lever and spring
- prepared for limit switch



Series 41/36
Swing check valve
Metal seated
Closed bushings
DN350-600
PN10/16
Ductile iron

Options:

- free shaft



Series 53/35
Ball check valve
with flanged ends
DN50-600
PN10
Ductile iron



Series 53/42
Ball check valve
with flanged ends
DN80-150
PN10
Stainless steel AISI 316



Series 53/30
Ball check valve
with internal thread
DN32-50
PN10
Ductile iron

Options:

- stainless steel
DN32-80



Series 701/33
Air & vacuum valve
DN80-100
PN16
Steel



Series 701/76
Combination air valve
DN50-200
PN16
Stainless steel

Options:

- steel
- large combination air valve



Series 701/75
Combination air valve
DN50-200
PN10
Reinforced polyamide

Options:

- PN16



Series 701/79
Underground air valve
system
DN50-100
PN10
External box of
polypropylene



Series 772/61
Wall penstock
Bi-directional up to and
incl. 1200 x 1200 mm,
in larger sizes bi- or uni-
directional
With non-rising stem
Stainless steel
AISI 304
200 x 200 mm -
2000 x 2000 mm

Options:

- rising stem
- AISI 316



Serie 772/7172
Channel penstock
Uni-directional up to and
incl. 1000 x 1000 mm,
bi-directional in larger
sizes
With non-rising stem
Stainless steel
AISI 304
200 x 200 mm -
2000 x 2000 mm

Options:

- rising stem
- AISI 316



GATE VALVES, BALL VALVES AND BUTTERFLY VALVES FOR GAS



Series 36/90
Gate valve with PE ends
DN65-400
PE100/PN10 SDR 11
Ductile iron

External epoxy coating

Options:

- PE100/PN10/4
- flange/PE end
- ISO top flange
- external PUR coating



Series 46/64
Gate valve
with short spigot ends
DN50-300
PN16
Cast steel GP240GH
External epoxy coating

Option:

- external PUR coating



Series 46/70
Gate valve
with long spigot ends
DN50-600
PN16
Cast steel GP240GH
External PUR coating

Option:

- external epoxy coating
- ISO top flange



Series 46/80
Gate valve with long
spigot ends and two
purge points
DN80-600
PN16
Cast steel GP240GH
External PUR coating



Series 46/90
Gate valve with steel/PE
spigot ends
DN50-300
PN10

Cast steel GP240GH
External epoxy coating

Options:

- external PUR coating



Series 02/70
Flanged gate valve
Face-to-face DIN F5
DN40-500
PN10/16
Ductile iron
External epoxy coating

Options:

- position indicator



Series 06/70
Flanged gate valve
Face-to-face DIN F4
DN40-600
PN10/16
Ductile iron
External epoxy coating

Options:

- position indicator



Series 15/78
Flanged gate valve
with ISO top flange
DN50-400
PN10/16
Ductile iron
External PUR coating

Option:

- external epoxy coating



Series 36/9X
Service connection valve
with PE ends
DN25-50

PE100/PN10 or 4
Ductile iron
External epoxy coating

Options:

- external PUR coating



Series 03/25
Service connection valve
with internal thread
DN25-50
PN4
Ductile iron
External epoxy coating



Series 85/30
Ball valve
with spigot ends
DN25/Ø20 mm -
DN150/Ø180 mm
PN10
PE100

Options:

- lever
- support base



Series 75
Wafer butterfly valve,
centric with fixed liner
DN50-600
PN10/16
Ductile iron

Options:

- semi-lug
- full lug
- double flanged



HYDRANTS AND VALVES FOR FIRE PROTECTION



Series 27/JA

Dry barrel fire hydrant
Modern style
Bury depth 305-2438 mm
17.2 bar (250 PSI)
Ductile iron
UL/ULC listed,
FM approved

Inlet options:

- DN100-150 flanged
- DN100-150 PE end
- monitor fire hydrant



Series 24/90

Wet barrel fire hydrant
13.7 bar (200 PSI)
2 x 2½" + 1 x 4¼"
outlets
Ductile iron
UL listed, FM approved



Series 06/35

Flanged gate valve
with position indicator
DN50-400
PN10/16
Ductile iron
VdS approved
(DN50-200 only)



Series 06/37

Grooved end gate valve
with position indicator
DN50-300
PN16 drilling
Ductile iron
VdS approved
(DN50-200 only)

Option:

- ½" BSP drilled bosses



Series 45/59

Flanged gate valve
with post indicator flange
DN50-400
17.2 bar (250 PSI)
Ductile iron
UL/ULC listed, FM approved

Options:

- ANSI drilling class 150



Series 36/00

Gate valve with PE ends
and post indicator flange
DN80-300

SDR11/PE100
Ductile iron



Series 145/Series 45

Flanged gate valve
with rising stem
DN50-300
17.2 bar (250 PSI),
UL/ULC listed, FM approved
DN350-400
13.7 bar (200 PSI),
UL/ULC listed
17.2 bar (250 PSI),
FM approved
Ductile iron

Options:

- with wrench nut
- ANSI drilling class 150



Series 55

Flanged gate valve
with wrench nut
DN450-600
13.7 bar (200 PSI),
UL/ULC listed
17.2 bar (250 PSI),
FM approved
PN16 drilling
Ductile iron

Options:

- post indicator flange
- rising stem



Series 75

Butterfly valve
Centric with fixed liner
Double flanged short
DN50-300
PN10/16
Ductile iron
FM approved

Options:

- wafer
- lug
- single flanged



Series 34/00

Post indicator, telescopic
for DN100-600 post
indicator gate valves
Bury depth: 505-2210 mm
Ductile iron
UL/ULC listed,
FM approved

Options:

- other lengths on request



Series 34/80

Wall post indicator
for DN100-400 post
indicator gate valves
Stem length: 250-1250 mm
Ductile iron
UL/ULC listed,
FM approved



Series 5190/10

Swing check valve
Spring loaded
Grooved ends to AWWA
C606
DN50-200
24.1 bar/350 PSI
UL/ULC listed, FM
approved

Options:

- shotgun type
- with flanges



SUPA ONE™, SUPA MAXI™, SUPA PLUS™ AND SUPA® COUPLINGS AND ADAPTORS



Series 651/00
Supa One™ universal
straight coupling
DN80-200
PN16
Ductile iron



Series 653/00
Supa One™ universal
flange adaptor
DN80-200
PN16
Ductile iron



Series 631/00
Supa Maxi™ universal
tensile straight coupling
DN50-800
PN16
Ductile iron

Options:
• step coupling
• for gas PN10



Series 633/00
Supa Maxi™ universal
tensile flange adaptor
DN40-800
PN10/16
Ductile iron

Options:
• for gas PN10



Series 634/00
Supa Maxi™ universal
tensile end cap
DN50-400
PN16
Ductile iron

Options:
• for gas PN10



Series 635/00
Supa Maxi™ universal
tensile transition coupling
with factory mounted
PE pipe
DN50-300
PN10 or 16
Ductile iron

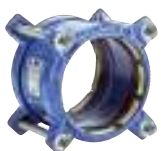

Series 621/10
Supa Plus™ coupling
Tensile for PE and uPVC
pipes
DN32-300
PN16
Ductile iron

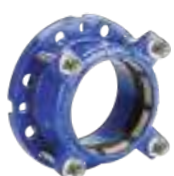

Series 623/10
Supa Plus™ flange
adaptor
Tensile for PE and uPVC
pipes
DN40-300
PN10/16
Ductile iron



Series 624/10
Supa Plus™ end cap
Tensile for PE and uPVC
pipes
DN40-300
PN16
Ductile iron



Series 601
Supa® universal straight
coupling
DN40-400
PN16
Ductile iron

Options:
• step coupling



Series 603
Supa® universal flange
adaptor
DN40-400
PN10/16
Ductile iron



Series 05/08
Support bush
for PE pipes
DN50-600
PN6.3, 10, 12.5 or 16
Stainless steel



COUPLINGS, DISMANTLING JOINTS AND TAPPING SADDLES



Series 05
Combi-flange
for PE and PVC pipes
Non-tensile (PVC) DN50-600
Tensile DN50-300
PN10/16
Ductile iron

- Options:
- for ductile iron pipes
 - for steel pipes (non-tensile)



Series 258
Fabricated dedicated
straight coupling
for AC, steel, cast iron or
ductile iron pipes
DN350-2000
PN8 to 25
Steel

- Options:
- step coupling
 - flange adaptor



Series 8004
Fabricated universal flange
adaptor
Steel
DN400-2000
PN16

- Options:
- straight coupling
 - stainless steel



Series 745/01
Repico® grip coupling
Universal and tensile for
all metal pipes
NBR or EPDM sealing
DN15-400
Stainless steel AISI 316

- Options:
- for medium pressure up to DN200



Series 745/20
Repico® slip coupling
Universal and non-tensile
for all pipes
NBR or EPDM sealing
DN15-600
Stainless steel AISI 316

- Options:
- 2 locks up to DN1000



Series 265/91
Dismantling joint
for all pipe material
DN40-1200
PN10/16
Ductile iron
GSK coating



Series 873
Dismantling joint for all
pipe materials
With centre flange
DN40-2600
PN10/16/25
Ductile iron



Series 10/00
Tapping saddle
for uPVC and PE pipes
DN50-300
Ductile iron
Lower part in stainless
steel from DN250

- Options:
- for cast iron, ductile iron and steel pipes



Series 730
Universal tapping saddle
with blade shut-off
for ductile iron, steel and
other metal pipes
DN50-300
Ductile iron/steel

- Options:
- without blade shut-off



Series 727/10
Tapping saddle
with blade shut-off
For PE and PVC pipes
DN80-200
Ductile iron



Series 727/21
Tapping saddle SWIC
for underpressure drilling
With integrated cutter for
PVC pipes
Od90-160 mm
Ductile iron

- Options:
- with integrated cutter for PE and PVC pipes od50-295 mm



Series 6731
Flanged universal tapping
saddle with blade shut-off
for iron, steel, PE and
PVC pipes
Ductile iron

- Options:
- slim type



VALVE ACCESSORIES



Series 04

Fixed surface box
Grey cast iron
Distance ring/square for
fixed surface box

Options:

- reversible design



Series 80

Surface box "Classic"
Fixed height
Body of PA+

Options:

- square or round
- lid of cast iron or PA
- for gate valves, service connection valves or underground hydrants



Series 80

Surface box "Classic"
Height adjustable
Body of PA+

Options:

- square or round
- lid of cast iron or PA
- for gate valves, service connection valves or underground hydrants



Series 80

Surface box "Futura"
Fixed height
Body of PA+

Options:

- square or round
- lid of cast iron or PA
- for gate valves, service connection valves or underground hydrants



Series 04/007

Floating surface box
for telescopic extension
spindle
Body of PE
Flange and lid of ductile
iron

Options:

- round - black
- round - blue epoxy
- square - black
- square - blue epoxy



Series 04/008

Floating surface box
for telescopic extension
spindle
Ductile iron

Options:

- round or square surface plate
- round or square lid
- double surface box



Series 04

Extension spindle
for service connection
valves
DN25-50

Options:

- telescopic or fixed length



Series 04

Extension spindle
for gate valves
DN40-600

Options:

- telescopic or fixed length
- telescopic for double eccentric butterfly valves



Series 04

Stem caps
for gate valves and
service connection valves
DN25-600
Ductile iron



Series 08

Handwheel
for gate valves
DN50-600
Grey cast iron

Options:

- for double eccentric butterfly valves



Series 756/5

Adaptor for connecting
gearside to extension rod,
wall post indicator or post
indicator
DN200-1200
Ductile iron



Series 910

Y-strainer
DN50-300
Ductile iron



REPAIR COLLARS AND CLAMPS, FITTINGS AND FOUNTAIN POSTS



Series 8001
Hydro Stop universal
socket encapsulation
collar
Steel
EPDM rubber
DN250-2000

Options:
• pipe encapsulation
collar
• customised design and
larger DN's



Series 8002
Hydro Fast dedicated
socket encapsulation
collar
Steel
EPDM rubber
DN300-2000

Options:
• pipe encapsulation
collar
• customised design and
larger DN's



Series 8003
Hydro Smart dedicated
socket encapsulation
collar
Steel
EPDM rubber
DN80-250

Options:
• customised design



Series 748/01
Repair clamp
Single band
Stainless steel AISI 304
or AISI 316
NBR or EPDM rubber

Options:
• handgrip



Series 748/02
Repair clamp
Double band
Stainless steel AISI 304
or AISI 316
NBR or EPDM rubber

Options:
• handgrip



Series 748/03
Repair clamp
Triple band
Stainless steel AISI 304
or AISI 316
NBR or EPDM rubber



Series 712
Flanged bend
Ductile iron

Options:
• various types



Series 712
Flanged cross
Ductile iron

Options:
• various types



Series 712
Flanged reducer
Ductile iron

Options:
• various lengths

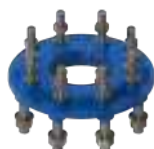

Series 712
Reducer flange
Ductile iron



Series 712
Duckfoot bend
Ductile iron



Series 78/7510
Fountain post
"VICTORIA"
Frost-proof
DN40
Grey cast iron

Options:
• outlet for fire hose
connection



SMART WATER IOT SENSORS AND SOFTWARE



Series 3004/002

VIDI Positioner
Open/close position indicator for AVK extension spindles
Wireless
10-year battery life
NB-IoT or LoRa® communication
IP68



Series 3004/101

VIDI Positioner
Open/close position indicator for gate valves
Wireless
10-year battery life
NB-IoT or LoRa communication
IP68



Series 3002/002

VIDI Cap
Hydrant cap detecting open/close status
For threaded Storz B outlet
Wireless
10-year battery life
NB-IoT or LoRa® communication
IP68



Series 3001/001

VIDI Pressure
Sensor measuring water pressure
Wireless
10-year battery life
NB-IoT or LoRa® communication
IP68 (transmitter)



Series 3001/002

VIDI Flow
Sensor transmitting water flow
Wireless
10-year battery life
NB-IoT or LoRa® communication
IP68 (transmitter)



Series 3001/004

VIDI Level
Sensor measuring distance to nearest surface
Wireless
10-year battery life
NB-IoT or LoRa® communication
IP68 (transmitter)
IP67 (level sensor)



Series 3001/003

VIDI Temperature
Sensor measuring water temperature
Wireless
10-year battery life
NB-IoT or LoRa® communication
IP68 (transmitter)



Series 3004/001

VIDI Open/Close
Open/close position indicator for AVK valves
Wireless
10-year battery life
NB-IoT or LoRa® communication
IP68 (transmitter)



Series 3005/001

Outdoor LoRaWAN®-gateway
for series 3001, 3002 and 3004
SIM card
Ethernet (RJ45)
IP67



Series 3005/002

VIDI software
for collecting and visualising data
Access through standard web browser
Unlimited number of units and users

Options:

- VIDI Basic
- VIDI Advanced
- VIDI Premium



CONTACT

AVK INTERNATIONAL A/S

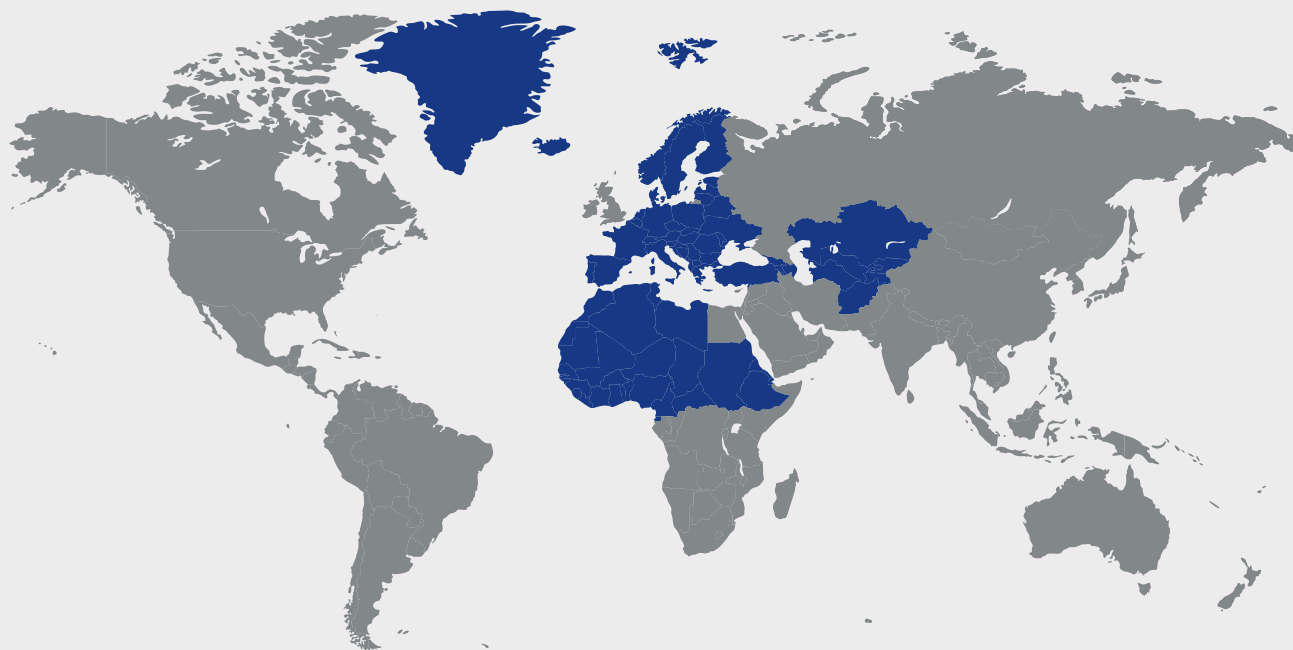

AVK International A/S is responsible for the geographical region consisting of Continental Europe, Central Asian countries, Caucasian countries and Northern Africa as per the map above. Please contact us directly or find your local contact in the list.

For the countries marked with grey colour please refer to www.avkvalves.com for contact information.

AVK International A/S

Bizonvej 1, Skovby
DK-8464 Galtén
Denmark
Tel: +45 8754 2100
www.avkvalves.eu

AVK International A/S Rep. office the Baltic states

Ozolu str. 28, K 1, Jaunmarupe
Marupe county, LV 2166
Latvia
Tel: +371 256 219 95
jutr@avkgroup.com
www.avkvalves.lv

AVK International A/S Rep. office Greece

L. Vouliagmenis 85 (City Plaza)
16674, Glyfada
Athens, Greece
Tel: +30 69 55 66 48 85
nisi@avkgroup.com
www.avkvalves.gr

AVK International A/S Rep. office the Balkans

Marsala Tolbuhina 44
Belgrade
Serbia
Tel: +381 64 142 19 33
brmi@avkgroup.com
www.avk.rs

AVK International A/S Rep. office Romania

B-dul Agronomiei
No. 8-16, Bl. N1.3
Ap. 3, Sector 1
Bucharest
Romania
Tel: +40 21 326 5017
office@avk.ro
www.avk.ro

AVK International A/S Rep. office Turkey

Ayazaga Mah., Dereboyu Cad.
Meydan Sok. Veko Giz No:3/85
34398 Maslak / Sarıyer / İstanbul
Turkey
Tel.: +90 212 403 95 85
issi@avkgroup.com
www.avkvana.com.tr

AVK International A/S Rep. office Slovakia

Vinne 136
072 31 Vinne
Slovakia
Tel: +421 907 682 815
antmak@avkgroup.com
www.avkvalves.sk

AVK International A/S Rep. office North and West Africa

Cocody Danga
Abidjan
Ivory Coast
Tel: +225 0704540595
guivio@avkgroup.com
www.avkvalves.eu

EXPECT GLOBAL LEADERSHIP AND LOCAL COMMITMENT



AVK Danmark A/S

Bizonvej 1
DK-8464 Galtén
Denmark
Tel: +45 8754 2100
salg@avk.dk
www.avkventiler.dk

Vatech 2000 ApS

Værkstedsvej 15
5500 Middelfart
Denmark
Tel: +45 6440 2060
admin@vatech.dk
www.vatech.dk

AVK Norge AS

Hågasletta 7
3236 Sandefjord
Norway
Tel: +47 33482999
avk@avk.no
www.avk.no

AVK Sverige AB

Industrigatan 28
28143 Hässleholm
Sweden
Tel: +46 451 458 00
sales@avkvalves.se
www.avkvalves.se

AVK Finland Oy

Ilmailunkatu 21
SF-33900 Tampere
Finland
Tel: +358 3 389 1822
toimisto@avk.fi
www.avkfinland.fi

AVK Armaturen GmbH

Schillerstraße 50
42489 Wülfrath
Germany
Tel: +49 2058-901-01
info@avk-armaturen.de
www.avk-armaturen.de

AVK Belgium NV

Zoomstraat 6A
9160 Lokeren
Belgium
Tel: +32 93481313
info@avkvalves.be
www.avkvalves.be

AVK Nederland BV

Radeweg 12
P.O. Box 73
8170 AB Vaassen
The Netherlands
Tel: +31 57 857 44 90
info@avknederland.nl
www.avknederland.nl

InterApp Ges.m.b.H.

Kolpingstrasse 19
A-1230 Wien
Austria
Tel: +43 (1) 61 623 71-0
info@at.interapp.net
www.interapp.net

AC.MO S.R.L.

Via T. da Modena, 28 z.i.
I-31056 Roncade (TV)
Italy
Tel: +39 0422 840220
info@acmospa.com
www.acmosrl.com

AVK Armadan Sp. z o.o.

ul. Jakubowska 1
62-045 Pniewy
Poland
Tel: +48 61 291 20 01
avk@avk.com.pl
www.avk.com.pl

AVK VOD-KA a.s.

Labská 233/11
412 01 Litoměřice, Předměstí
Czech Republic
Tel: +420 416 734 980
obchod@vodka.cz
www.avkvodka.cz

AVK France S.A.S.

Z.I. de Villebarou
4 rue de la Garbotière
CS 2904
41029 Blois Cedex
France
Tel: +33 2 54 74 23 13
avk@avk.fr
www.avk.fr

AVK Válvulas S.A.

Pol. Ind. Constantí
Av. Europa, 27-31
43120 Constantí - Tarragona
Spain
Tel: +34 977 543 008
avk@avkvalvulas.com
www.avkvalvulas.com

AVK Magyarország Kft.

Váci str. 91. / A. building 2nd floor
1139 Budapest
Hungary
Tel: +36 30/987 14 75
tbed@avkgroup.com
www.avkvalves.hu

AVK International A/S

Bizonvej 1
Skovby
8464 Galten
Denmark

Tel.: +45 8754 2100
www.avkvalves.eu

2025.07.01
© 2025 AVK Group A/S - rev. 4

Expect... **AVR**