

Start Right Smart Guide – Single Family Unit

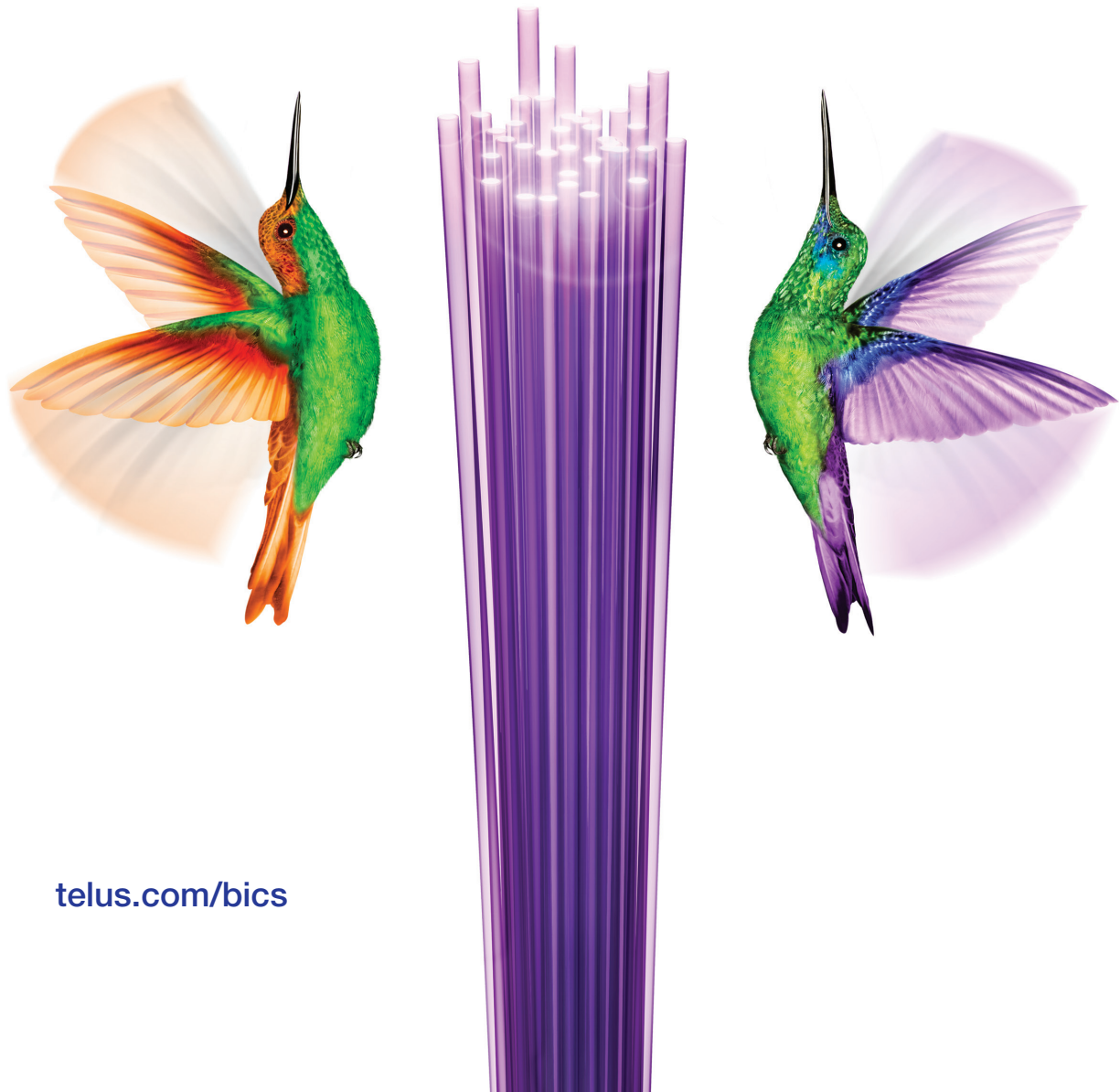

Single Family Unit (SFU) – Inside Wire Recommendations

Enclosure to Inside of Home - Typical Layout

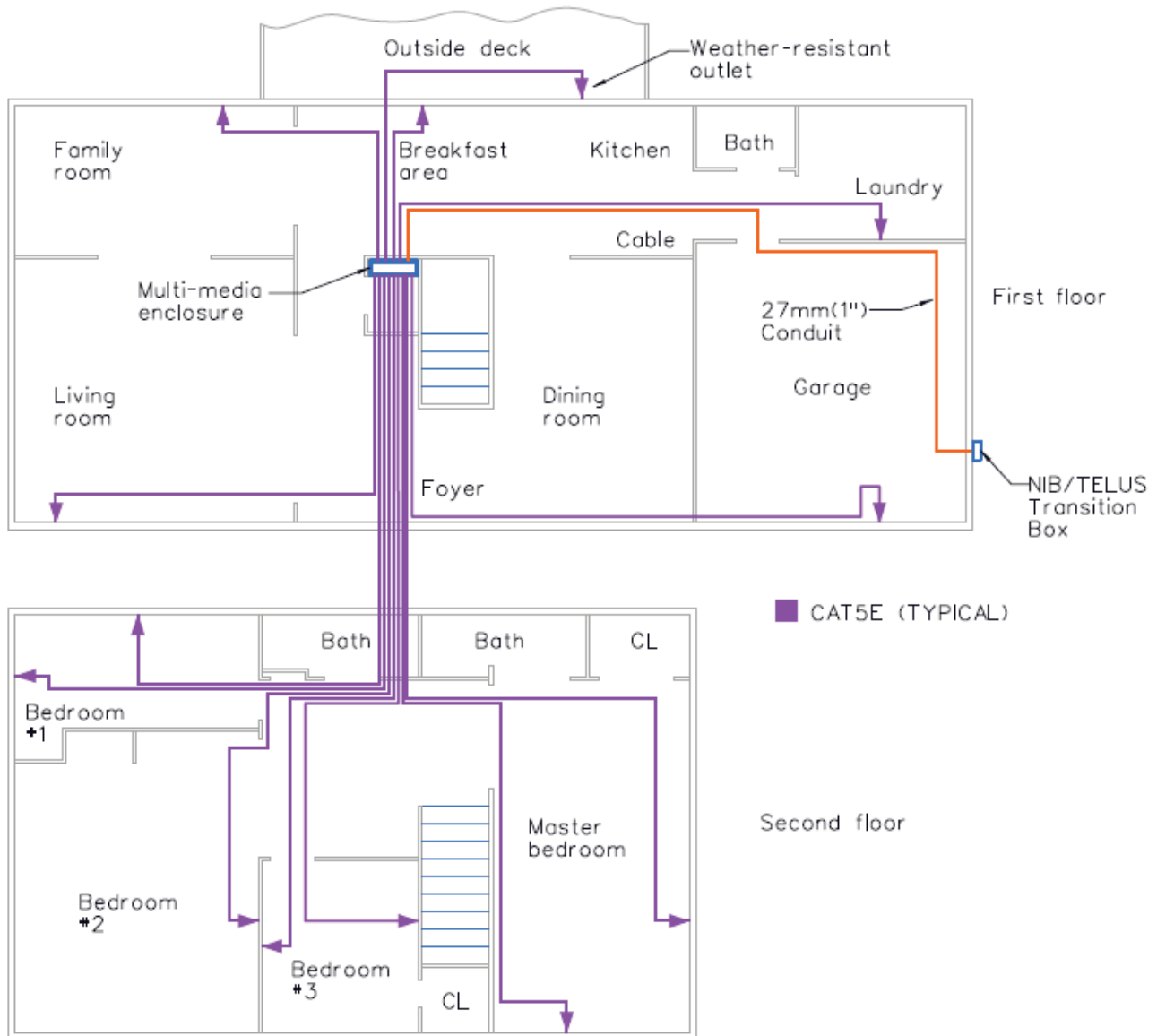

Single Family Unit – Inside Wire Recommendations

Enclosure to Inside of Home

1. The owner/builder is to provide and install a non-metallic Flexible or Rigid conduit (complete with a pull string) from the LB to the inside wire Star Configuration (Main Panel) inside the home. Conduit is the preferred option, and if conduit is not installed, additional services to the homeowner may not be possible.
2. **No Internal Conduit Pathway:** If the builder decides NOT to provide a non-metallic conduit between the LB and the central wiring location inside the home, pre-wire with 2 CAT5e cables and a single Bend Insensitive Fibre (BIF) (ITU-T-G657 compliant, indoor/outdoor rated) between the external LB and the inside wire Star Configuration inside the home, leaving 2 m (6' 6") of slack at each end.
3. When using rigid conduit, a maximum of four sweeping 90° bends for a total of 360° is allowable.
4. Extend the pull string from the 27 mm (1") conduit in the LB to the center of the Star Configuration inside the home. For CATV shared conduit, a 35 mm (1¼") conduit should be used.



- CAT5e Voice
- CAT5e Data
- CAT5e TV

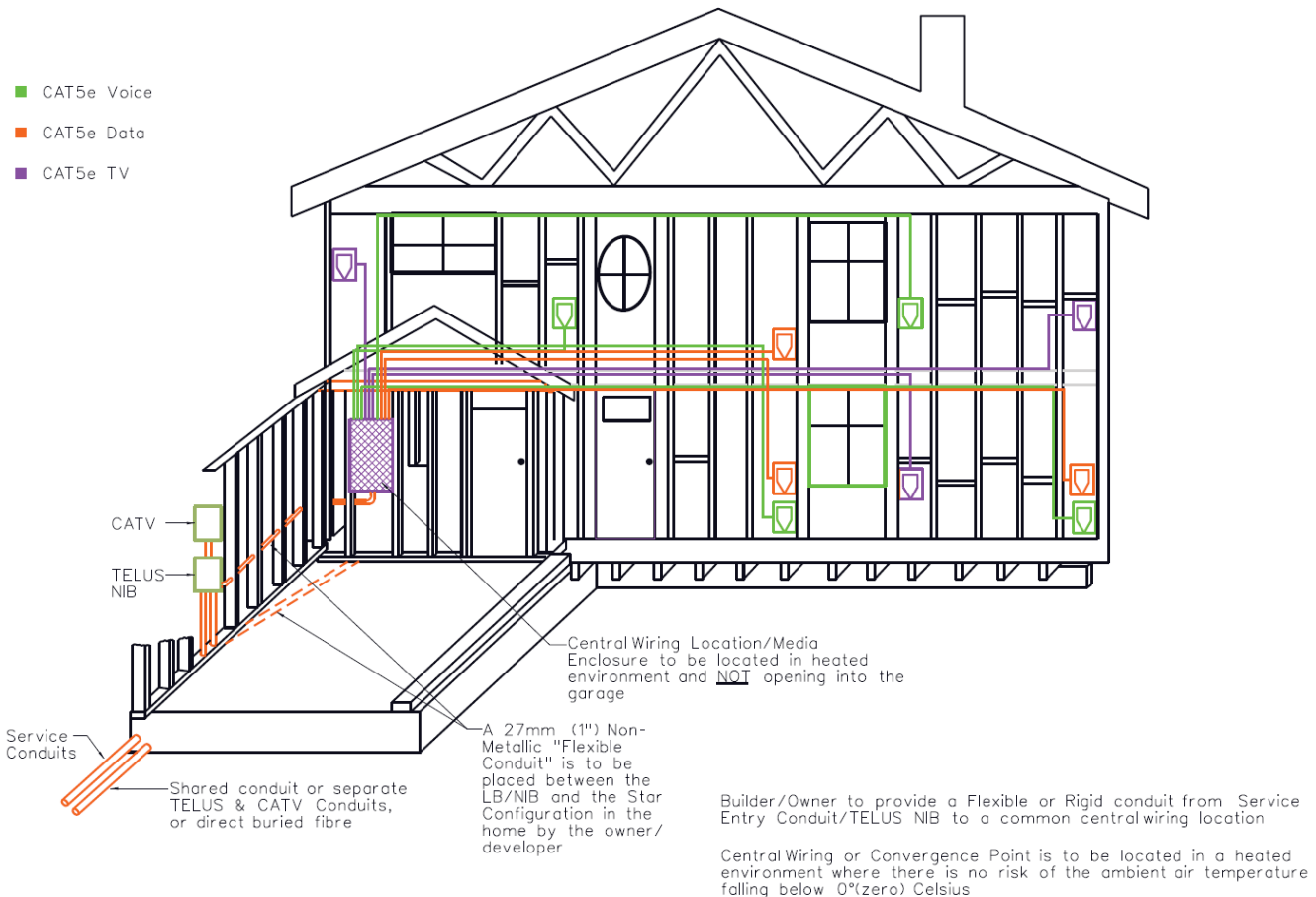

Single Family Unit – Inside Wire Recommendations

Pre-Wire and Panel/Backboard Area Central Wiring Requirements

1. The inside wiring should be done in a Star Configuration where the individual set runs of CAT5e cable run from each telephone, data and TV locations, and collect at a common location in the home. A separate run of CAT5e is required for each service at every location. The preferred location of the Star Configuration shall be on the adjoining wall where the external raceway enters the home.
2. The centre of the star is to be in a heated environment, where there is no risk of the ambient air temperature falling below 0° Celsius. A garage is NOT a suitable location.
3. Builder/owner will provide one (1) duplex 15A non-switched power receptacle dedicated to home networking, communication and entertainment equipment; installed in a multimedia enclosure at this location. The use of a multimedia enclosure or smart panel is preferred.
4. Owner/builder will provide wiring terminations strips for Voice/Data/Coax.
5. If a multimedia enclosure is not used, a wall space area of 600 mm X 900 mm (24" X 36") is required to accommodate all equipment along with one (1) duplex 15A non-switched power receptacle dedicated.

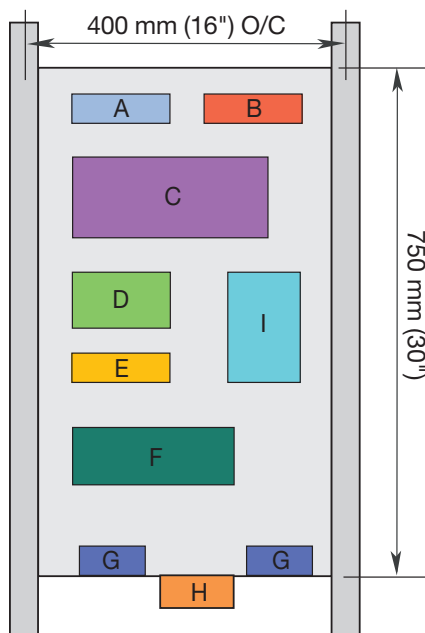

- A** Telephone Termination Strip Voice
- B** Data/IPTV Termination Strip
- C** Telco Equipment
- D** Fibre To The Home (FTTH)
- E** COAX Terminations
- F** CATV Equipment
- G** Power Adapters for Electronics
- H** 120VAC Inside Smart Panel
- I** UPS Power Supply

New Market Operations

4DEV@telus.com | 310-4DEV (4338)

You can reach us by email at 4DEV@telus.com or by phone at 310-4DEV (4338) 8:30 a.m. to 4:30 p.m. (PST) Monday through Friday. Please visit us at telus.com/bics for additional information.