

Harry Potter™

FAN CLUB

Hogwarts Castle Build

Part 2: The Grand Staircase Tower

To make the Grand Staircase Tower, you will need:



2 large pieces of flexible card



Lots of bits of cardboard



Strong tape



Scissors

These instructions feature the use of sharp tools so adults should always supervise children



Step by Step Instructions - Page 1

1.

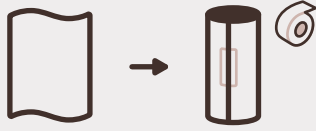

Take a big flexible piece of card of approximately **40cm x 45cm** and roll it into a cylinder. This will be your Grand Staircase Tower. Tape it in place.

2.

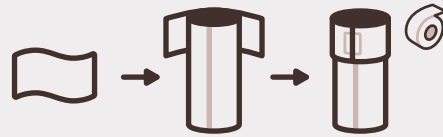

Take a thicker piece of cardboard measuring about **10cm by 45cm** and roll it around the top of the cylinder. Tape in place.

3.

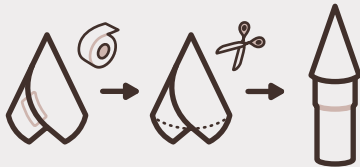

Take another piece of flexible card and roll it into a cone shape. Tape in place and trim off the excess card. Place it on top of the tower.

4.

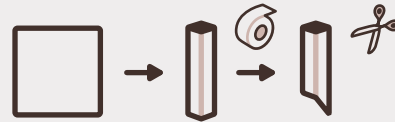

To make the three turrets for the Headmaster's Tower, we need a base for them to sit on. Cut a small piece of cardboard of about **5x5cm** and bend it into a rectangular tube and tape in place. Cut across the bottom at a slant so that it can sit against the roof of the tower.

5.

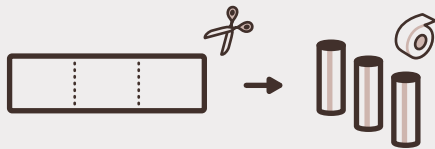

Take a piece of flexible card and cut it into three pieces about **4cm** long. Roll them into tubes and tape into place.

6.



Just as with the Grand Staircase Tower, make three little cone roofs to go on top of the cylinders.

7.



Tape the three cylinders together, placing each one **1cm** below the one to the left.

8.

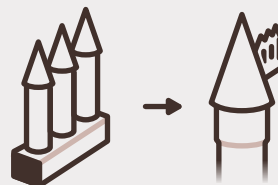

Attach the three cylinders to the base and attach all the pieces to the side of the Grand Staircase Tower roof.

Step by Step Instructions - Page 2

9.

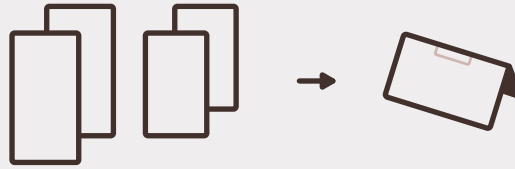

To create a corridor to connect the Great Hall to the Grand Staircase Tower, cut two pieces of cardboard for the walls and two for the roof. Tape the two roof pieces together.

10.

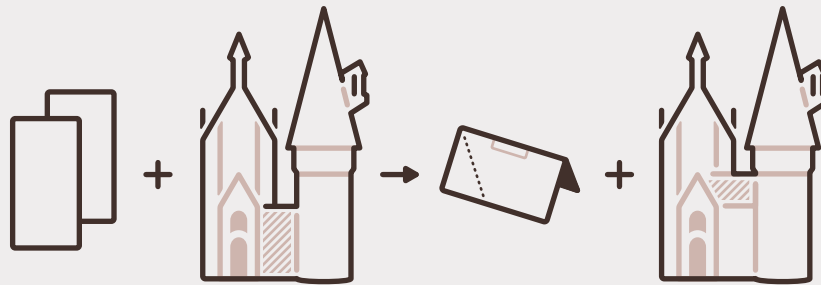

Tape the walls between the right side of the Entrance Hall and the Grand Staircase Tower. Attach the roof to the top of the walls between the two buildings. You may need to cut the side of the roof to fit the angle of the Entrance Hall roof.



**You have now finished
the second part of the build!**

Next part: Paper Mache and Paint