

- RUNWAY STRIP 2588m (8491') x 300m (984')
- RUNWAY ASPHALT 2438m (7999') x 45m (147')
- CLEARWAY 60m (197') x 180m (590')

### GENERAL NOTES

- HORIZONTAL DIMENSIONS IN METRES (FEET), ELEVATIONS IN FEET (METRES), CONTOUR VALUES SHOWN IN METRES
- HORIZONTAL DATUM - MAPPING GRID OF AUSTRALIA (MGA94) VERTICAL DATUM - AUSTRALIAN HEIGHT DATUM (AHD). NOTE: M.G.A. 94 IS A STANDARD MAPPING PROJECTION (UTM) OF THE WGS84 SPHEROID LATITUDES AND LONGITUDES.
- NOTE: AUSTRALIAN HEIGHT DATUM (AHD) SHOULD BE CONSIDERED TO BE EQUIVALENT TO MEAN SEA LEVEL (MSL) FOR PRACTICAL BAROMETRIC HEIGHTING.
- AERODROME OBSTACLE CHART ICAO ANNEX 4 TYPE A (OPERATING LIMITATIONS) IS TO BE READ IN CONJUNCTION WITH CURRENT NOTAMS.
- FOR AERODROME AND OBSTRUCTION DATA REFER TO ASSOCIATED OBSTACLE DATA SHEETS
- THIS CHART IDENTIFIES OBSTACLES NOT SHIELDED BY OTHERS, AND IS IN ACCORDANCE WITH AERONAUTICAL CHARTS, ANNEX 4, CHAPTER 3: AERODROME OBSTACLE CHART - ICAO TYPE A (OPERATING LIMITATIONS), PARAGRAPH 3.8.1.1 & 3.8.1.2.
- THE NUMBERS IDENTIFYING OBSTACLES ON THIS CHART ARE ONLY APPLICABLE TO THIS EDITION AND SHOULD **NOT** BE USED FOR FUTURE OR PREVIOUS CHART EDITIONS.
- TAKE OFF SURFACE GRADIENT ORIGINATES FROM END OF CLEARWAY (TODA).
- OBSTACLE SURVEYS BY LANDPARTNERS LTD, ON BEHALF OF THE SYDNEY AIRPORT CORPORATION LTD, NOVEMBER, 2018 TO JANUARY, 2019.
- RESPONSIBILITY FOR THE ISSUE, AMENDMENT AND NOTIFICATION OF CHANGES TO THIS CHART RESTS SOLELY WITH THE SYDNEY AIRPORT CORPORATION LTD.
- USERS OF THIS CHART SHOULD NOTIFY ANY ERRORS OR OMISSIONS AS SOON AS THEY BECOME APPARENT TO:-  
SYDNEY AIRPORT CORPORATION LTD  
LOCKED BAG 5000  
SYDNEY INTERNATIONAL AIRPORT NSW 2020  
AUSTRALIA  
ATTENTION: SPATIAL INFORMATION SERVICES MANAGER  
Ph. +61-2-9667 9231 Fax. +61-2-8338 4994  
EMAIL: geoff.stevenson@syd.com.au
- FOR FURTHER INFORMATION REGARDING THIS CHART CONTACT THE ABOVE ADDRESS

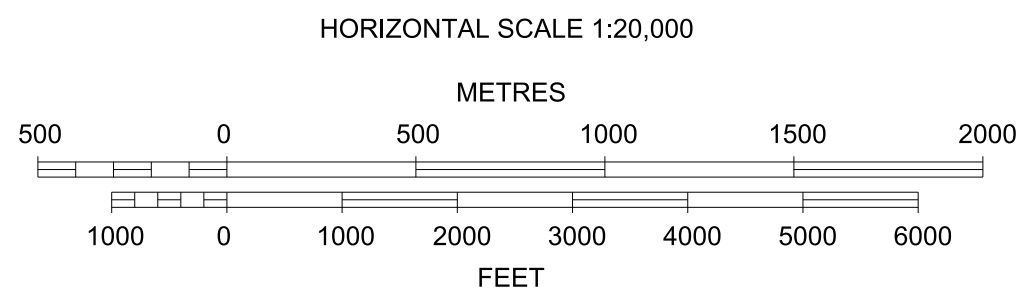

### LEGEND

OBSTRUCTIONS AND OBSTACLES:	PLAN	PROFILE
CHART NUMBER (SIGNIFICANT OBSTACLES)	(15)	(15)
TOP ELEVATION IN FEET	126'	
TREE(S) OR SHRUB(S)	*	T
BUILDING OR LARGE STRUCTURE	□	T
POLE, TOWER, SPIRE ETC.	○	T
ANTENNA	△	T
TRANSIENT (ROADS, RAILWAY TRACKS ETC)	=	T
TERRAIN PENETRATING LOWEST SURVEYED SLOPE	○	T
SPOT HEIGHT	●	T
LINE (ASSOCIATED WITH ANY LINE SHOWN AS A GEOGRAPHICAL FEATURE)	—	T

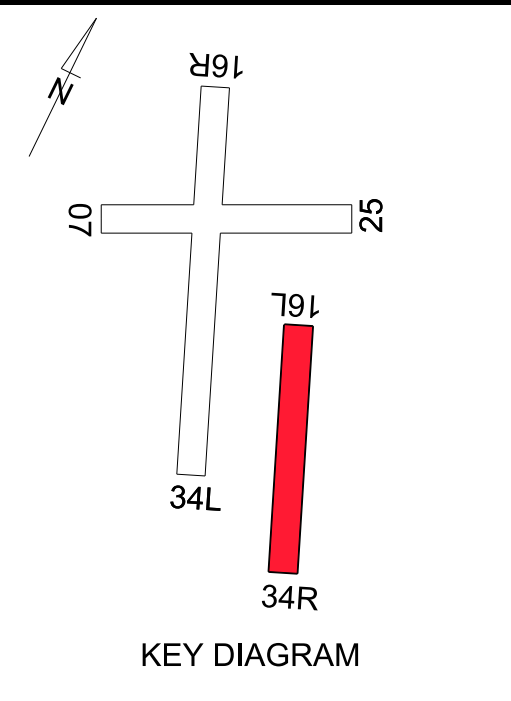

DECLARED DISTANCES (ERSA)	RWY34R
TAKE-OFF RUN AVAILABLE (TORA)	2438m (7999')
TAKE-OFF DISTANCE AVAILABLE (TODA)	2498m (8195')
ACCELERATE-STOP DISTANCE AVAILABLE (ASDA)	2438m (7999')
LANDING DISTANCE AVAILABLE (LDA)	2400m (7874')

SYDNEY (KS) AIRPORT, AUSTRALIA  
AERONAUTICAL INFORMATION PUBLICATION  
AERODROME OBSTACLE CHART  
SYDNEY (KS) AIRPORT ICAO ANNEX 4 TYPE A (OPERATING LIMITATIONS)  
RUNWAY 34R, 25TH EDITION - MARCH 2019

C29570	MATC	GWS	2018 Obstacle Survey Update		GWS	Mar. 2019	25	THIS DOCUMENT IS THE PROPERTY OF THE SYDNEY AIRPORT CORPORATION LTD, AND <b>COPYRIGHT</b> AND INFORMATION CONTAINED IN IT VESTS IN THE SYDNEY AIRPORT CORPORATION LTD. THE INFORMATION IS PROVIDED FOR THE USE OF THE PARTY TO WHOM THIS DOCUMENT MAY BE TRANSMITTED TO ANY THIRD PARTY WITHOUT THE PRIOR WRITTEN AUTHORISATION OF THE CORPORATION.	SCALE	1 : 20,000	
C28649	MATC	GWS	2017 Obstacle Survey Update		GWS	April 2018	24		DRAWING No.	FSS 7130	
C27375	MATC	GWS	2016 Obstacle Survey Update		GWS	April 2017	23				
C28229	MATC	GWS	2015 Obstacle Survey Update		GWS	April 2016	22		SHEET	8	A1
C25125	MATC	GWS	2014 Obstacle Survey Update		GWS	May 2015	21				
C23885	MATC	GWS	2013 Obstacle Survey Update		GWS	Mar. 2014	20				
JOB No	DRAWN	CHKD	AMENDMENTS		EXAMD	APPD	DATE	No.			