



415 Mission Street

Salesforce Tower

Space
availability
summary

WeWork @ 415 Mission Street
San Francisco, CA

wework

[VIEW VIRTUAL TOUR](#)

38th Floor 31,756 RSF
37th Floor 21,729 RSF
36th Floor 28,176 RSF

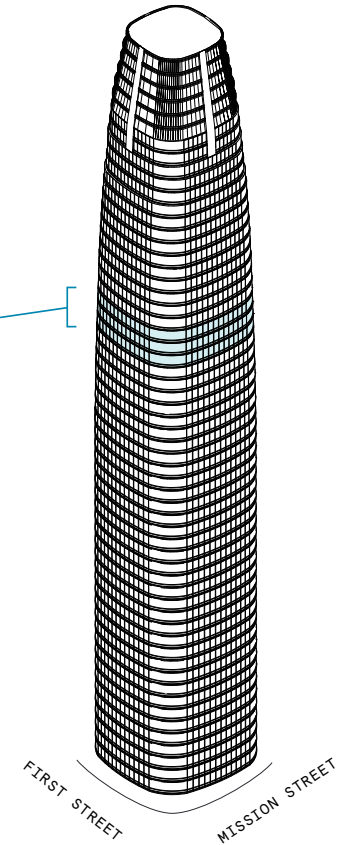
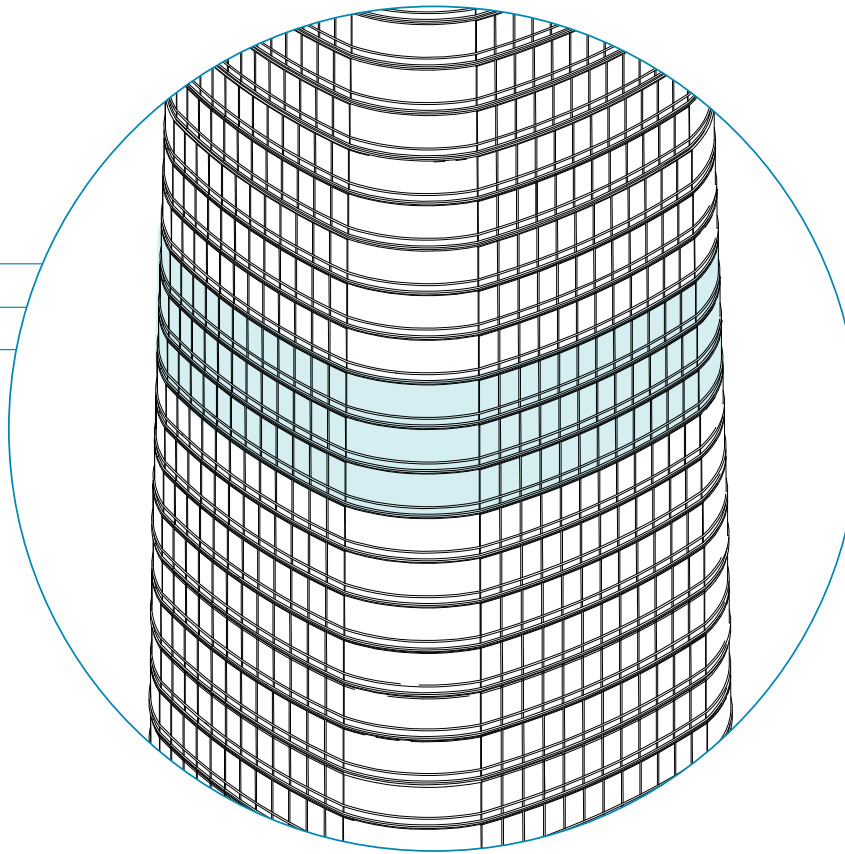

76,401 RSF

TOTAL WEWORK RSF

415 Mission Street

At a glance

Workspaces designed for productivity and creativity with flexible size & term

Dedicated, private suites available from 107 to 14,341 RSF

Move-in ready suites furnished & wired

61

TOTAL BUILDING FLOORS

1,420,682

TOTAL BUILDING SQ FT

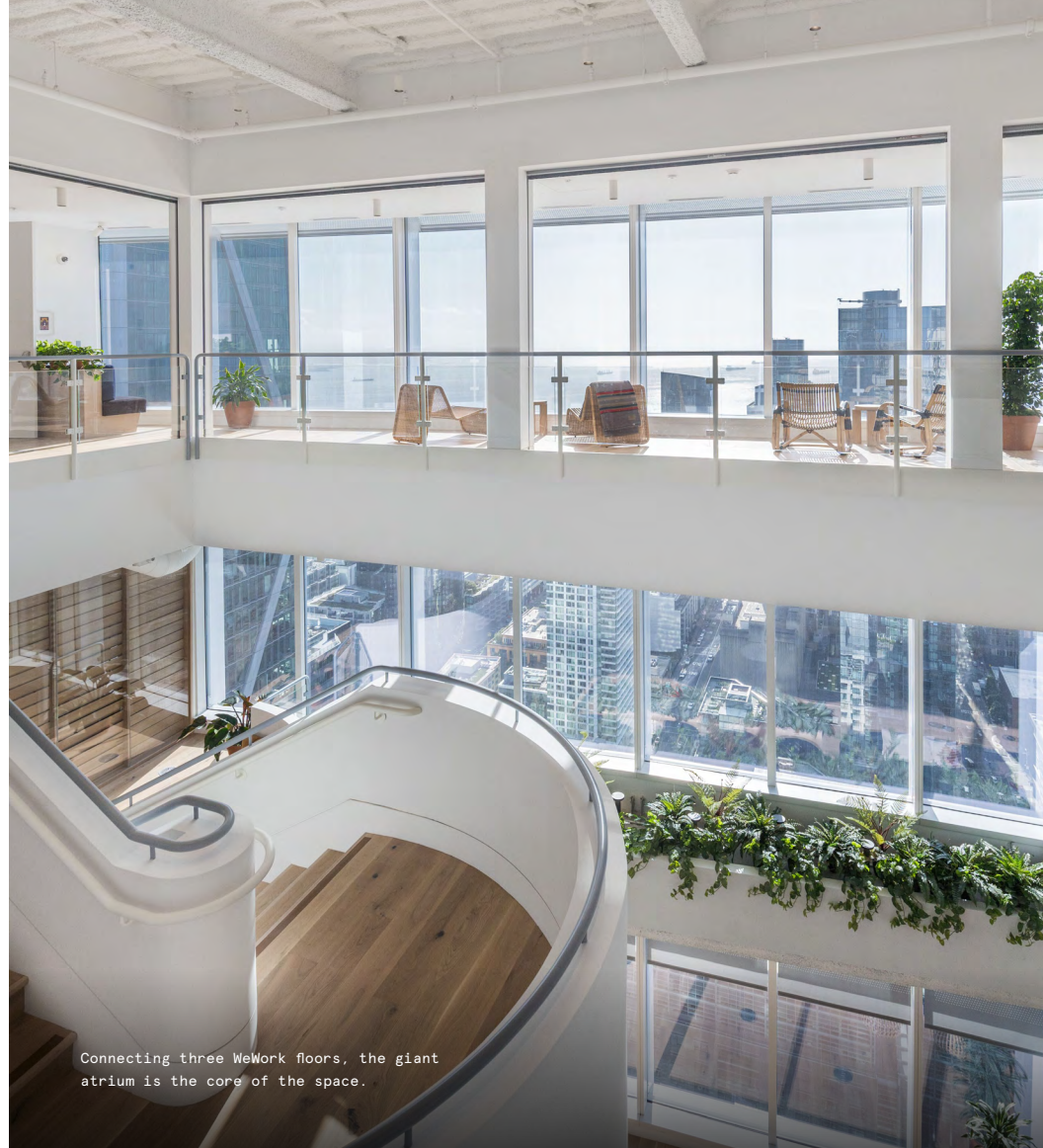

Central, grand, and scenic

Designed by influential architect César Pelli, the Salesforce Tower stands out as one of San Francisco's most iconic buildings and exceptional properties on Mission Street, within the trendy SoMa locale. Connected through its grand atrium, WeWork occupies three expansive floors of the 61-story tower. Also known as the tallest building in the city at 1,070 feet, the glass tower with pearlescent metal details has the form of an obelisk, presenting a curved, conical outline with 360-degree views of the San Francisco Bay. Labeled as a Class A, Energy Star compliant property, it has also achieved Pre-Certified Platinum, LEED Certified Gold Core, and Shell Certified qualifications.

Promoting connectivity throughout a modern, light-filled space

Reflecting a flexible design ethos, 415 Mission Street provides multiple ways to experience the views and outdoors, alongside amenities and workspaces.

- The structure's original exposed concrete walls and glass features are celebrated with honest materials and a neutral color scheme
- 415 Mission Street's floor-to-ceiling windows and remarkably high ceilings further emphasize the natural daylight and airy atmosphere inside, accented with bold, scattered murals, and installations by local artists
- The location features a striking atrium with stadium seating that punches through all three WeWork floors, creating a central space for educational programs, cultural moments, and other activities

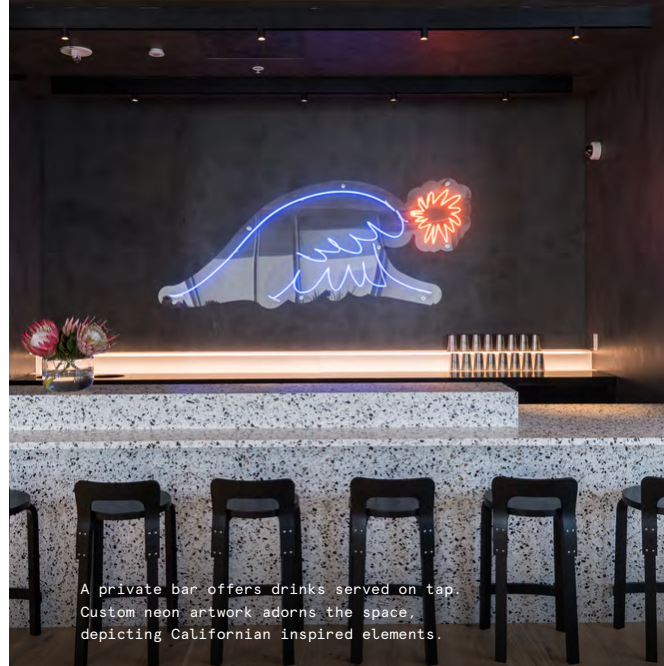

A private bar offers drinks served on tap. Custom neon artwork adorns the space, depicting Californian inspired elements.



Surrounded by floor-to-ceiling windows, abundant natural light envelopes the private kitchen space.



Allowing an open flow between spaces, interiors feature several immaculate meeting and conference areas.

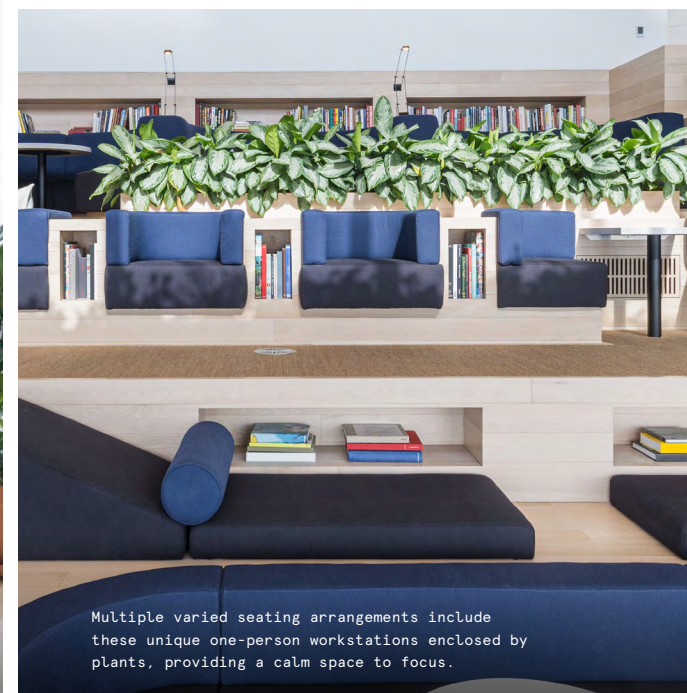

Multiple varied seating arrangements include these unique one-person workstations enclosed by plants, providing a calm space to focus.



On-site amenities

- High speed Wi-Fi
- Meeting rooms
- On-site staff

- Unique common areas
- Phone booths
- Stocked kitchens

- Fiction Coffee Espresso Bar
- Business-class printers
- Professional and social events

Building specifications



Building history

Built in 2017

Designed by Pelli Clarke
Pelli Architects



Security

24/7 attended lobby

24/7 CCTV monitoring



Certifications

LEED Platinum



Building size

61 stories

1.4 million RSF



Elevators

6 passenger elevators with a
capacity of 4,000lbs

2 freight elevators with a
capacity of 4,000lbs



Electrical capacity

36th: 507A

37-38th: 900A



Ceiling heights

14'9" slab-to-slab



HVAC













Cooling: Under floor air distribution
and overhead perimeter VAV

Heating: Heating air is provided to
the perimeter zones of the building
via overhead ductwork

Set in the central, desirable SoMa district

Located at the epicenter of San Francisco's increasingly in-demand SoMa neighborhood, 415 Mission Street is set near the city's major transportation hubs. With Salesforce Transit Center at its base, the building is just a few blocks away from the BART, Muni, and the Ferry Building. Set in a lively, accessible district, the office space is within walking distance to many hot spots in the city, including the commercial complex of Embarcadero Center, Michelin-star restaurants, casual lunch stops, cocktail bars, retail stores, museums, art galleries, and parks for much-needed breaks in nature.

Distance to WeWork

San Francisco International Airport	 Driving	23 min	 Train	36 min
Oakland Airport	 Driving	23 min	 Train	41 min
Transbay			 Walking	2 min
Embarcadero			 Walking	10 min
Civic Center/UN Plaza			 Train	10 min
19th Street / Oakland			 Train	16 min
Macarthur			 Train	19 min
Balboa Park			 Train	27 min
Coliseum			 Train	31 min
Bay Fair			 Train	33 min



36th Floor

28,176 RSF

8

MEETING ROOMS

1

COMMON SPACE(S)

LEGEND

- CONFERENCE ROOMS
- OPEN WORKSPACE
- DEDICATED SPACE

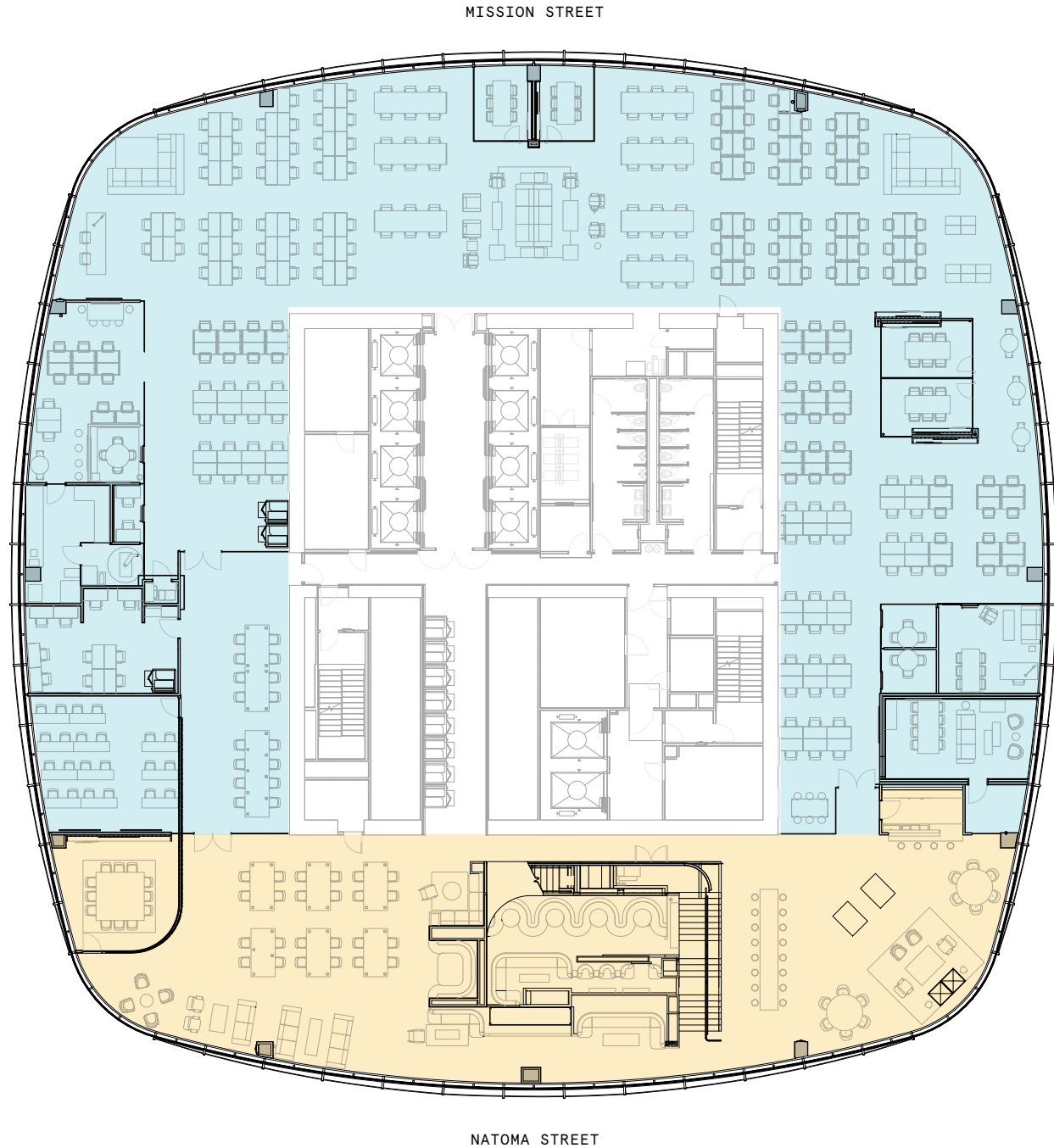
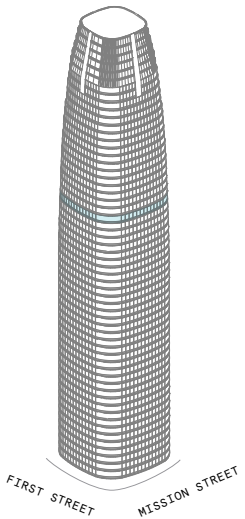

Suite 101

36th Floor

7

PRIVATE ROOM(S)

4,132 RSF

RENTABLE AREA

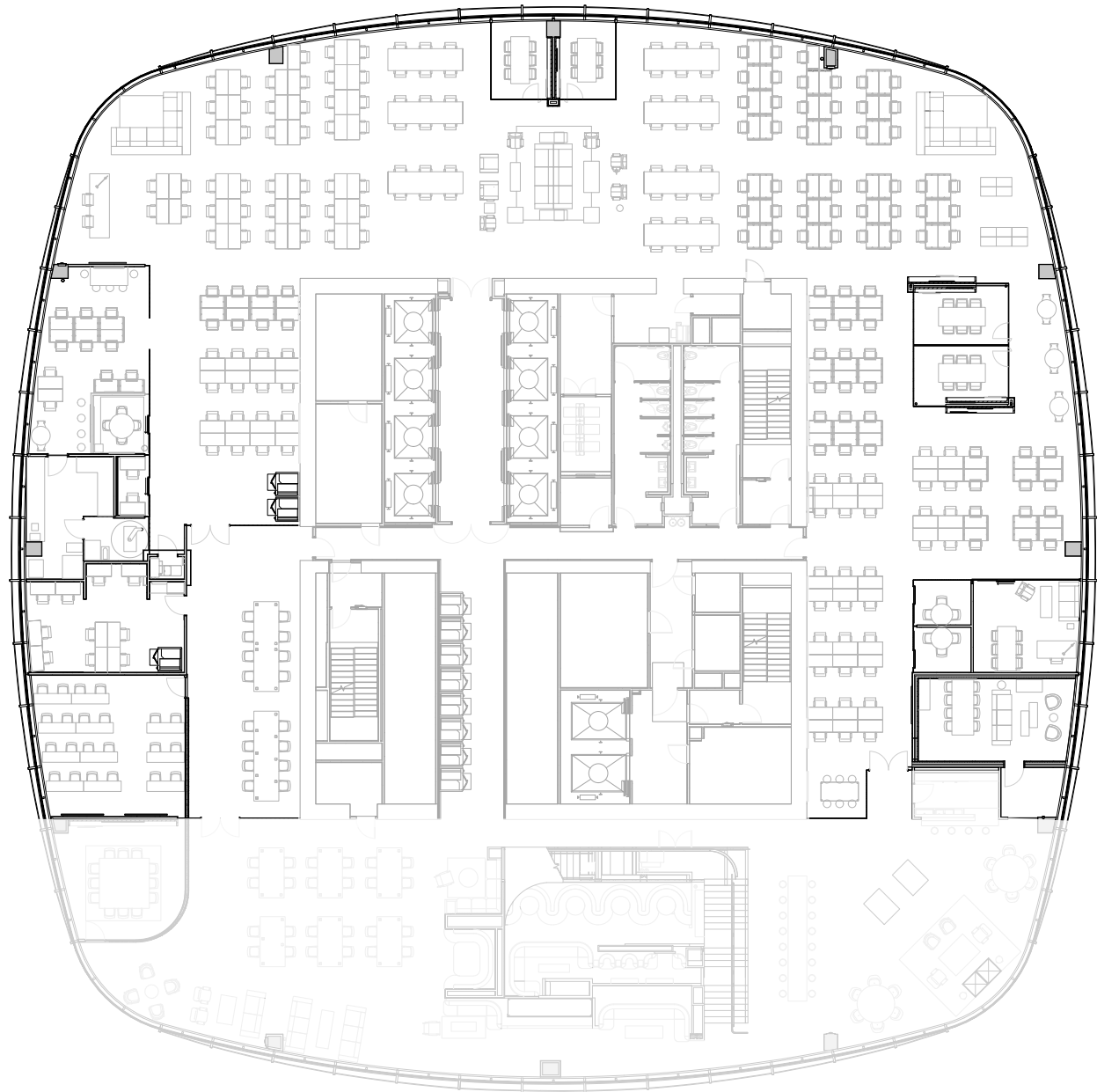
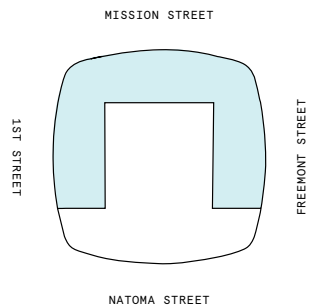

37th Floor

21,729 RSF

10
MEETING ROOMS

1
COMMON SPACE(S)

LEGEND

- CONFERENCE ROOMS
- OPEN WORKSPACE
- DEDICATED SPACE

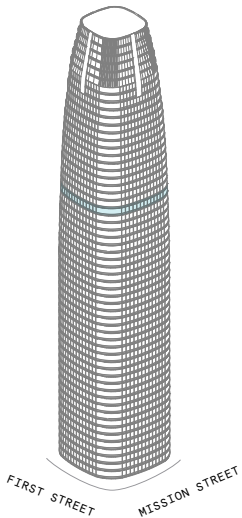

1ST STREET

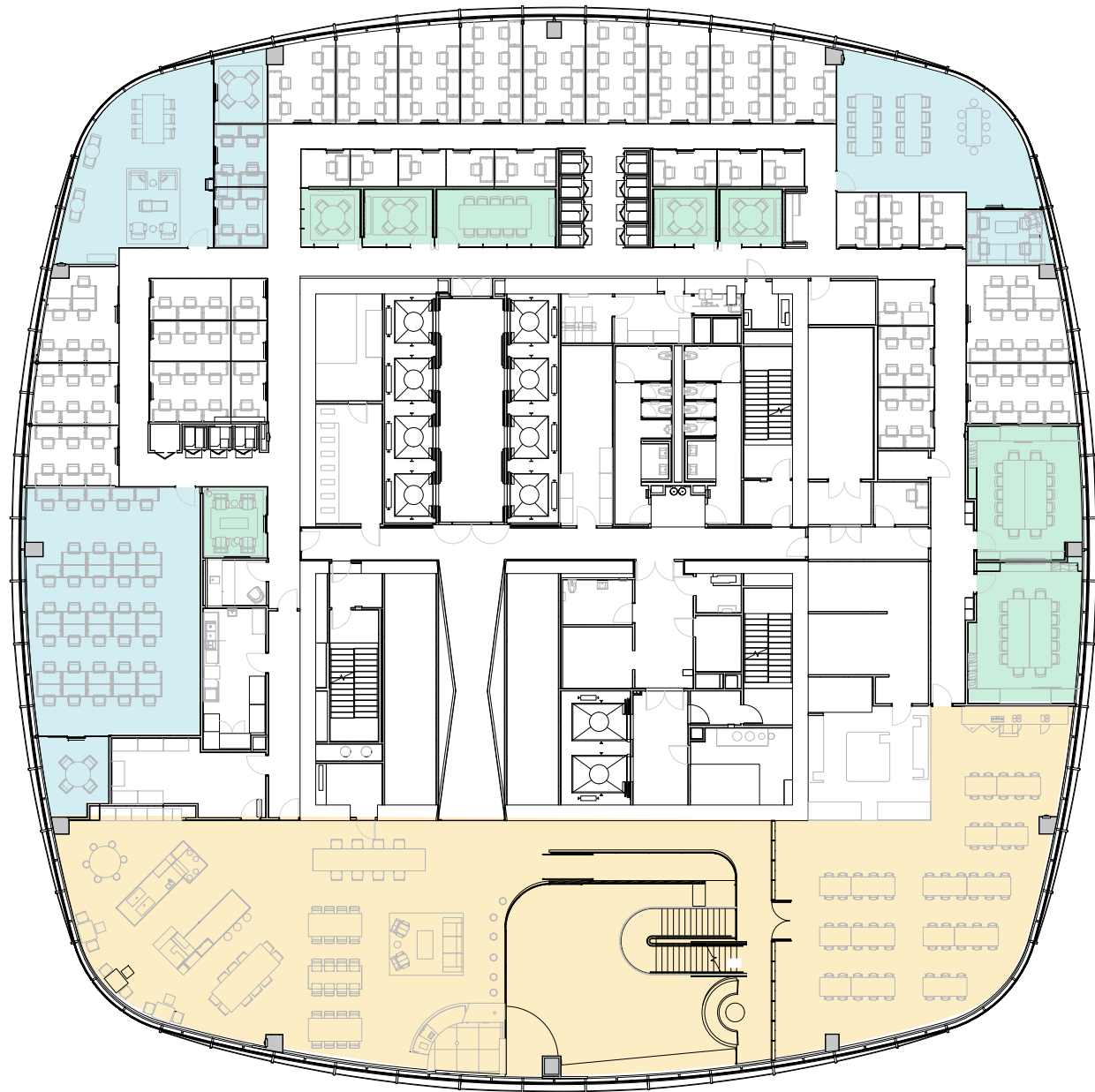

MISSION STREET



FREMONT STREET

NATOMA STREET

Suite 101

37th Floor

1

PRIVATE ROOM(S)

4,380 RSF

RENTABLE AREA

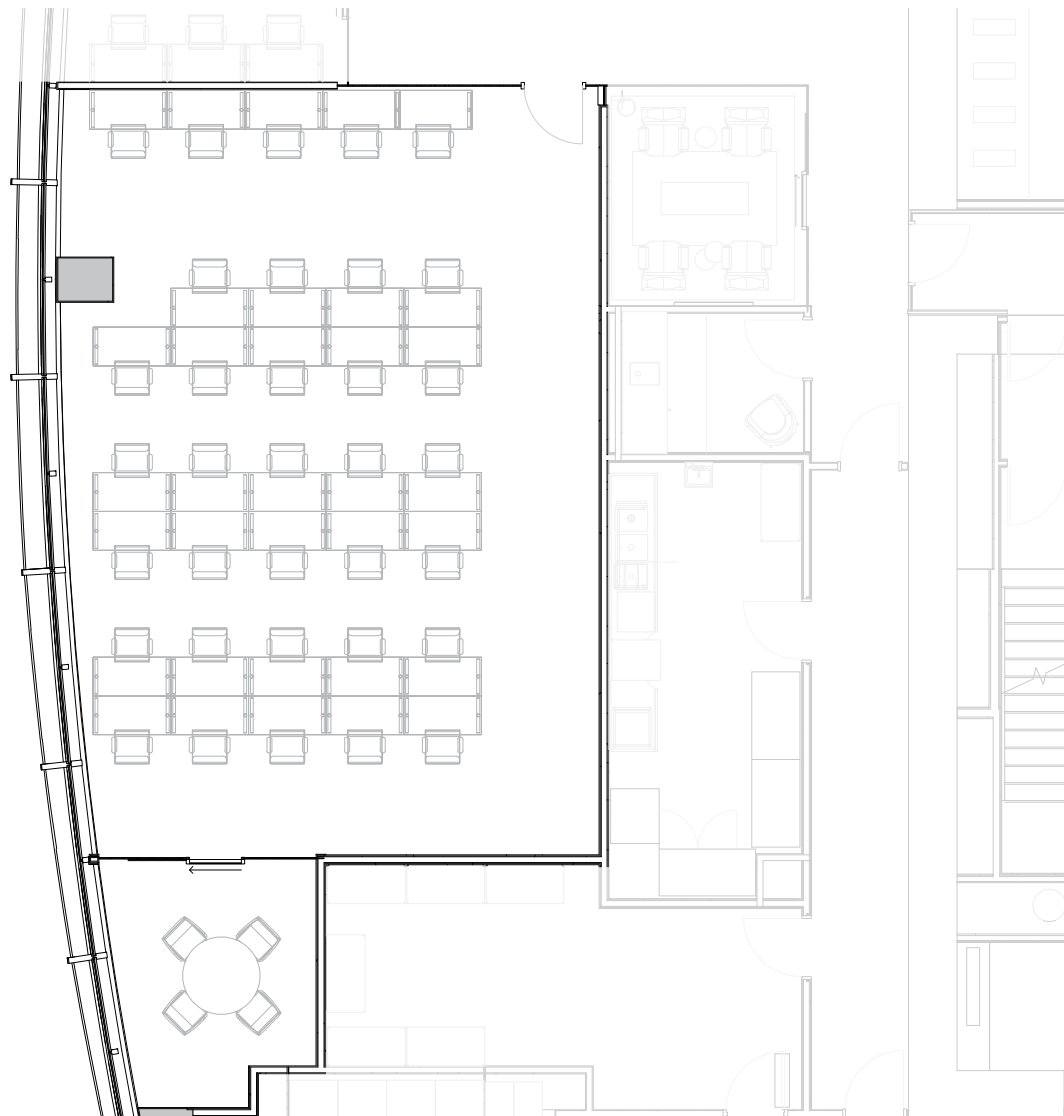
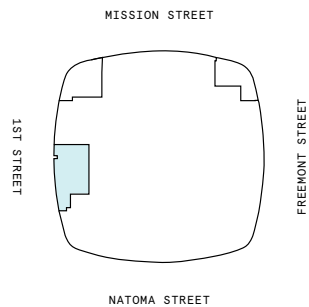

Suite 108

37th Floor

3

PRIVATE ROOM(S)

3,038 RSF

RENTABLE AREA

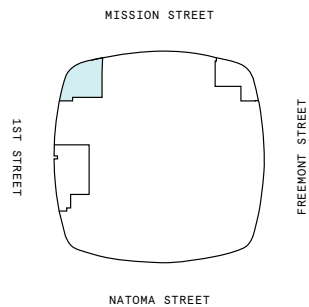

Suite 129

37th Floor

1

PRIVATE ROOM(S)

2,501 RSF

RENTABLE AREA

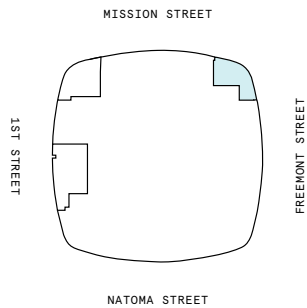

38th Floor

31,756 RSF

11
MEETING ROOMS

1
COMMON SPACE(S)

LEGEND

- CONFERENCE ROOMS
- OPEN WORKSPACE
- DEDICATED SPACE

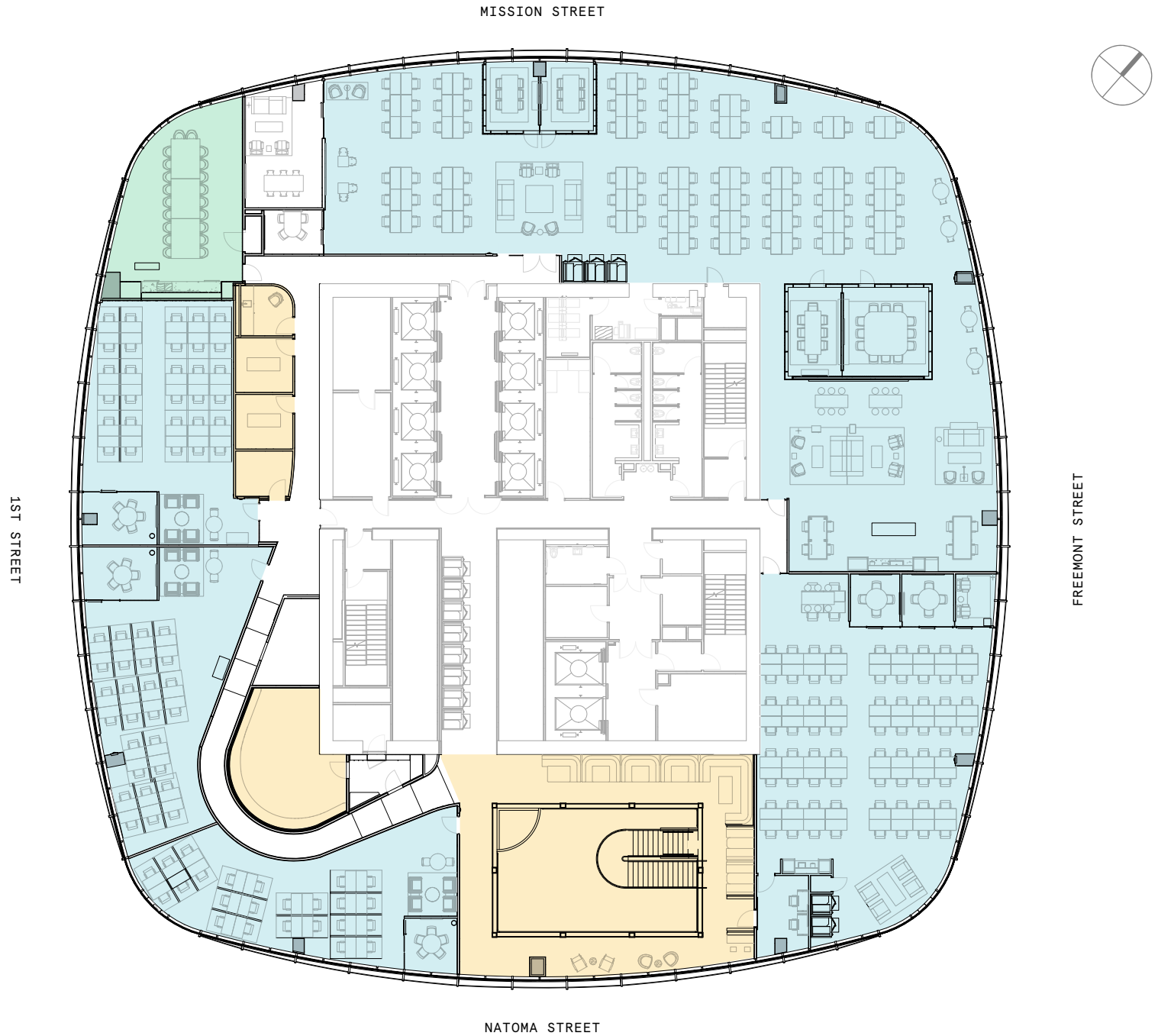
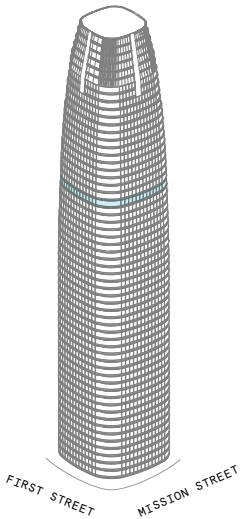

Suite 101

38th Floor

5

PRIVATE ROOM(S)

13,695 RSF

RENTABLE AREA

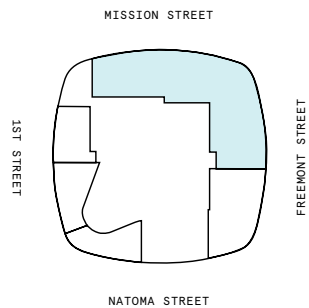

Suite 102

38th Floor

3

PRIVATE ROOM(S)

5,260 RSF

RENTABLE AREA

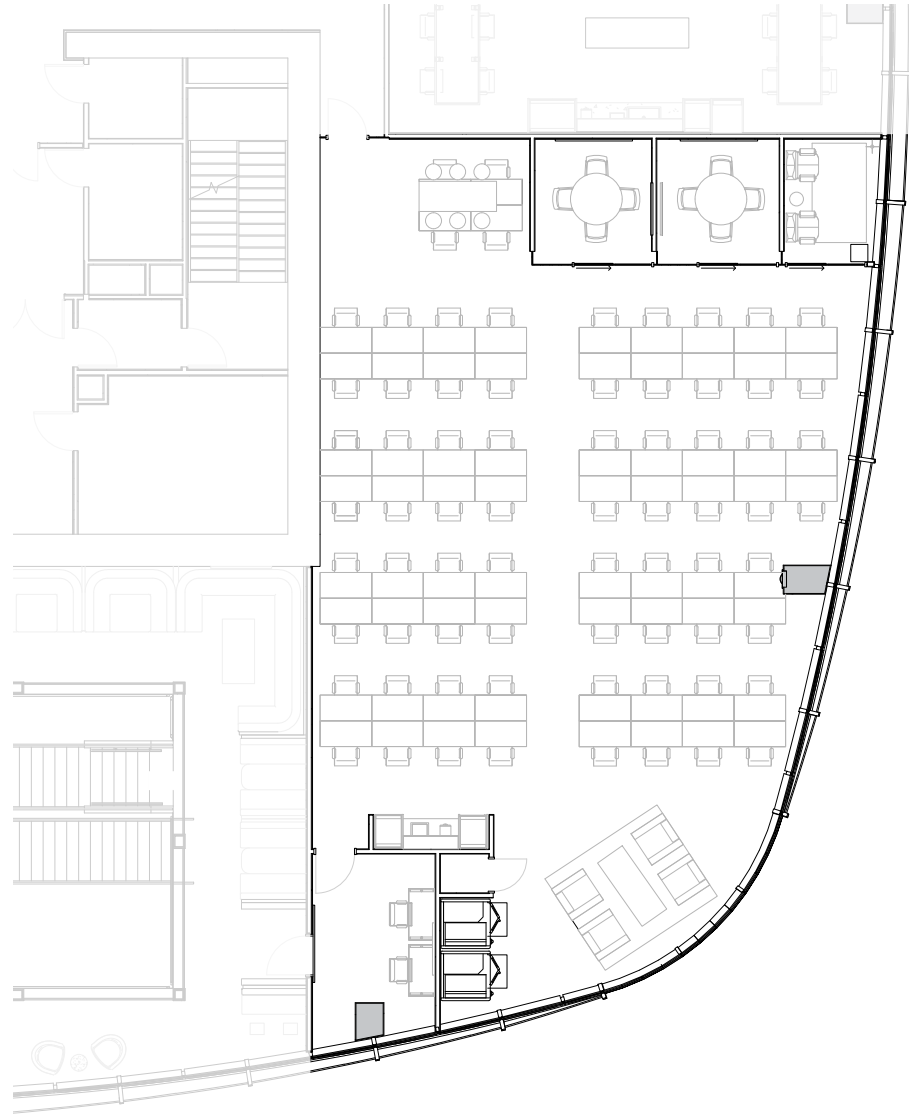
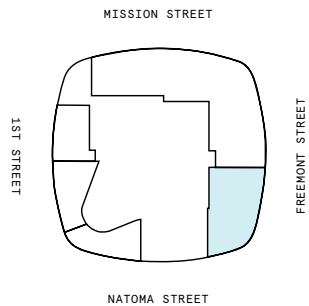

Suite 104

38th Floor

1
PRIVATE ROOM(S)

2,453 RSF
RENTABLE AREA

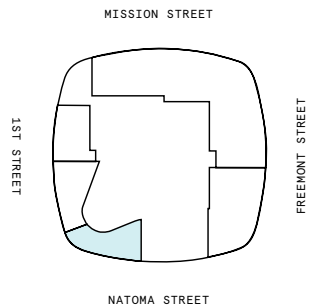

Suite 105

38th Floor

1
PRIVATE ROOM(S)

2,587 RSF
RENTABLE AREA

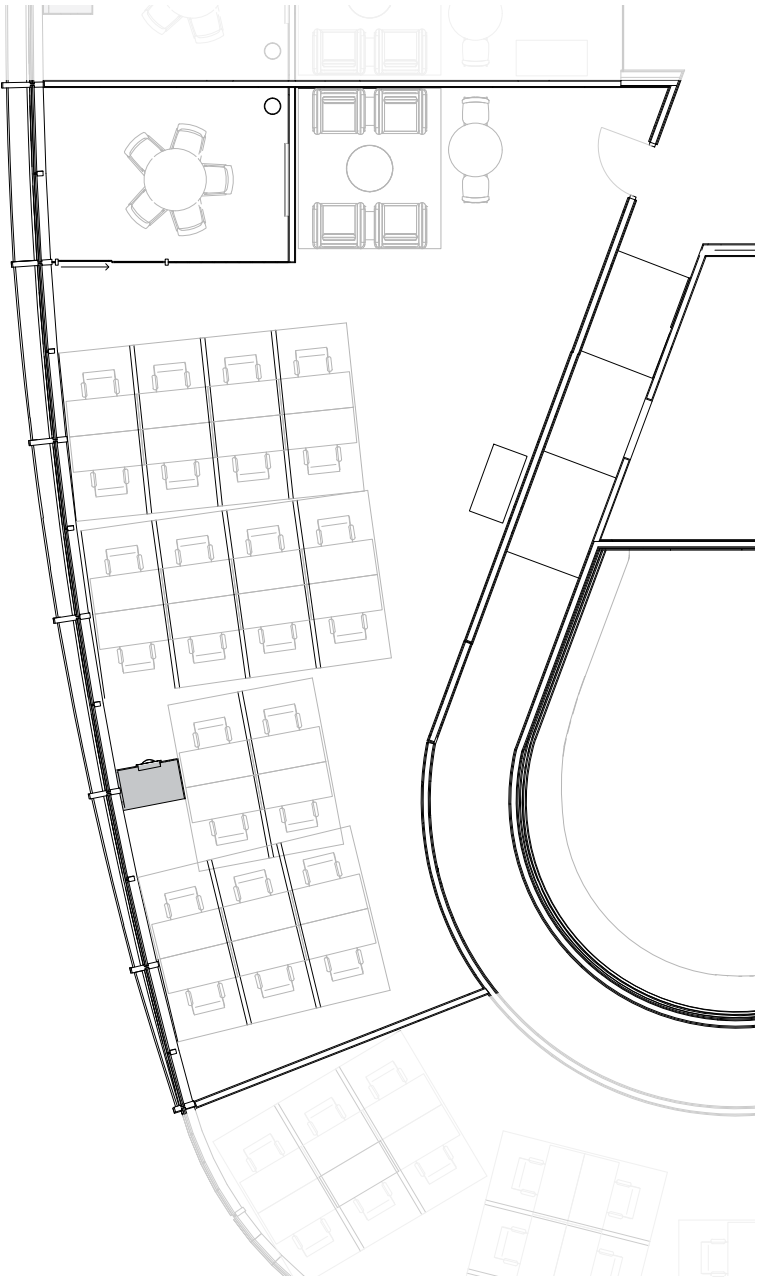
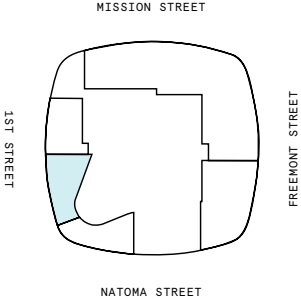

Suite 106

38th Floor

1

PRIVATE ROOM(S)

2,502 RSF

RENTABLE AREA

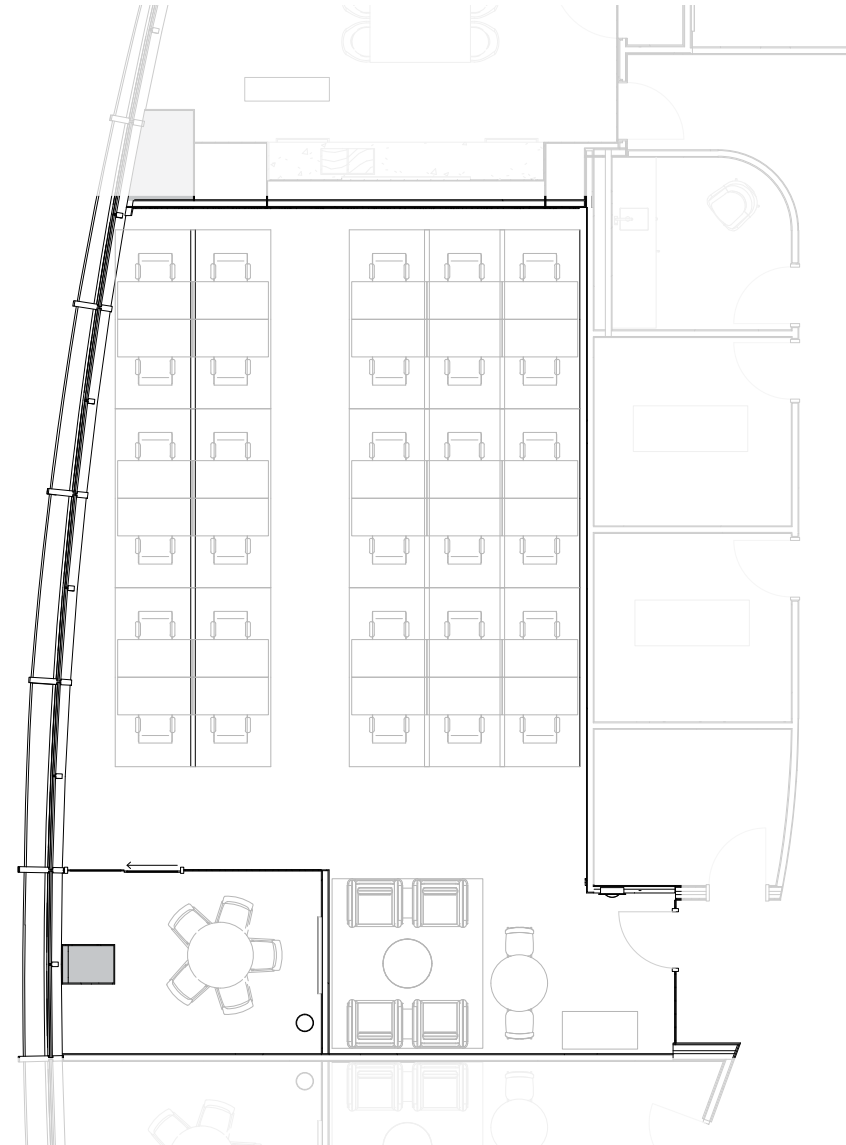
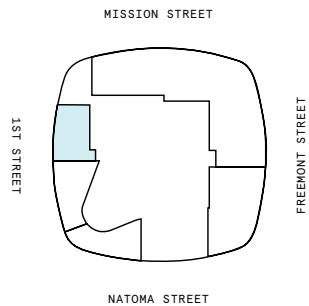

Contact

For leasing inquiries please reach out to our team.



Chris Paxton

LEASING DIRECTOR
CHRIS.PAXTON@WEWORK.COM