

## WARNINGS



### AMBIENT CONDITIONS

Do not store the device in humid surroundings. Do not place the device where it may come in contact with liquids. Do not expose the device to any heat sources. Do not charge, operate, or store the device at high temperatures. Comply with the specified operating and storage conditions.



### ELECTRIC SHOCK HAZARD

Ultradent BFC3 Powered Impression Gun is an electric device designed to meet worldwide safety standards. To avoid electric shock:

- Do not attempt to open or alter the unit in any way. Any attempt to open the unit will invalidate the warranty. Only the service centers authorized by Practicon can open the unit housing and repair the device.
- Do not put any foreign objects into the housing of the unit.



### BATTERY

Do not store at temperatures above 104°F (40°C). If unit is stored six months or longer, recharge battery fully before using.



### DISPOSAL

For environmental reasons, please dispose of unit according to local environmental guidelines or regulations regarding lithium-ion batteries. Do not dispose of unit in fire.



### REPAIRS AND DEFECTS

Do not use the device if you suspect it is damaged or defective. If batteries are defective, do not transport the device by air under any circumstances.

## Warranty

Ultradent warrants this product to be free of manufacturing defects for a period of one (1) year from the date of purchase, deemed as the date of the invoice. Units returned due to manufacturing defects within the warranty period will be repaired or replaced at our discretion. The following are expressly excluded from the warranty:

- Damage and/or failure of the equipment caused by dropping and/or jolting during handling after purchase and/or during normal use.
- Damage and/or failure of the equipment caused by natural disasters, such as earthquakes, floods, lightning, pollution, incorrect electrical voltage, and voltage spikes.

IMPROPER USE OR ANY ATTEMPT TO OPEN THE UNIT WILL INVALIDATE THE WARRANTY.

### PURCHASE INFORMATION

Record information about your Ultradent BFC3 Powered Impression Gun purchase in the space below.

Serial Number \_\_\_\_\_

Date of Invoice \_\_\_\_\_

### REPLACEMENT PARTS

Only use original Ultradent components/accessories.

Item Number	Description	Qty/Unit
5568	Plunger Set	1 ea 50 ml and 75 ml
5569	Battery Charger	1 ea

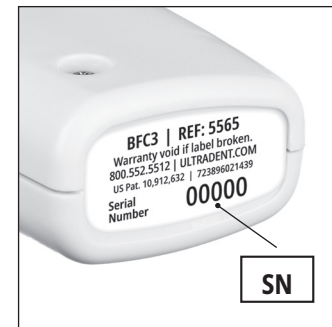

# Ultradent™ BFC3™ Powered Impression Gun

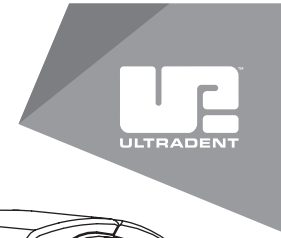

## Instructions for Use

Thank you for purchasing the **Ultradent BFC3 (Better Faster Comfort, Control, Compatibility) Powered Impression Gun**, the first cordless, handheld, motorized impression gun that dispenses standard 25 ml, 50 ml, and 75 ml 1:1 or 2:1 automix cartridges. With proper use and care, the BFC3 impression gun will make your procedures faster and easier than ever.



Please read and understand all instructions before using this device, and save this manual for your reference. This manual is subject to change without notice.

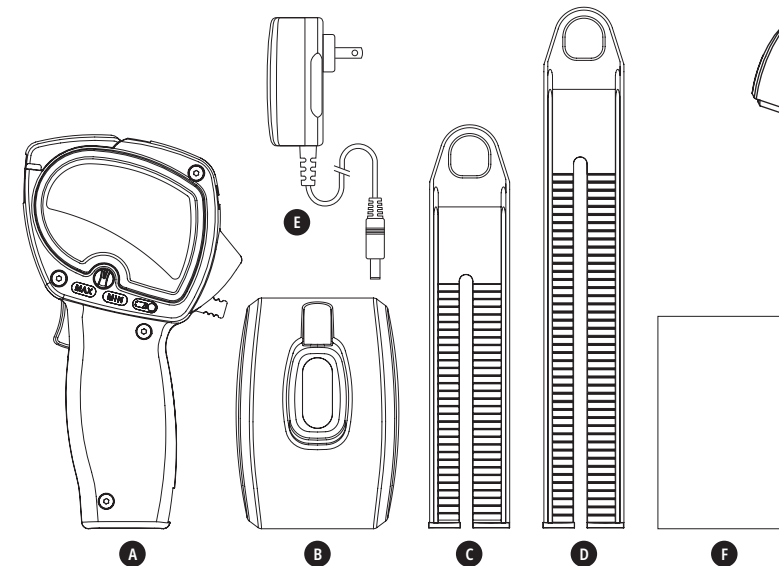

### PACKAGE CONTENTS

Item	Description	Qty
A	Ultradent BFC3 Powered Impression Gun	1
B	Countertop Stand	1
C	50 ml/25 ml Plunger	1
D	75 ml Plunger	1
E	Battery Charger	1
F	Instructions for Use	1

### SYMBOLS USED



Manufactured by Practicon, 1112 Sugg Parkway, Greenville, NC 27834 USA  
Made in the USA from U.S. and globally sourced materials. Distributed by  
Ultradent Products Inc., 505 West Ultradent Drive, South Jordan, Utah 84095

800.552.5512 | ULTRADENT.COM

1011586AR02 112222

## Quick Start



Charge your Ultradent BFC3 Powered Impression Gun for three hours or until the LED on the battery charger turns from red to green.



Insert a plunger into the front of the BFC3 impression gun. Push up on the back plunger release lever to allow the plunger to slide completely into the BFC3 impression gun.



Insert material cartridge into the BFC3 impression gun with the cartridge notch facing down. Close the cartridge door completely.



Attach new mixing tip to material cartridge. **Mixing tip hub color must match material cartridge cap color.**

Continue →

# Product Information

## ULTRADENT BFC3 POWERED IMPRESSION GUN COMPONENTS AND CONTROLS

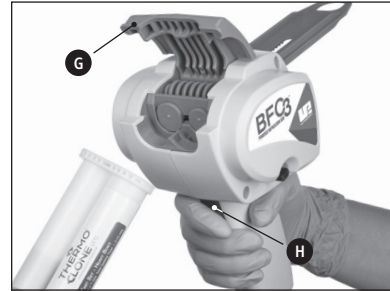

- G** Cartridge door  
Raise to open and insert/remove automix cartridge. Close completely before use.
- H** Dispensing activation trigger



- J** Dispensing speed control  
Adjustable from 0.6 ml/sec. (min) to 1.7 ml/sec. (max)
- K** Low battery LED

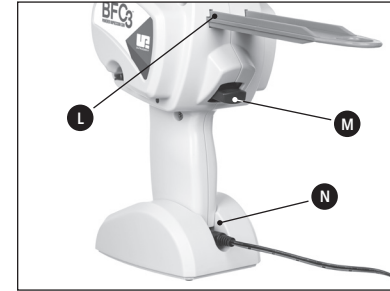

- L** Plunger slot
- M** Plunger release lever  
Press upward to insert, withdraw, or remove plunger
- N** Battery charger connector

### CHARGE THE BATTERY FULLY BEFORE USING THE ULTRADENT BFC3 POWERED IMPRESSION GUN FOR THE FIRST TIME

Insert the charging cable into the connector **N** at the base of the BFC3 impression gun handle and then place the BFC3 impression gun into the stand so the charging cable extends out the back of the stand. The LED indicator on the battery charger will change from red to green when the battery is fully charged. A full charge can take up to 2½ hours.

**DISCONNECT CHARGER FROM ULTRADENT BFC3 POWERED IMPRESSION GUN PRIOR TO USE. UNIT WILL NOT OPERATE WITH BATTERY CHARGER CONNECTED.**

### PREPARING THE ULTRADENT BFC3 POWERED IMPRESSION GUN FOR USE

Select the 50 ml plunger **C** or 75 ml plunger **D** as appropriate for your material cartridge. Open the cartridge door **G**. Hold the BFC3 impression gun in one hand and press upward on the plunger release lever **M** with your thumb. With the other hand, insert the plunger **teeth side down** into the plunger slot **L** in the front of the unit and slide it back as far as it will go. Release the plunger release lever. The BFC3 impression gun is now ready to load.

### OPERATION

Using the BFC3 impression gun is very much like using a manual impression gun, only easier. Instead of having to repeatedly squeeze a large spring-loaded trigger with your hand, the BFC3 impression gun dispenses automix material with the press of a button.

### LOADING A CARTRIDGE

Press the plunger release lever **M** upward with your thumb, pull the plunger back until it stops, and then release the lever. Open the cartridge door **G** and insert an automix cartridge **notch side down**. Close the cartridge door. Press the plunger release lever again and slide the plunger forward until it contacts the cartridge. Release the lever.

### ADJUSTING THE FLOW RATE

The BFC3 impression gun can dispense material at a rate that ranges from 0.6 to 1.7 ml/sec. Adjust the flow rate by rotating the dispensing speed control **J** between the MIN and MAX settings. Experiment with different flow rates to find the setting that works best for your practice and procedures.

### DISPENSING MATERIAL

*As with all impression guns, express the first drops of material onto a paper towel or tray liner.*

Attach a **new, unused mixing tip** to the material cartridge. **Be sure the hub color of the mixing tip matches the cartridge cap color.** Using the wrong size mixing tip can prevent proper operation and damage the unit.

Press the dispensing activation trigger **H** with your index finger to start the flow of material. Release the trigger when enough material has been dispensed.

The BFC3 impression gun includes an anti-drip feature that momentarily reverses the plunger when the dispensing trigger is released, and an auto-stop feature with overload protection when a cartridge has been emptied.

### CHARGING THE BATTERY

*Use only the charger that came with your Ultradent BFC3 Powered Impression Gun. Use of another charger could damage the unit and will void the warranty.*

With a fully charged battery, the BFC3 impression gun can dispense about 60 full 50 ml heavy-body VPS cartridges. When battery output is reduced, the low battery LED **K** will illuminate, indicating that the BFC3 impression gun battery should be charged soon. The BFC3 impression gun will dispense up to 10 full cartridges after the low battery LED illuminates.

The BFC3 impression gun battery is rated for 500 recharges (about 30,000 cartridges) before replacement will be required. Contact Ultradent for battery replacement service. Do not attempt to open the unit or service the battery.

### CLEANING AND DISINFECTION

*This product must be disinfected for each patient. Failure to follow these guidelines could damage the device and void the warranty.*

Clean the body of the device and plungers with disinfectant wipes. Follow all disinfectant manufacturer's guidelines for use.

- Do not use any cleaner containing bleach.
- Do not immerse in liquid.
- Do not place in autoclave.

### TROUBLESHOOTING

Problem	Resolution
Cannot insert plunger	Insert the plunger into the slot on the front of the unit <b>teeth side down</b> . The slot is keyed so that the plunger can only go in one way.
Dispensing is too slow/fast	Adjust the dispensing speed control to increase/decrease the flow.
Unit will not dispense material	Cartridge is empty and auto-stop engaged; replace cartridge. Battery charger is still connected to unit (by design, unit will not operate with charger connected); disconnect battery charger from BFC3 impression gun.
Popping or clicking noise when dispensing material	Plunger has been damaged as a result of using an old or incorrectly sized mixing tip. Contact Ultradent .
Battery will not charge	Contact Ultradent for battery service. Do not attempt to open the unit or service the battery.

### PRODUCT SPECIFICATIONS

Type of Information	Specifications
Device Name	Ultradent BFC3 Powered Impression Gun
Battery	Rechargeable 11.1V lithium-ion
Battery charger	12.6V/500mA with LED indicator
Charging time	2½ hours (full charge)
Flow rate	Adjustable from 0.6 to 1.7 ml/sec.
Device Dimensions	4"W x 4"D x 7"H (overall)
Device Weight	28.1 oz.
Protection from Ingress of Liquid	<b>IPX0</b>

**DISTRIBUTED BY**  
Ultradent Products Inc.  
505 West (10200 South) Ultradent Drive  
South Jordan, Utah 84095

**US PAT. 10,912,632**

### MANUFACTURER

Practicon, Inc.  
1112 Sugg Parkway  
Greenville, NC 27834 USA

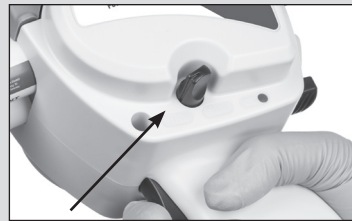

Adjust the dispensing speed. Ultradent recommends using a slower speed for lighter body materials.

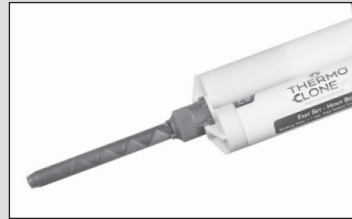

After impression has been completed, wipe down tips, cartridge, and BFC3 impression gun with an appropriate surface disinfectant and leave used tip in place to prevent product from contamination or drying out.



The BFC3 impression gun can be cleaned with surface disinfectant. Do not autoclave your BFC3 impression gun.

**Should your Ultradent BFC3 Powered Impression Gun not perform as expected, please refer to all printed instructions included with your BFC3 impression gun, or call our toll-free number at 1.800.552.5512 and speak with our customer service representatives.**