

# CZ10

## 系留悬浮灯

## Hover Light

2025.06 V1.0

# 用户手册

# User Manual

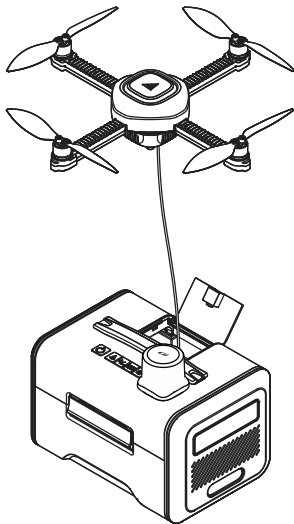

# Contents

<b>Important Notes.....</b>	<b>16</b>
Symbol Legend .....	16
<b>Safety Precautions .....</b>	<b>16</b>
Operating Environment.....	16
Operating Guidelines.....	17
<b>Product Overview.....</b>	<b>17</b>
<b>Product Specifications .....</b>	<b>18</b>
<b>Appearance Description.....</b>	<b>19</b>
Ground Station .....	19
Airborne .....	21
<b>Usage Tutorial.....</b>	<b>22</b>
Ground Station Control .....	22
APP Control.....	28
Propeller Guard Installation Tutorial.....	29
<b>Product Maintenance.....</b>	<b>30</b>
<b>Packing List.....</b>	<b>30</b>
<b>Product Warranty Card</b>	

## Operating Guidelines

1. Do not touch the rotating propellers with your hands or any objects to avoid personal injury or damage to the blades.
2. This product does not have obstacle avoidance capability. Keep a safe distance from other aircraft or obstacles to prevent collisions.
3. Do not pull the tether cable when the unit is powered off.
4. Do not step on or place heavy objects on the ground station to avoid structural damage.



Note:

Ensure that both firmware and mobile app are updated to the latest versions before use.

In the event of sudden bad weather, initiate return-to-home procedures immediately.

### Initial Inspection

#### When unpacking the product for the first time:

- Check for any damage that may have occurred during shipping.
- Verify that all components and accessories are included.

If any issues are discovered, please contact CZI support immediately.

Before initial operation, disengage the USB-C port dust caps from both Airborne unit and Ground station.

## Product Overview

The CZ10 Hover Light is a high-efficiency, lightweight illumination solution designed for diverse outdoor scenarios. When connected to a portable power supply or a vehicle's external power port, the system provides continuous, extended lighting.

Weighing only 3.5kg (combined air and ground units), the CZ10 is easily carried and deployed by a single operator. The system is exceptionally user-friendly—requiring no formal training—and can be fully deployed from backpack to operation in just 3 minutes. Unlike traditional lighting drones, the CZ10 supports dual-mode operation (mobile app and ground station), offering fast and flexible control for field operations.

## Product Specifications

Product Name	CZ10 Hover Light
Electrical interface	Aviation connector
Total System Weight	3350g
Airborne unit	241g
Ground station	2550g
Airborne unit Deployment	273×273×61mm
Airborne unit Folding	117×117×127mm
Ground Station	250×173×165mm
Rated Airborne Light Power	≤100W
Max Arm Light Brightness	16000lm
Illumination Coverage (10m)	1300m <sup>2</sup> (with 3 lx as the illumination boundary)
Ground Flashlight Power	20W
Lighting Modes	Ambient, Red/Blue Strobe, SOS
Arm Indicator Light	Dual-color (Red-Green) LED
Hovering Accuracy	±10cm
Maximum Flight Altitude	±10m
Maximum Wind Resistance	8m/s
Positioning System	RTK (BDS+GPS+Galileo+GLONASS+QZSS)
Operating Temperature	-10°C~+40°C
Maximum Operating Altitude	3000m
Control Methods	Dual-mode Control (APP/Ground Station)
Integrated Battery	2500mAh\14.8V
Power Adapter	InPut:100-240V~50/60Hz 5.0A MAX OutPut:48.0V/5.0A 240W



## Appearance Description

### Ground Station

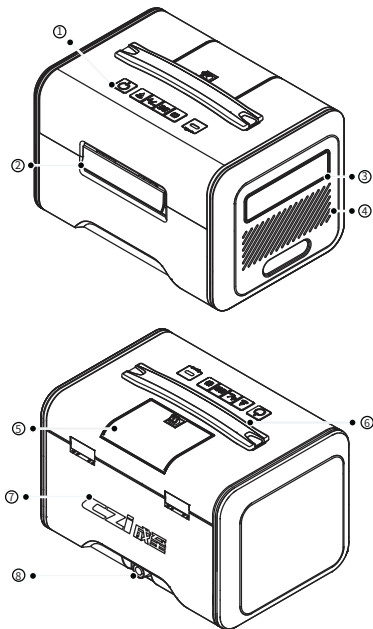

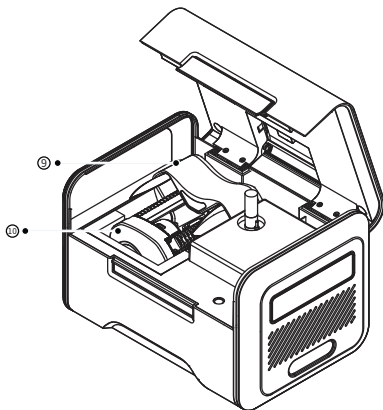

① control panel

② Tether Cable Protective Flap

③ Carry Handle

④ Lamp Panel

⑤ Cooling Vents

⑥ Latch

⑦ CZI LOGO

⑧ Power Port

⑨ Storage Sleeve

⑩ Airborne

## Airborne

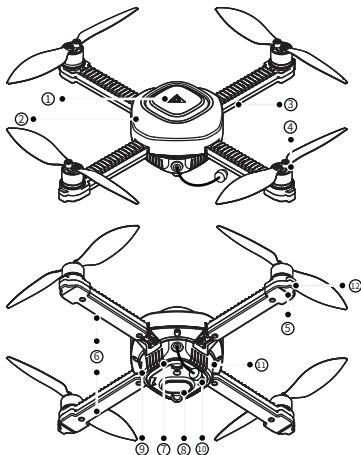

① CZI LOGO

② Frame

③ Arm

④ Propeller

⑤ Motor

⑥ Arm Light

⑦ Frame Cooling Vents

⑧ Laser Optical Flow Module

⑨ Type-C Port

⑩ Tether Cable Port

⑪ Reset Pinhole

⑫ Status Indicator

## Usage Tutorial

### Ground Station Control

- 1.Connect power source.

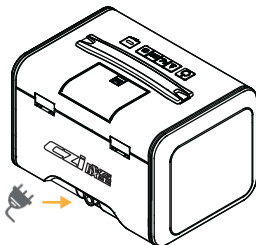

- 2.Press and hold the power button for 3 seconds to power on the device.

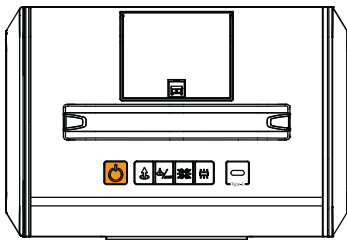

3. Open Ground Station cover.

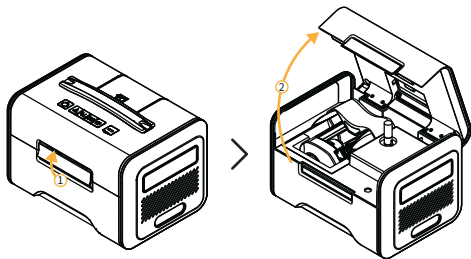

4. Remove Airborne unit from Ground Station and unfold.

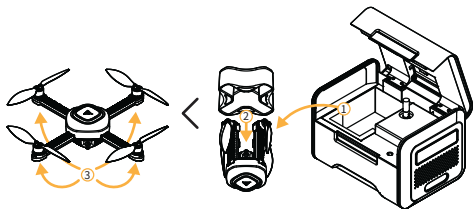

5. Press the clip to open Tether Cable Protective Flap.

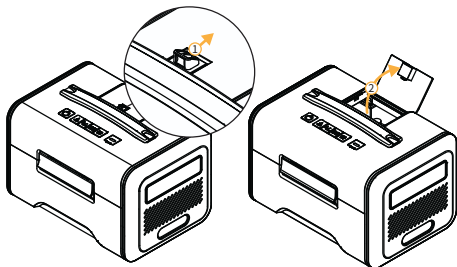

6. Pull the tether cable out until you reach the fluorescent marker indicator.

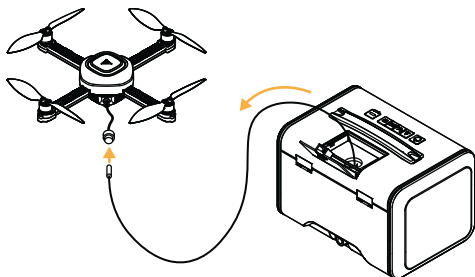

7.Connect RTK module.

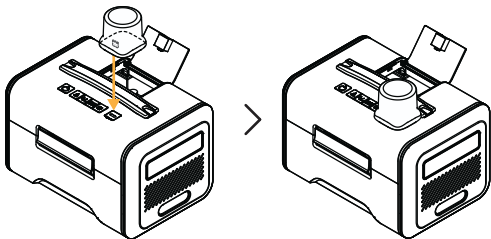

8.Connect tether cable to Airborne unit.

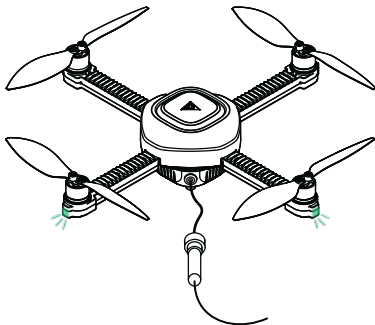

## 9. Ground Station controls.

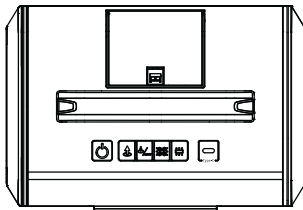

	Power Button	<p>Press and hold the power button to power on/off. After powering on, press the button twice to enter network configuration mode and use the app to connect.</p> <p>Power indicator status:            Green: battery &gt; 70%; Blue: battery &gt; 40%; Red: low battery</p> <p>The power indicator flashes while charging.</p>
	Take off Button	<p>Press and hold the takeoff button for airborne unit one-touch takeoff. The lights will flash.</p>
	Landing / Tether Recovery Button	<p>Press and hold the landing button for airborne unit one-touch landing and tether recovery. The lights will flash.</p> <p>Press and hold the landing button to recover the tether.</p>
	Airborne Light Control	<p>Long press to turn light on/off</p> <p>Short press to adjust brightness</p>
	Ground Station Light Control	<p>Long press to turn light on/off</p> <p>Short press to adjust brightness</p>



10. Disconnect the cable from the Airborne unit; it will retract automatically.

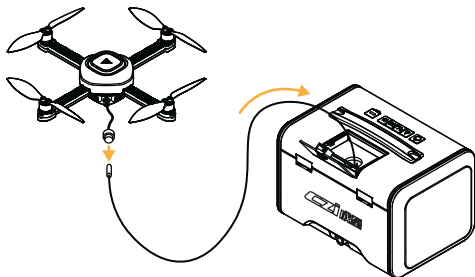

11. Place the Airborne unit into its protective sleeve and return it to the Ground Station. Close the cover.

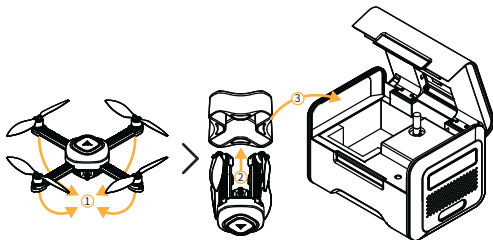

12.Long-press power button to shut down, disconnect power.

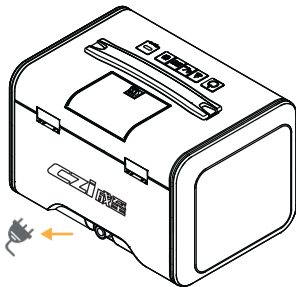

## APP Control

Android system→Scan the QR code below to download the corresponding system app (ChengZhi Website->Support->Download center->APP download).



If you are using an iOS system, you need to download the czi Sky APP from the Apple App Store.

## Propeller Guard Installation Tutorial

Attach the propeller guard as illustrated, then fasten it with the locking clip.

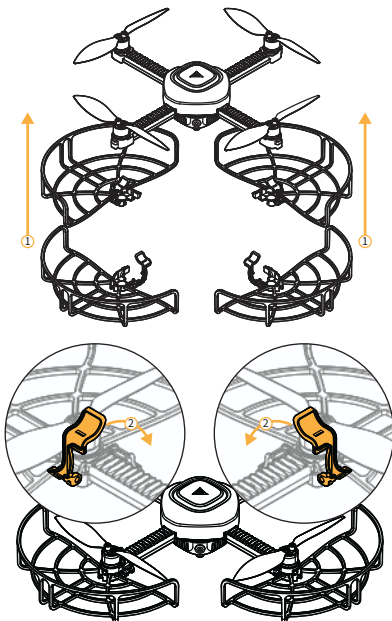

## Product Maintenance

1. Disconnect the power source when the system is not in use.
2. Unplug all power connectors before cleaning.
3. Use a dry cloth to wipe surfaces. Store the device in a cool, dry place.
4. Regularly clean the cooling vents on both the Airborne and ground units to ensure proper ventilation and avoid overheating.

## Packing List

CZ10 Full System	1
Power Adapter	1
User Manual (with Warranty Card)	1
Replacement Propeller Set (2 CW + 2 CCW)	1
Propeller Guard Set	1
RTK Module	1
Backpack	1



# 产品合格证

本产品经检验符合技术标准

## Product Certificate of Conformity

This product has passed inspection  
and meets all technical standards.

产品名称	系留浮空灯 Hover Light
产品型号 MODEL	CZ10
检验员 QC	

## 产品保修卡

广州成至智能机器科技有限公司,致力于为用户提供优质的产品服务!

自购买产品之日起7日内,发生性能故障的,可退货、换货或维修;

自购买产品之日15日内,发生产品性能故障的,可换货或维修;

产品三包有效期内发生性能故障的,可享受免费维修服务。

当您需要我们提供技术支持及了解更多产品讯息时,请联系我们!

联系电话:400-008-8306

地址:广州市天河区广汕一路银湖创意园龙林中街5号广州成至智能机器科技有限公司

## Product Warranty Card

CZI is committed to providing users with quality product services!

Within 15 days from the date of purchase of the product,  
performance failures occur, can be returned, exchanged or repaired;  
product warranty validity period of performance failures occur,  
you can enjoy free repair services.

When you need us to provide technical support and learn more  
product information, please contact us!

TEL : +86-400-008-8306

Web Site: <https://czi.com.cn/en>





成至技术支持

[www.czi.com.cn](http://www.czi.com.cn)

服务热线：400-008-8306

如您对说明书有任何疑问或者建议

请通过以下电子邮箱联系我们：

[czzn@czi.com.cn](mailto:czzn@czi.com.cn)

ChengZhi Support

[www.czi.com.cn](http://www.czi.com.cn)

Service hotline: 400-008-8306

If you have any questions or suggestions  
about the instructions, Please contact us  
through the following email address:

[czzn@czi.com.cn](mailto:czzn@czi.com.cn)



Made in China