

4 pcs Long profile with hole  
4 pcs Long profile with nut rivet

8 pcs Short Top & Bottom Profile

36 pcs  
M4 Screws

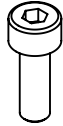

16 pcs  
Corner Frame Bracket  
with Set Screws

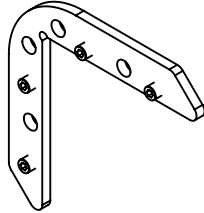

4 pcs  
Top Corner bracket

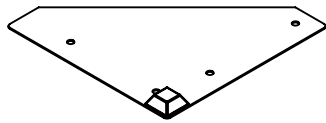
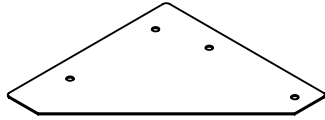

4 pcs  
Bottom Corner Bracket  
with foot

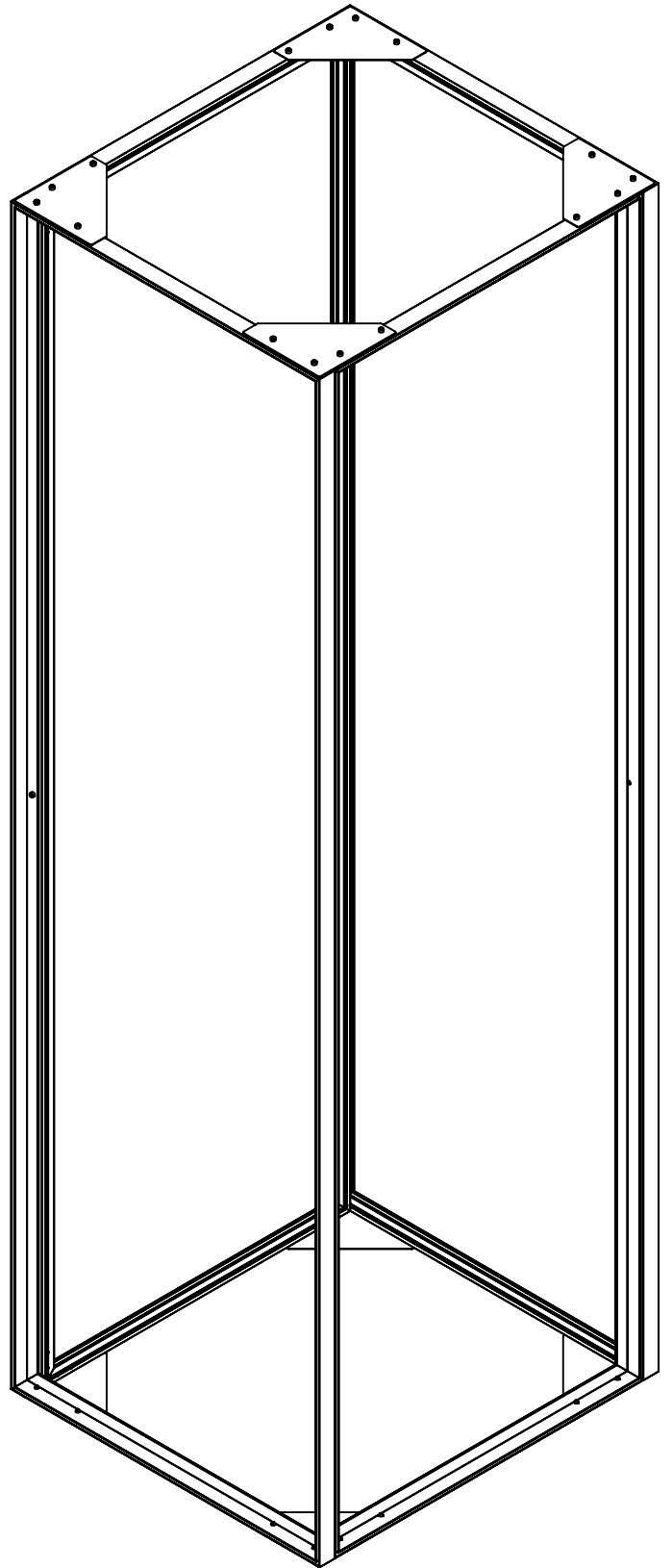

# Assembling the Frame

1

Prepare the frame:  
4 Corner Brackets  
2 Long profiles (with holes or rivets)  
2 Short Profiles

## WARNING!

Before assembling the frame,  
make sure you prepared same  
long profiles (with holes or with rivets)

2

Insert coner brackets into  
backside groove into both  
profiles with set screws pointing  
out and tighten the screws with  
hex wrench

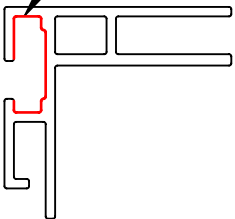

3

After assembling all four frames,  
you should have 2 frames with  
rivets and 2 frames with holes

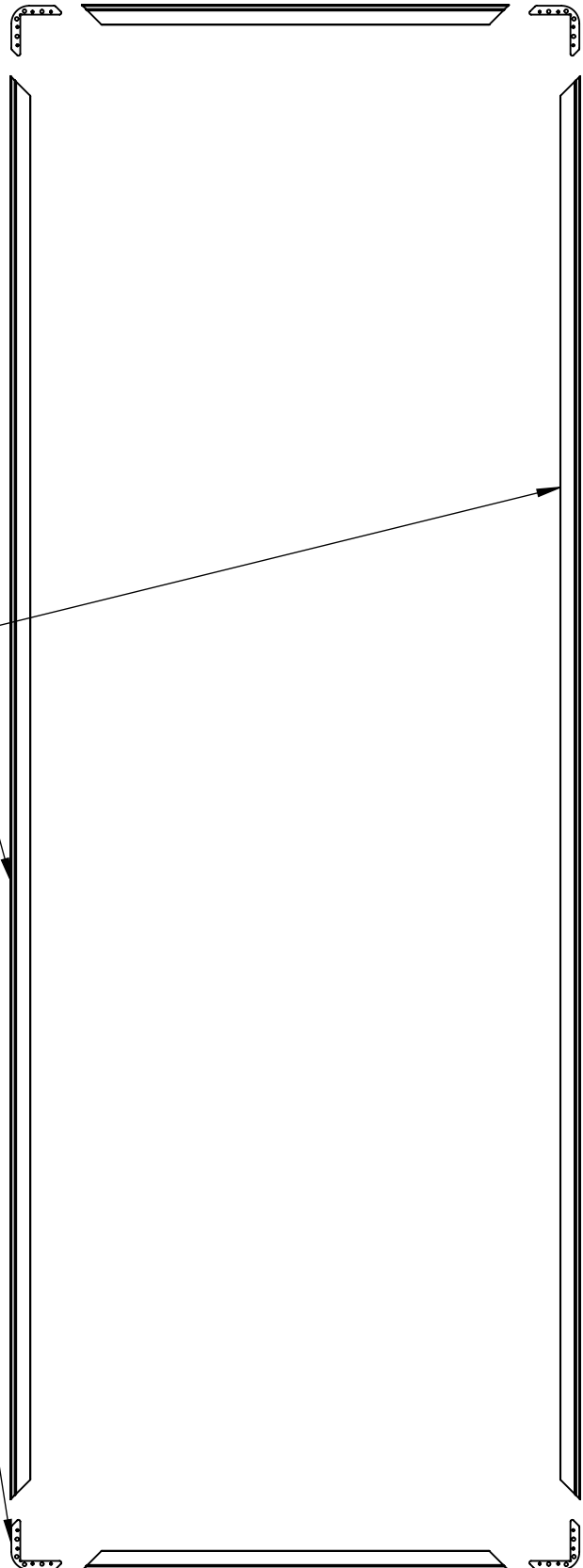

# Assembling the Tower

- 5 After putting all frame together in the middle, install top and bottom corner brackets

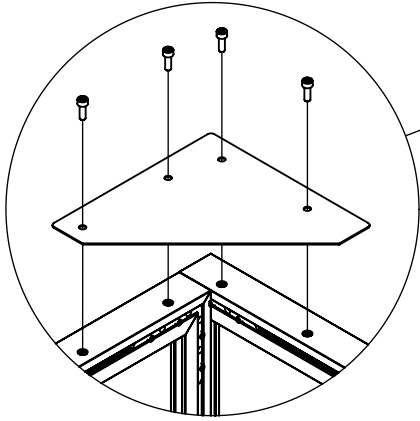

- 4 Screw frames together in the middle  
Frames with rivets inside, with holes outside

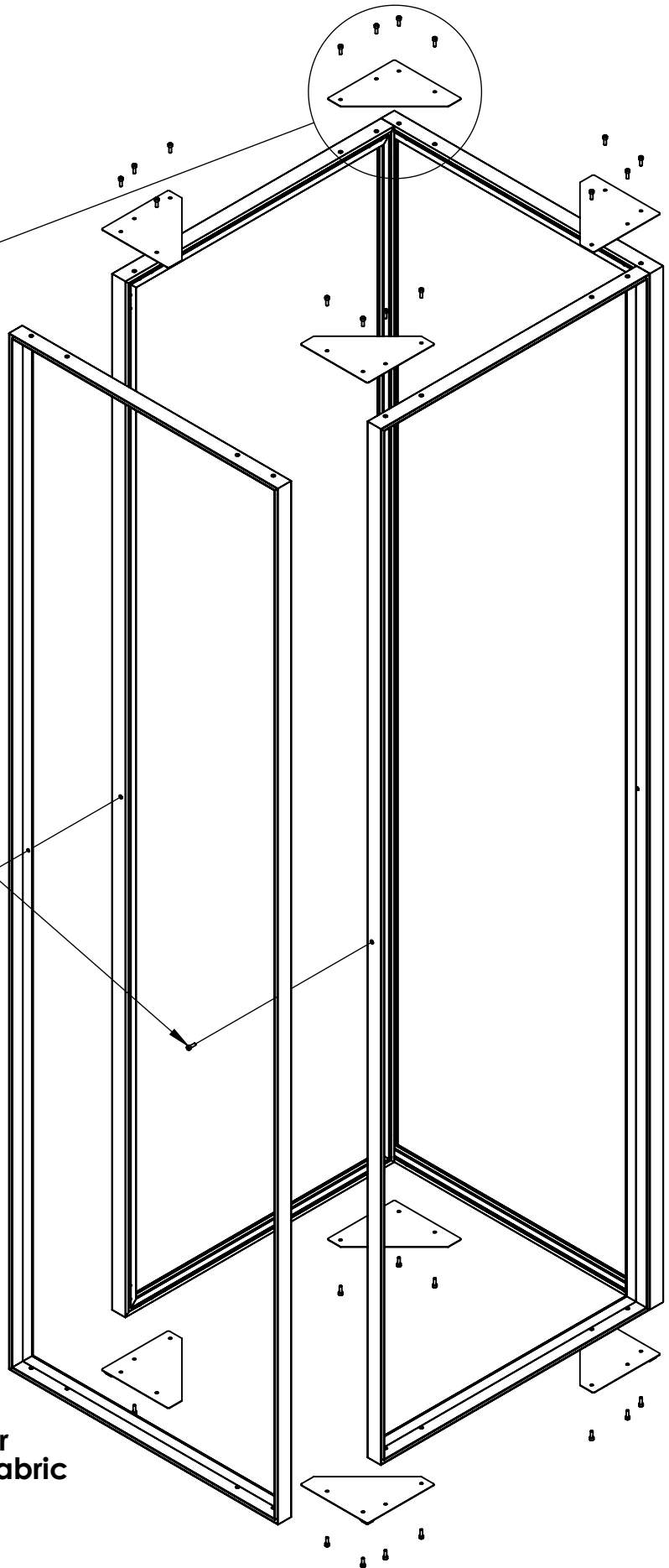

- 6 Now the frame of the tower is complete, you can put fabric in the frames

# Completed Fabric Tower

