

Instruction Manual

Assemble

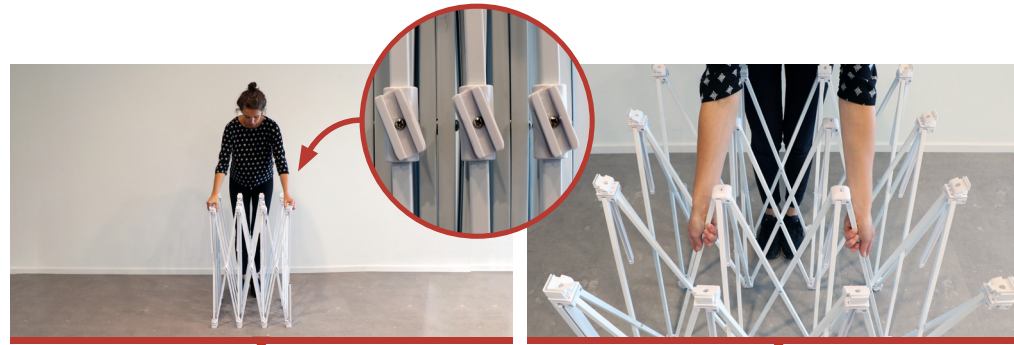

1. Open the frame by pulling the hinges outwards, with the light connectors facing away from you.



2. Place your hands on the crosses as shown in the picture.

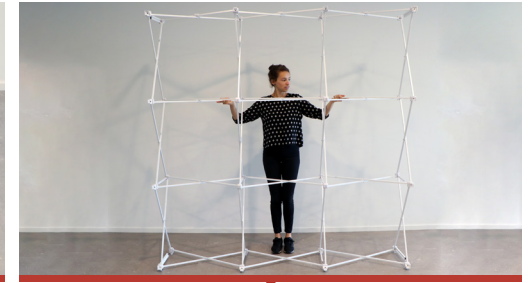

3. Gently lift up the frame while flipping it over, the pop-up frame will unfold itself.



4. Close all clips to lock the frame.

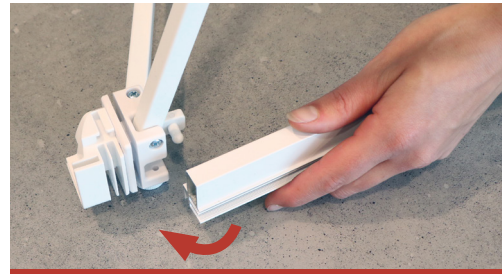

5. Close the attached bars in the 4 corners.

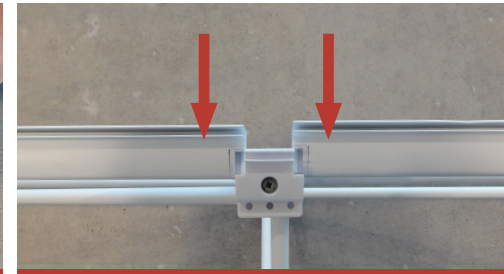

6. Place the frame on the ground and slide in the aluminium bars from the side.

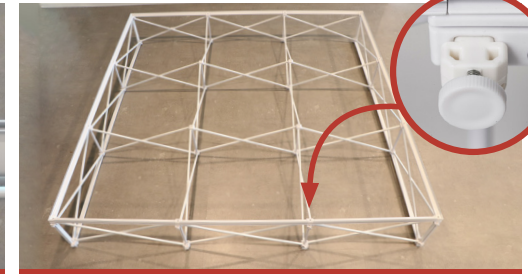

7. Place all bars on the frontside. Use only the left and right sides on the back. The feet mark the bottom.

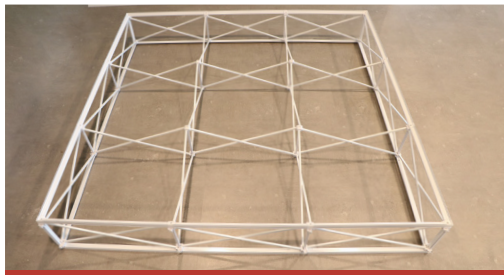

Optional: for double-sided use, add the extra bars on the top and bottom of the backside.

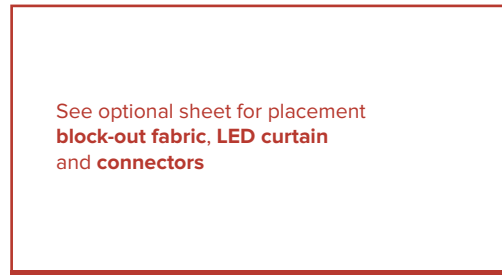

Optional: if you want to use backlit LED's, go to optional sheet before continuing.

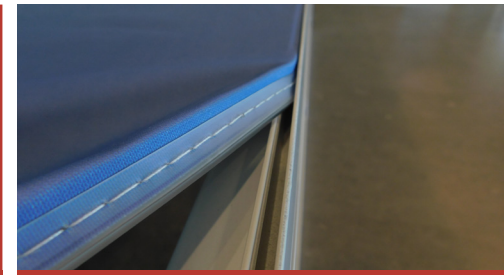

8. Attach the fabric by pushing the silicone edges in the grooves.



9. Start in the 4 corners of the frame, to divide the tension.



10. Work your way around the frame until all silicone edges are attached.



11. Lift the frame, the system is now ready to use.



Optional: Attach the feet for more stability, by sliding them over the 2 adjustable feet.



Scan for instructional video

Instruction Manual

Disassemble

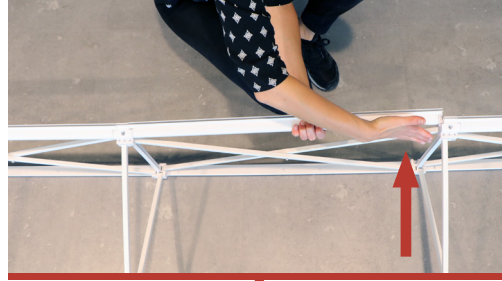

1. To take out the bars, give them a firm tap outwards on both ends.

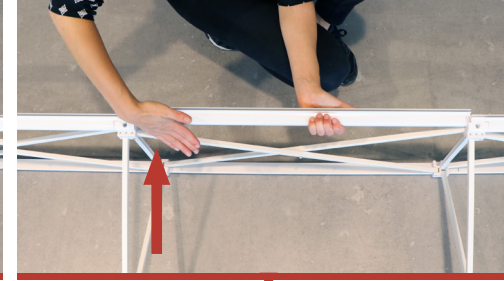

2. In this way the bars come loose, without damaging the caps or system.

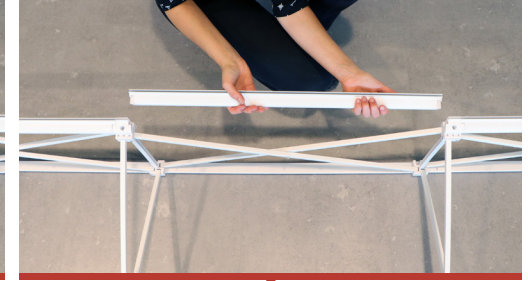

3. Now you can easily take out the bars.

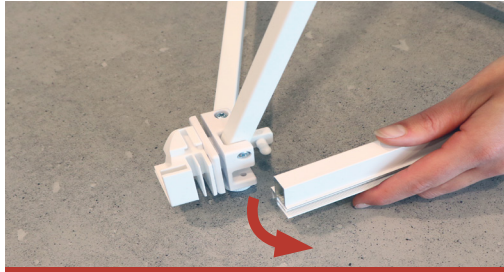

4. Open the attached bars in the 4 corners.



5. Open all clips, and double check to make sure all clips are disconnected.



6. Place your hands on the outside of the hinges to prevent your fingers from getting stuck.



7. Slowly move your hands downwards, the frame will fold itself.

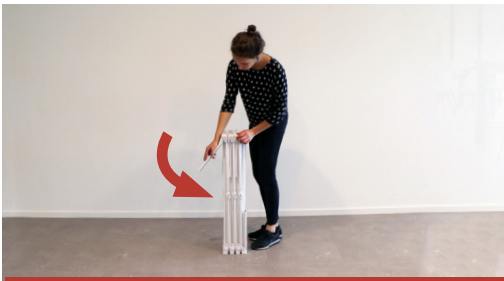

8. Shut the attached bars in the 4 corners and pack the frame for storage.

Optional:
Block-out fabric



1. Attach the block-out fabric on the backside by pushing the silicone edges in the grooves.

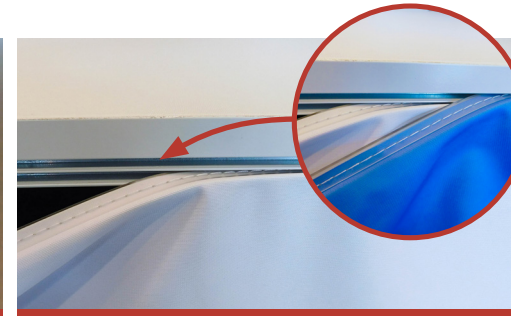

2. For the sides, use the inner groove for the block-out. The outer groove is for the print.



3. The block-out with holes goes over the adjustable feet at the bottom of the frame.

Optional:
LED curtain

Power strip needed!
Preferably with **Surge Protection**.
This is not included with the system.



1. Hold the LED curtains against the frame with the mark 'UP' towards the topside.



2. Attach the LED curtains to the frame by connecting all clips to the crosses.

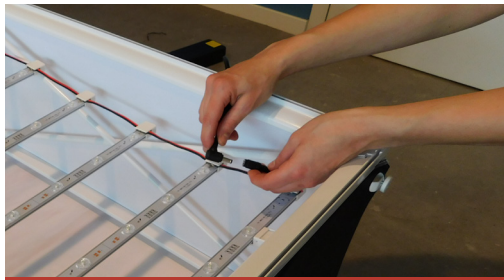

3. Connect the adapter to the lighting plug on the bottom side.



4. Plug the other side of the adapter in the power strip.



5. Open a small gap in the block-out fabric on the bottom to let the power strip cable come out.



6. You can leave the adapter and power strip inside the frame when in use.

Continue with step 8
on the assemble sheet



Scan for instructional video