

Installation Instructions for the BOSS RF receiver

1

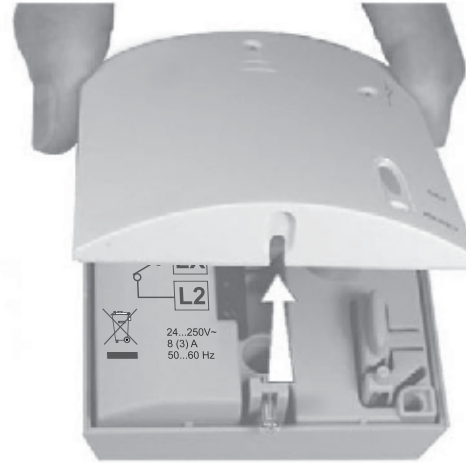

2



3

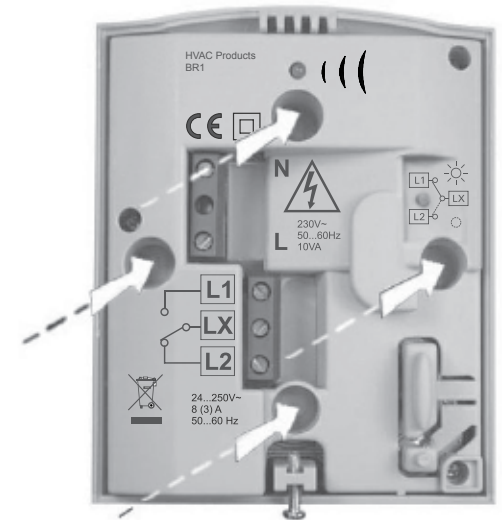

4

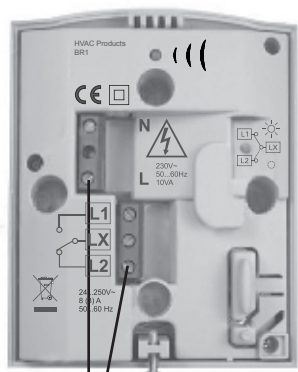

Wiring Diagram

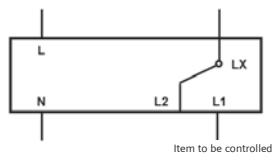

Legend

- LX = Common
- L1 = Live feed to item to be controlled
- L2 = Changeover contact
- L = Live
- N = Neutral

5

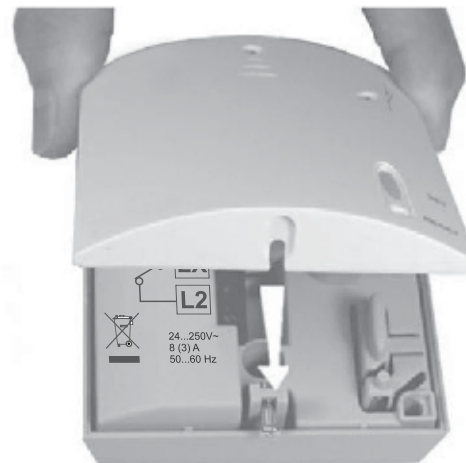

6



Configuration Instructions for the BOSS RF units

1



Press and release SET button, this puts the receiver into learn mode

Please ensure that the vertical and horizontal sliders on the RDJ10RF transmitter are in the AUTO and RUN position before attempting to re-establish communication

Note: The transmitter and receiver are supplied in a single box already configured. This procedure only needs to be followed in case of communication issues

2



Press and release LEARN button on the back of the transmitter

3



Good signal is indicated by the LED flashing green, then solid
No signal is indicated by the LED flashing red, then solid

4



To test transmission press TEST on the transmitter
This will switch relay on in receiver irrespective of temperature
RF TEST appears in transmitter display. To switch test off press TEST again

5

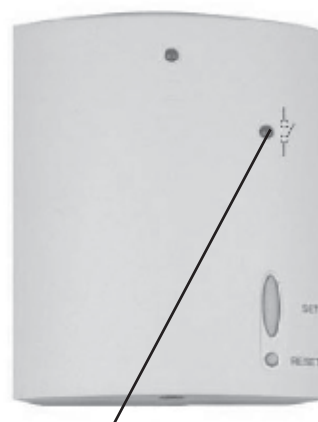

Orange LED indicates relay is on

6



Pressing the RESET button for about 4 seconds will erase all ID codes in the receiver. The set up procedure has to be repeated to regain communication