

The Map

 FLOWSCAPE

Unbeatable office 3D Overview

Experience having all office resources available at your fingertips, even without fixed seating arrangements. Our 3D map displays all office resources with clear color indication. Flowscape is the acknowledged market leader in terms of quality, user friendliness, adaptability, and function.

FlowPlanner

Empower team collaboration and plan your week at the office

1. Scan office attendance for weeks ahead. Add your closest team members to your selected colleagues list and keep track of when they will be in the office. View reached office capacity to evaluate if the office will be overcrowded or just right.
2. Make yourself seen and be guaranteed a seat. Select which day you want to come to the office and register attendance. Your colleagues will know when you will be in, and you will know that there is room for you.
3. Empower team collaboration by booking workspaces next to the people you cooperate with the most. Click on a colleague to search for their desk booking and scan the map for available spaces in that area.

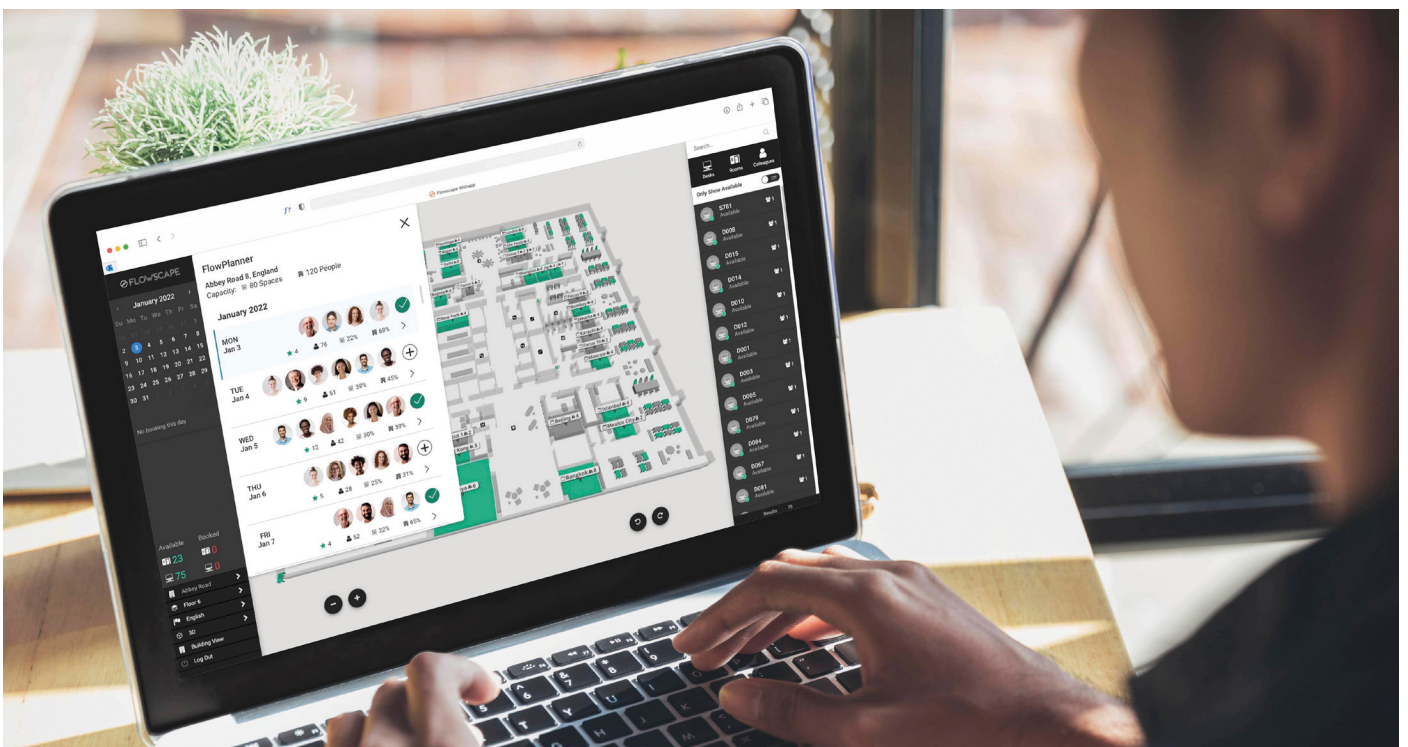
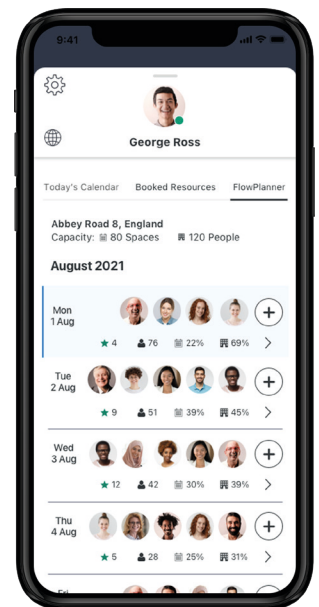

App Flow

Find the resources you need

1. Resources can be booked directly or in advance with just a few clicks the booking wizard selects the most suitable desk, room or parking space depending on the equipment you need and your location preference.
2. All desk bookings made can be found under “My Reservations” in the Flowscape app, which also shows the exact location of the resource. Whether the booking was made for you or by you, it will always be possible to find in just a few seconds with wayfinding.
3. If you notice that something in the room does not work properly, you can use the mobile app to report the problem in Flowscape’s Housekeeping system to inform others about the issue and help your colleagues re-book if needed.

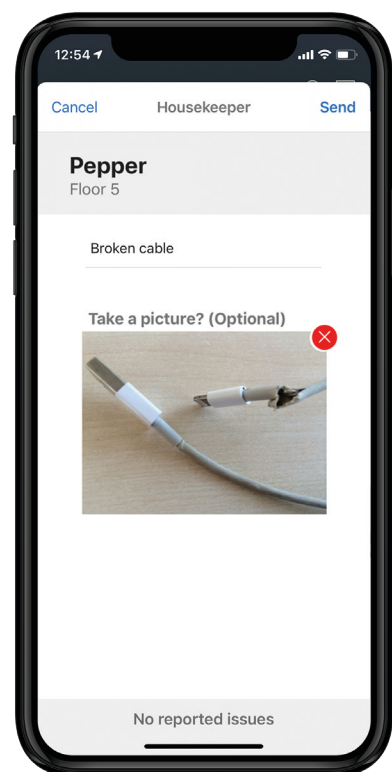
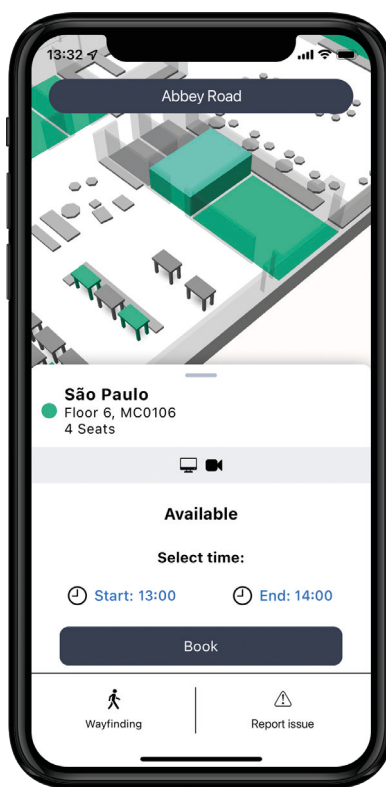
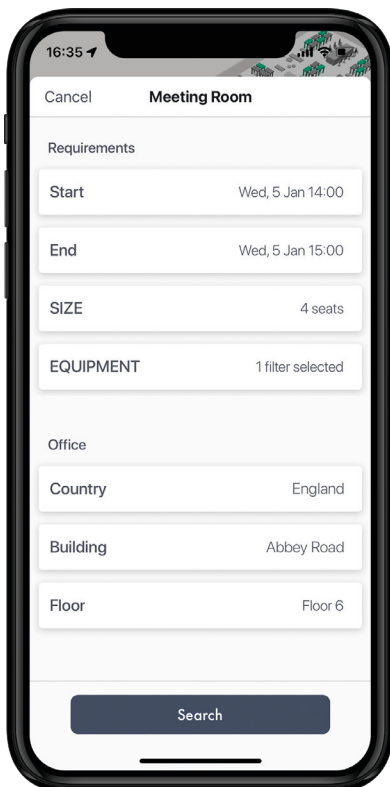

Contact us!

Our solution experts will design the optimum solution for you,
contact us at sales@flowscape-solutions.com

