

# Meeting and event spaces



| Space                            | Dimensions                      | Square feet | Ceiling height        | Reception | Rounds of 10 | Classroom 3 per 8' | Hollow sq/conf | U-shape | Theater style | 8'x10' trade show booth | 10'x10' trade show booth |
|----------------------------------|---------------------------------|-------------|-----------------------|-----------|--------------|--------------------|----------------|---------|---------------|-------------------------|--------------------------|
| <b>SentryWorld</b>               |                                 |             |                       |           |              |                    |                |         |               |                         |                          |
| Grand Hall                       | 76' x 58'                       | 5,692       | 30'                   | 350       | 370          | 210                | 72             | 60      | 380           | 18                      | 15                       |
| Grand Hall Foyer                 | Varies                          | 2,500       | 15'                   | 250       | —            | —                  | —              | —       | —             | —                       | —                        |
| Atrium                           | 50' x 91'                       | 4,882       | 22'                   | 335       | 280          | 200                | 112            | 96      | 336           | 32                      | 24                       |
| Fieldhouse                       | 248' x 196'                     | 51,354      | 50'                   | 2,500     | 2,500        | —                  | —              | —       | 3,000         | 175                     | 154                      |
| Fieldhouse 1, 3, 5 or 2, 4, 6    | 120' x 180'                     | 21,600      | 50'                   | 1,500     | 1,000        | —                  | —              | —       | 1,500         | 95                      | 75                       |
| Fieldhouse 1 & 3, 2 & 4, 5 & 6   | 120' x 120'                     | 14,400      | 50'                   | 1,000     | 850          | 650                | —              | —       | 1,000         | 75                      | 50                       |
| Fieldhouse 1, 2, 3, 4, 5, 6      | 120' x 60'                      | 7,200       | 50'                   | 500       | 500          | 342                | —              | —       | 750           | 30                      | 50                       |
| Pergola                          | 13' x 18' base                  | —           | 10'1" to top of beams | 250       | 100          | —                  | —              | —       | 350           | —                       | —                        |
| Community Room                   | 35' x 19'                       | 710         | 12'                   | 45        | 40           | 40                 | 30             | 24      | 60            |                         |                          |
| PJ's Celebration Room            | 24' 7" X 13'                    | 312         | 12'                   | 16        | —            | —                  | 16             | —       | —             | —                       | —                        |
| PJ's Lounge Area                 | 23' x 15'                       | 350         | 12'                   | 40        | —            | —                  | —              | —       | —             | —                       | —                        |
| SentryWorld Outdoor Gallery Area | Accommodate up to 300 in a tent |             |                       |           |              |                    |                |         |               |                         |                          |
| The Salon at SentryWorld         | —                               | 478         | 16'                   | 15        | —            | —                  | —              | —       | —             | —                       | —                        |
| <b>The Inn at SentryWorld</b>    |                                 |             |                       |           |              |                    |                |         |               |                         |                          |
| Gathering Room I & II*           | 25'3" x 60'4"                   | 1,522       | 11'                   | 100       | 90           | 54                 | 48             | 48      | 100           | —                       | —                        |
| Gathering Room I or II*          | 25'3" x 30'                     | 760         | 11'                   | 50        | 40           | 27                 | 18             | 18      | 50            | —                       | —                        |
| Gathering Foyer                  | 14'6" x 61'7"                   | 893         | 11'                   | 60        | —            | —                  | —              | —       | —             | —                       | —                        |
| The Salon at The Inn             | —                               | 390         | 10'                   | 8         | —            | —                  | —              | —       | —             | —                       | —                        |

\*Gathering Room(s) are max of 8 guests per round table.

**PLEASE NOTE:** Room capacities are fire code capacities. When planning your event, please note that room capacity may decrease depending on AV production and/or catering/setup requirements.



SENTRY WORLD

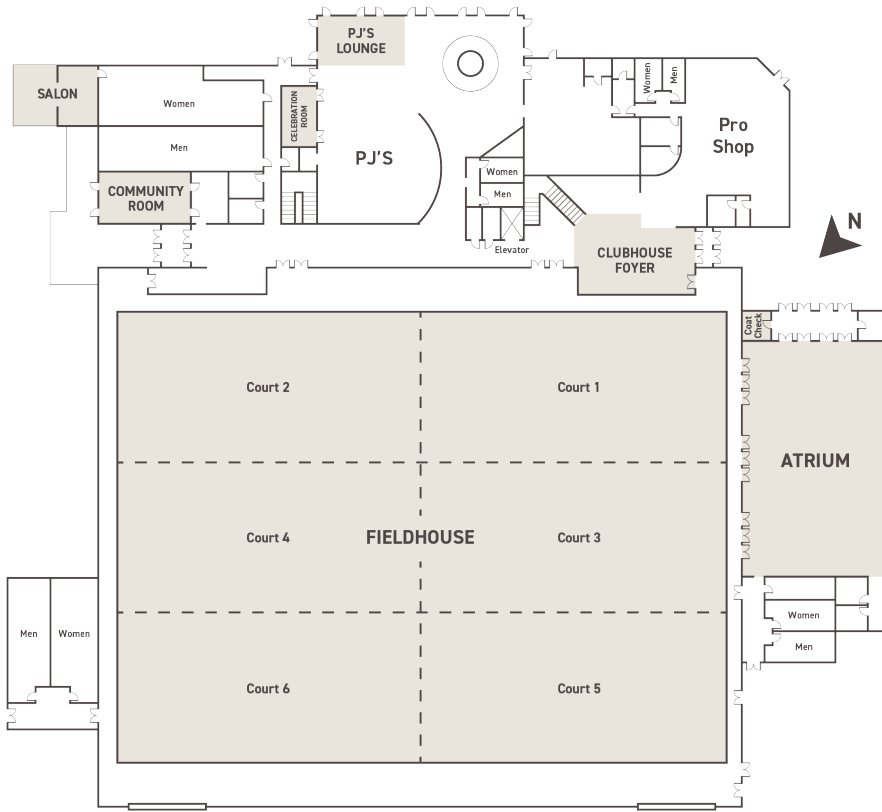

First floor

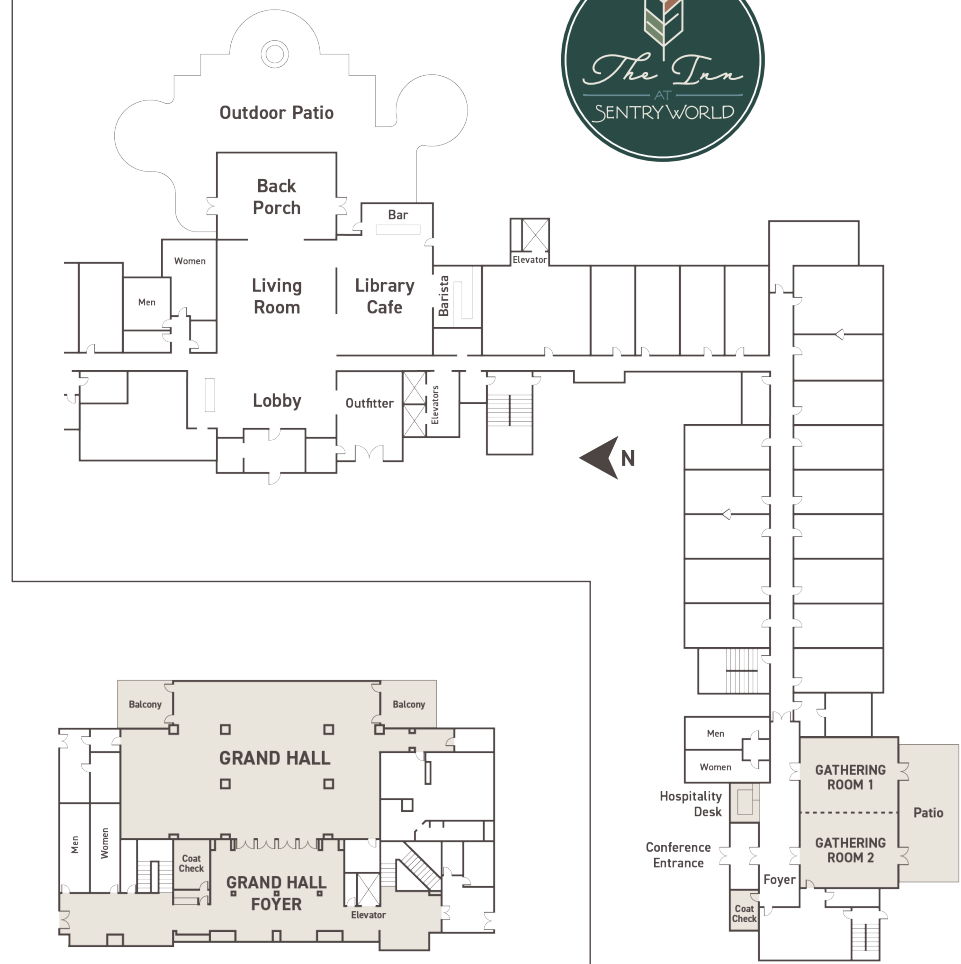

Second floor



Fieldhouse



Atrium



Grand Hall



Community Room



Gathering Room

# Meeting and event spaces

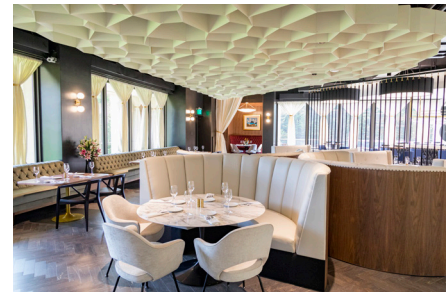
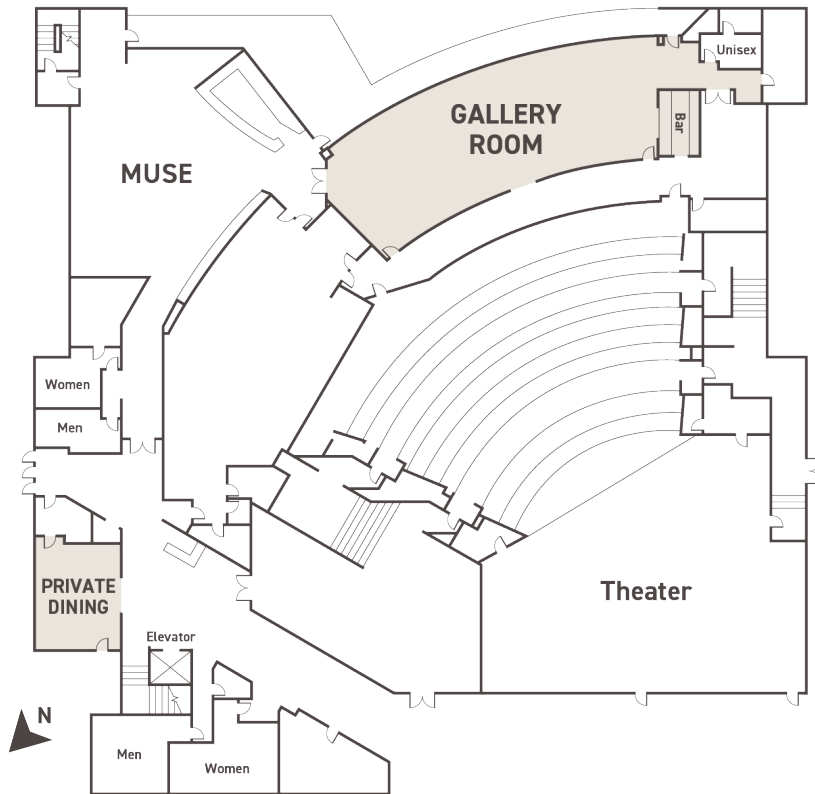

Restaurant



Bar



Gallery Room



Private Dining Room

| Space               | Dimensions       | Square feet | Ceiling height | Reception | Rounds of 10 | Classroom 3 per 8' | Hollow sq/conf | U-shape | Theater style | 8'x10' trade show booth | 10'x10' trade show booth |
|---------------------|------------------|-------------|----------------|-----------|--------------|--------------------|----------------|---------|---------------|-------------------------|--------------------------|
| <b>Muse</b>         |                  |             |                |           |              |                    |                |         |               |                         |                          |
| Gallery Room        | 27' 9" x 78' 8"  | 2,079       | 14'            | 100       | 120          | 70                 | 40             | 36      | 144           | —                       | —                        |
| Private Dining Room | 22' 10" x 18' 4" | 433         | 11'            | 24        | 24           | —                  | 24             | 18      | —             | —                       | —                        |

PLEASE NOTE: Room capacities are fire code capacities. When planning your event, please note that room capacity may decrease depending on AV production and/or catering/setup requirements.