



## INTERIOR LIGHTING



### EW0300 SERIES

#### Surface Mount

These surface mount LED interior lights are available in a variety of lengths and with either clear or frosted (diffused light) lenses. Robust aluminum housings and concealed fasteners complete the package.

#### Models

PART NO.	LENGTH	TYPE	LUMENS (RAW)	AMPS
EW0361	5.4"	27 LED, Switched	400	0.5
EW0371	7.3"	42 LED, Switched	575	0.6

#### Design Features

- 12-24 VDC
- Surface mount with concealed fasteners (hardware included)
- Aluminum housing
- Frosted lens
- Switched and non-switched options

#### Accessories

- EZ0120 PIR Motion Sensor - 100° cone, adjustable sensitivity (automatically activates light when human movement is detected)
- EZ0121 - Interior push button switch, 12-24V
- EZ0122 - Interior touch switch with dimmer, 12-24V

EW0361

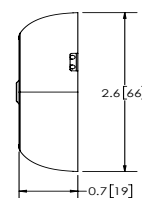
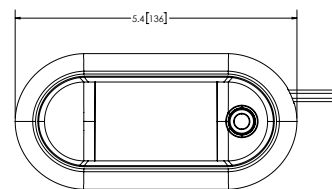

EW0371

