



INTERIOR LIGHTING



EW0300 SERIES

Surface Mount

These surface mount LED interior lights are available in a variety of lengths and with either clear or frosted (diffused light) lenses. Robust aluminum housings and concealed fasteners complete the package.

Models

| PART NO. | TYPE | LENGTH | LUMENS (RAW) | AMPS |
|----------|------------------|--------------|--------------|------|
| EW0361 | 27 LED, Switched | 5.4" 136mm | 400 | 0.5 |
| EW0371 | 42 LED, Switched | 7.3" 186mm | 575 | 0.6 |

Design Features

- 12-24 VDC
- Surface mount with concealed fasteners (hardware included)
- Aluminum housing
- Frosted lens

Accessories

- EZ0120 PIR Motion Sensor - 100° cone, adjustable sensitivity (automatically activates light when human movement is detected)
- EZ0121 - Interior push button switch, 12-24V
- EZ0122 - Interior touch switch with dimmer, 12-24V

EW0361

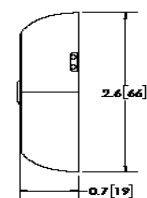
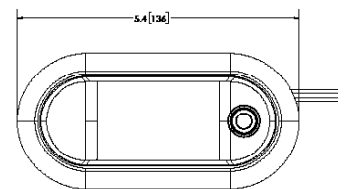

EW0371

