



Freeman

6320 E. Stassenev Ln. Bldg 3 Ste 375
 Austin | TX | 78744
 512.637.3200

This document contains confidential and proprietary information that may not be reproduced or divulged, in whole or in part, without prior written authorization from Freeman Audio Visual, LLC. No warranty, either expressed or implied, are made, including but not limited to compliance with any laws, rules or regulations related to COVID-19. All rights reserved. © 2021 FREEMAN AUDIO VISUAL, LLC.

Exhibit Halls 1-5 RCP



EVENT

AUSTIN
CONVENTION CENTER DEPARTMENT

VENUE

Austin Convention Center
500 E Cesar Chavez St.
Austin | TX | 78701
512.404.4000

ROOM DETAIL

ROOM: Exhibit Halls 1-5

DATE:

FUNCTION:

SEATING:

DRAWING DETAIL

VERSION: SCALE: As Noted
REVISION DATE: 12/2021
DRAWN / REVISED BY:

SHEET NUMBER: 1

SHEET NAME:
Exhibit Halls 1-5

FILE NAME:
ACC_Exhibit_1_5.vwx

Freeman

6320 E Stassenev Ln Bldg 3 Ste 375
Austin | TX | 78744
512.637.3200

This document contains confidential and proprietary information that may not be reproduced or divulged, in whole or in part, without prior written authorization from Freeman Audio Visual, LLC. No warranty, either expressed or implied, are made, including but not limited to compliance with any laws, rules or regulations related to COVID-19. All rights reserved. © 2021 FREEMAN AUDIO VISUAL, LLC.

ALL FLOORPLANS ARE SUBJECT TO FINAL APPROVAL BY THE LOCAL PERMITS DEPARTMENT.

Service Hallway

Service Hallway

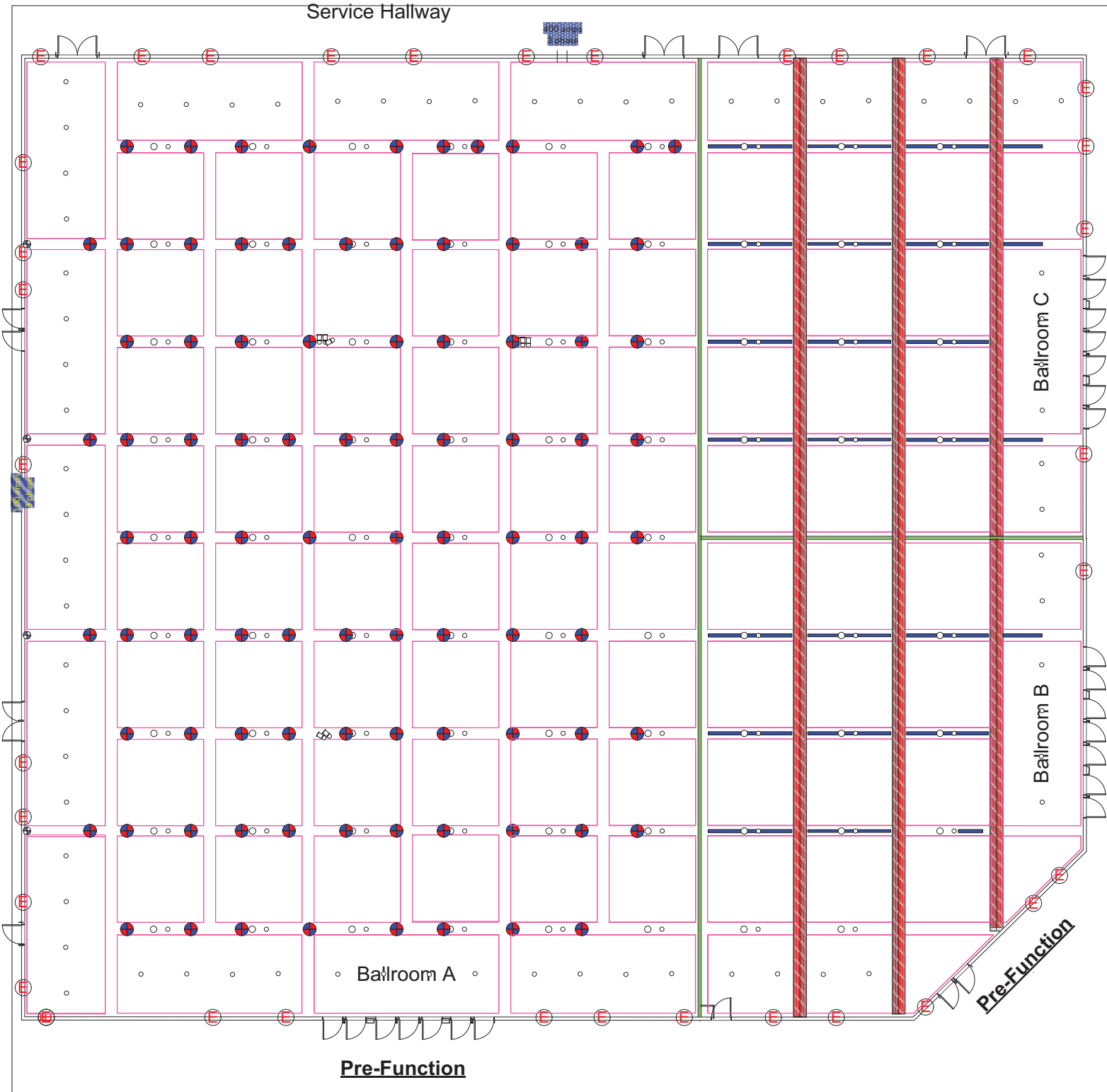

EVENT

AUSTIN
 CONVENTION CENTER
 DEPARTMENT

VENUE

AUSTIN
 CONVENTION CENTER
 DEPARTMENT

500 E Cesar Chavez St
 Austin | TX | 78701
 512.404.4000

Freeman¹

No Bridles

- HID Lights
- LED Cans
- Airwalls
- Ceiling Tile 35'
- Rigging Point 1000 lbs.
- Cable Pick ONLY 500 lbs.
- Rigging Beam B/C Only
Rigging Points are on 10' Centers
- 400 Amp 3 phase Connection
- 100 Amp Connection

Ballroom A, B, C
 All rigging will be dead hangs. No Bridling permitted
 Hang Point Limit 1000 lbs max

This document contains confidential and proprietary information that may not be reproduced or divulged, in whole or in part, without written authorization from Freeman Audio Visual, Inc.

Every effort has been made to ensure the accuracy of all information contained on this floorplan. However, no warranties, either expressed or implied, are made with respect to this floorplan. All floorplans are subject to final approval by local Fire Marshall

Freeman¹

6320 E Stassney Ln Bldg 3 Ste 375
 Austin | TX | 78744
 512.827.3200

This document contains confidential and proprietary information that may not be reproduced or divulged, in whole or in part, without prior written authorization from Freeman Audio Visual, LLC. No warranties, either expressed or implied, are made, including but not limited to compliance with any laws, rules or regulations related to COVID-19. All rights reserved © 2021 FREEMAN AUDIO VISUAL, LLC.

ALL FLOORPLANS ARE SUBJECT TO FINAL APPROVAL BY THE LOCAL FIRE MARSHALL AND/OR OTHER REQUIRED OFFICIALS

Pre-Function

Pre-Function

Pre-Function

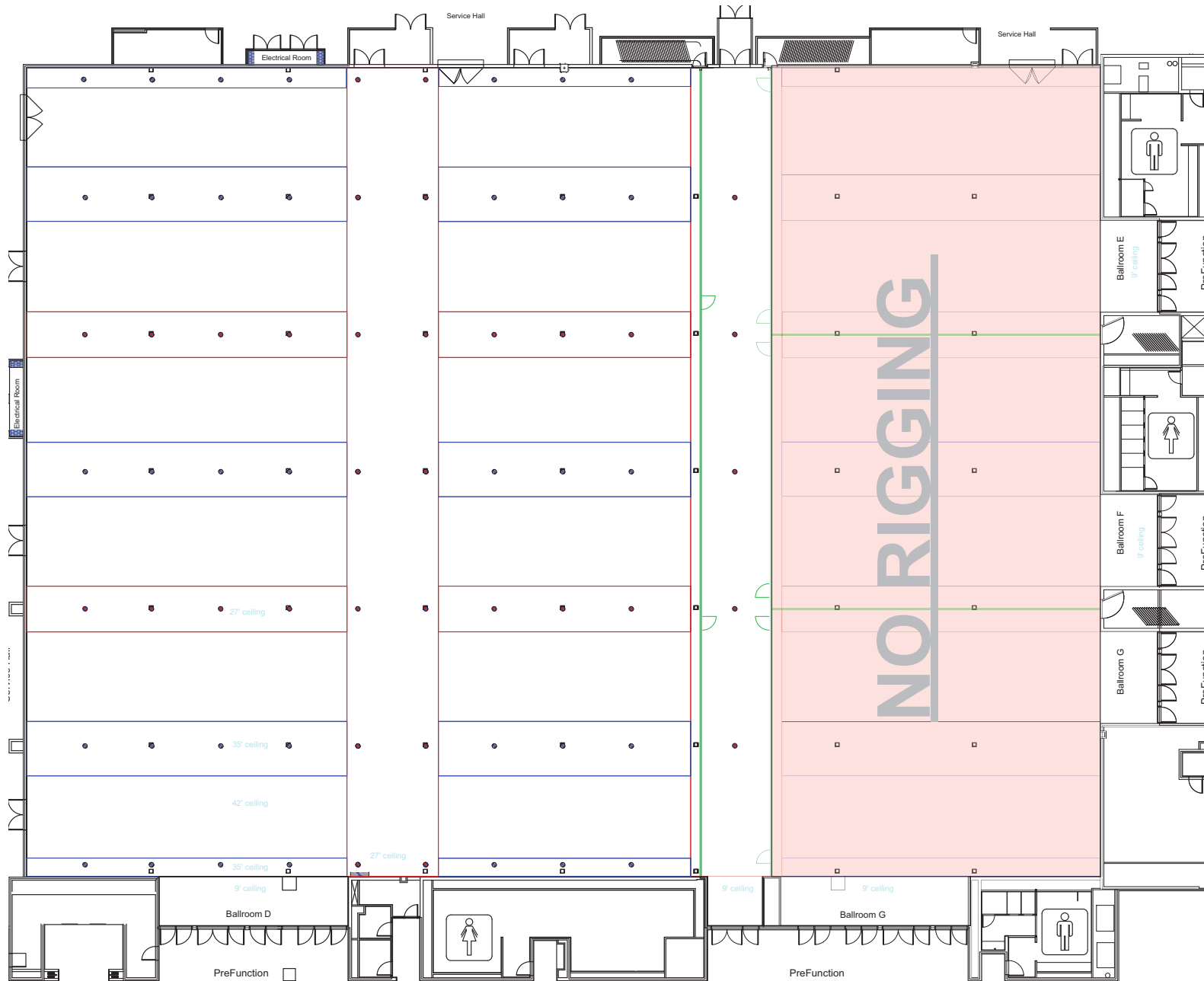

EVENT

AUSTIN
 CONVENTION CENTER
 DEPARTMENT

VENUE

Austin Convention Center
 500 E Cesar Chavez St
 Austin | TX | 78701
 512.404.4000

ROOM DETAIL

ROOM: Ballrooms D-G
DATE:
FUNCTION:
SEATING:

DRAWING DETAIL

VERSION: - **SCALE:** As Noted
REVISION DATE: 09/14/21
DRAWN / REVISED BY:
 Phil Sherrord
SHEET NUMBER: 1
SHEET NAME:
 Ballroom D Rigging
FILE NAME:
 ACC BR D-G.vwx

Freeman¹
 6320 E Stassney Ln Bldg 3 Ste 375
 Austin | TX | 78744
 512.827.3200

This document contains confidential and proprietary information that may not be reproduced or divulged, in whole or in part, without prior written authorization from Freeman Audio Visual, LLC. No warranties, either expressed or implied, are made, including but not limited to compliance with any laws, rules or regulations related to COVID-19. All rights reserved © 2121 FREEMAN AUDIO VISUAL, LLC.

ALL FLOORPLANS ARE SUBJECT TO FINAL APPROVAL BY THE LOCAL FIRE MARSHALL AND/OR OTHER REQUIRED OFFICIALS.

Freeman¹

- High Ceiling Airwalks Low Ceiling
- Rigging Points
 - High Points 32'
 - Ceiling Heights 27', 35'
 - Point Weight 1500 lbs
 - No Drilling
 - No Rigging in Ballrooms E, F, G**
- House Lights
 - End Coves- Fluorescent
 - Downlights
 - 2 x 2's Non-Dimmable
 - Glow Beams
 - House Lighting Zones
 - House Lighting DMX Channels
- Electrical
 - Floor Pockets 10 Amps 120V 1-10 Amps 200W 2 Phase
 - 400 Amp 3 phase Connection
 - 100 Amp Connection

This document contains confidential and proprietary information that may not be reproduced or divulged, in whole or in part, without written authorization from Freeman Audio Visual, Inc.

Every effort has been made to ensure the accuracy of all information contained on this floorplan. However, no warranties, either expressed or implied, are made with respect to this floorplan. All floorplans are subject to final approval by local Fire Marshal.