

Information about this document

Contents and purpose

This document describes the safe disassembly of the TS 98 XEA door closer and provides instructions for the proper recycling of the materials.

 The figures serve to provide a general understanding and may differ from the product model that is actually delivered.

Target group

This manual is designed for use by qualified assembling technicians. Due to their professional training and experience, as well as their knowledge of technical terminology and the relevant standards and regulations, a qualified assembling technician is able to dismantle the product and to detect and avert possible dangers independently. The assembling technician should have knowledge and experience in the following areas:

- Industrial safety, operational safety, and accident prevention regulations
- Using tools and machinery

Safety

Basic warnings

 **DANGER**

Risk of injury due to tensioned spring

The product contains a tensioned spring in the housing, which can cause injury if disassembled incorrectly.

- Wear personal protective equipment.
  - Only dismantle the door closer in accordance with this manual.
- ⇒ Further disassembly steps are not permitted!
- ⇒ In particular, the locking screws must not be dismantled, as the sudden release of the spring force poses a danger to life and limb!

Product description

TS 98 XEA

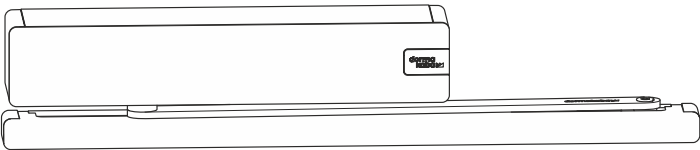

Components

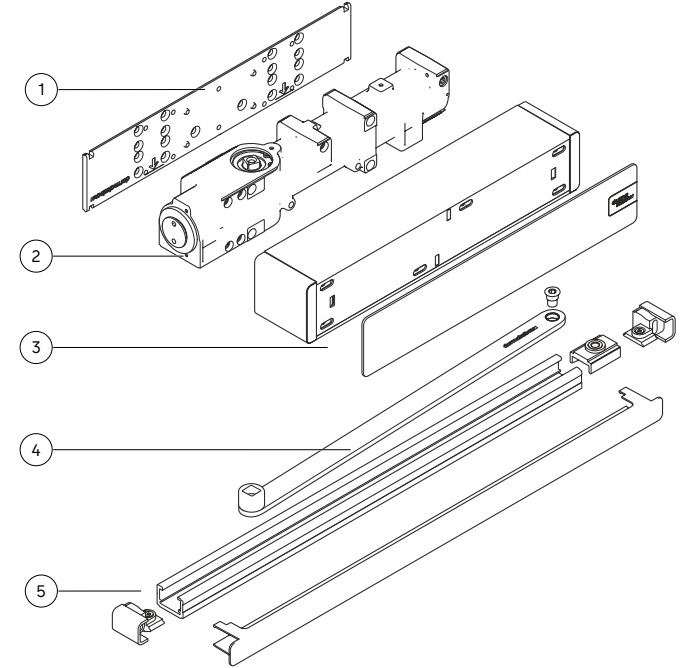

1	Mounting plate
2	Door closer
3	Cladding
4	Lever
5	Slide rail and cladding

## Disassembly and disposal

### Dismantling product

1. Remove the cladding of the door closer and the slide rail.

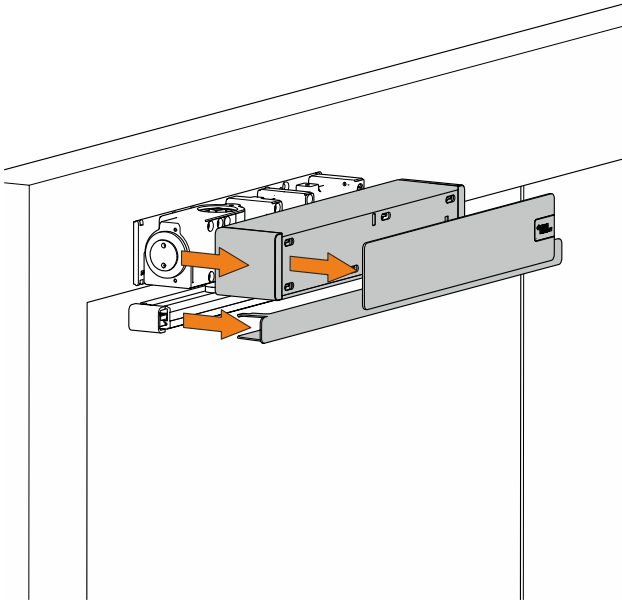

2. Open the door about 45°.
3. Close the 5 valves.

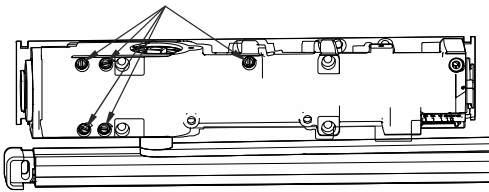

**NOTICE!** Depending on the mounting type, the direction of rotation is left or right.

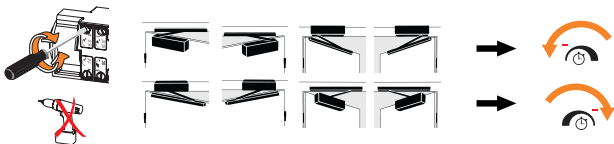

4. Unscrew the lever from the slide rail.

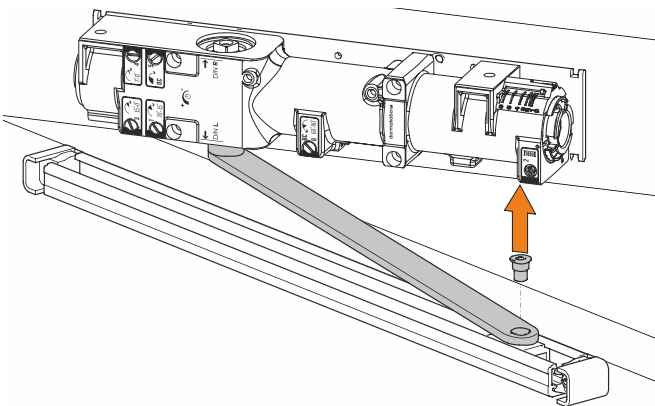

5. Unscrew the lever from the door closer.

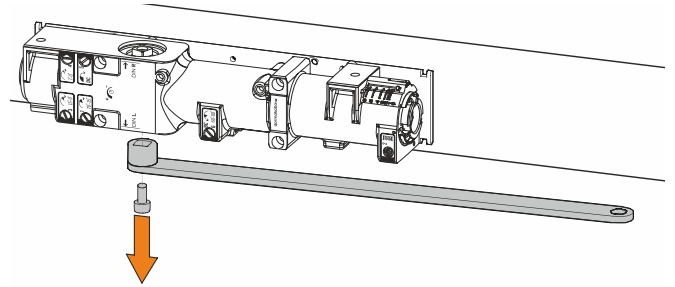

6. Unscrew the slide rail.

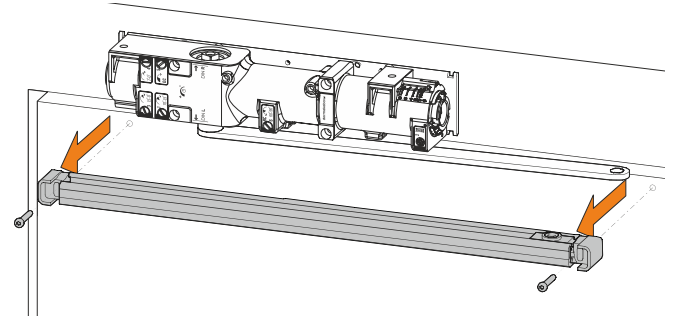

7. Remove the end caps.

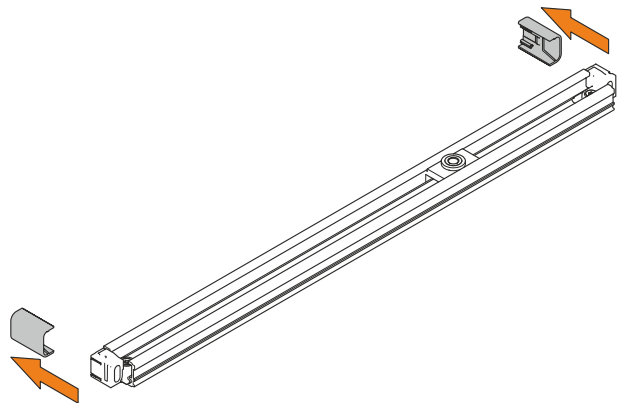

8. Unscrew the screws from the end pieces.

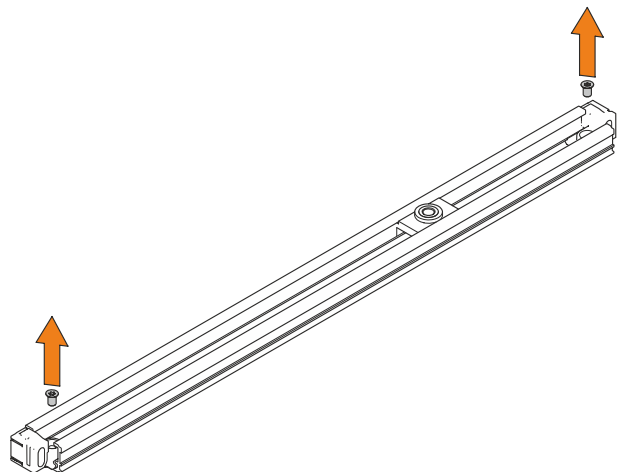

9. Remove the end pieces and the sliding block from the slide rail.

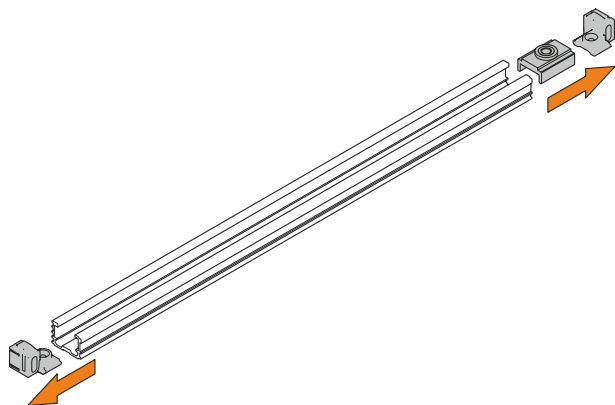

10. Unscrew the door closer.

11. Unscrew the mounting plate.

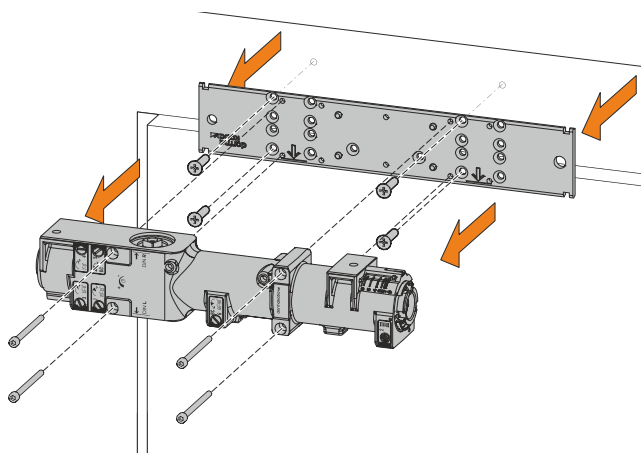

### Disposing of oil



The product contains oil and must not be disposed of in domestic waste. Oil must not be permitted to enter the sewerage network. Dispose of the product in an environmentally friendly manner at the collection points set up for this purpose. Observe the applicable national legal regulations.

### Material composition

All components must be analyzed and classified into the appropriate waste categories (e.g. metals, plastics and oil).

#### Aluminium

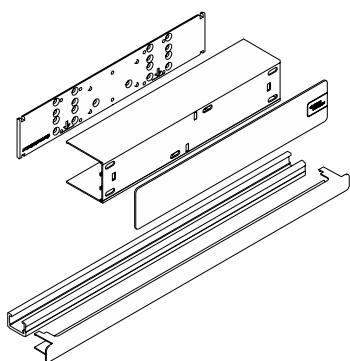

#### Steel

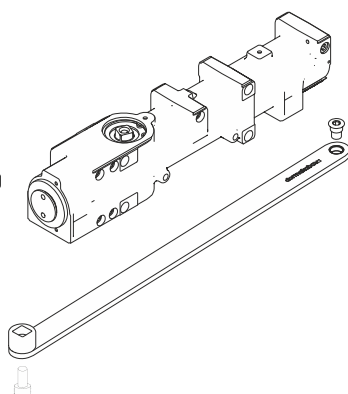

#### Polymers

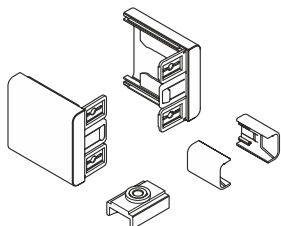

#### Zinc

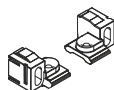

### Disposing of the product



Dispose of the product in an environmentally friendly manner at the collection points set up for this purpose. Refer to the statutory regulations for your country.

## Notes

[illegible]