

Province of Saskatchewan Land Titles Registry Title

Title #: 158888176
Title Status: Active
Parcel Type: Surface
Parcel Value: \$441,308.00 CAD
Title Value: \$441,308.00 CAD
Converted Title: 99SC06475
Previous Title and/or Abstract #: 142279218

As of: 08 Sep 2025 09:34:57
Last Amendment Date: 14 Jul 2025 08:58:36.566
Issued: 14 Jul 2025 08:58:36.380
Municipality: RM OF ARLINGTON NO. 079

DURHAM CREEK ENERGY LTD. is the registered owner of Surface Parcel
#143037389

Reference Land Description: NW Sec 24 Twp 07 Rge 20 W 3 Extension 0
As described on Certificate of Title 99SC06475.

This title is subject to any registered interests set out below and the exceptions, reservations and interests mentioned in section 14 of *The Land Titles Act, 2000*.

Registered Interests:

Interest #:
202275503

CNV Easement

Value: N/A
Reg'd: 15 Mar 1957 01:34:31
Interest Register Amendment Date: N/A
Interest Assignment Date: 03 Feb 2011
11:55:19
Interest Scheduled Expiry Date: N/A
Expiry Date: N/A

Holder:
PLAINS MIDSTREAM CANADA ULC
2900 - 550 BURRARD STREET
VANCOUVER, British Columbia, Canada V6C 0A3
Client #: 140016653

Int. Register #: 107093921
Converted Instrument #: DZ5671
Feature #: 100117741

Interest #:
202275491

CNV Easement

Value: N/A
Reg'd: 14 Sep 1989 00:28:10
Interest Register Amendment Date: N/A
Interest Assignment Date: N/A
Interest Scheduled Expiry Date: N/A
Expiry Date: N/A

NE - 0.45 HA, NW - 0.45 HA & SW - 0.002 HA

Holder:
Saskatchewan Telecommunications
13th Floor, 2121 Saskatchewan Drive
Regina, Saskatchewan, Canada S4P 3Y2
Client #: 100006861

Int. Register #: 107093909
Converted Instrument #: 89SC16904

Addresses for Service:

Name

Owner:

DURHAM CREEK ENERGY LTD.

Address

2400, 525 - 8TH AVENUE SW CALGARY, Alberta, Canada T2P
1G1

Client #: 139679005

Notes:

Parcel Class Code: Parcel (Generic)



Surface Parcel Number: 143037389

REQUEST DATE: Mon Sep 8 09:35:28 GMT-06:00 2025

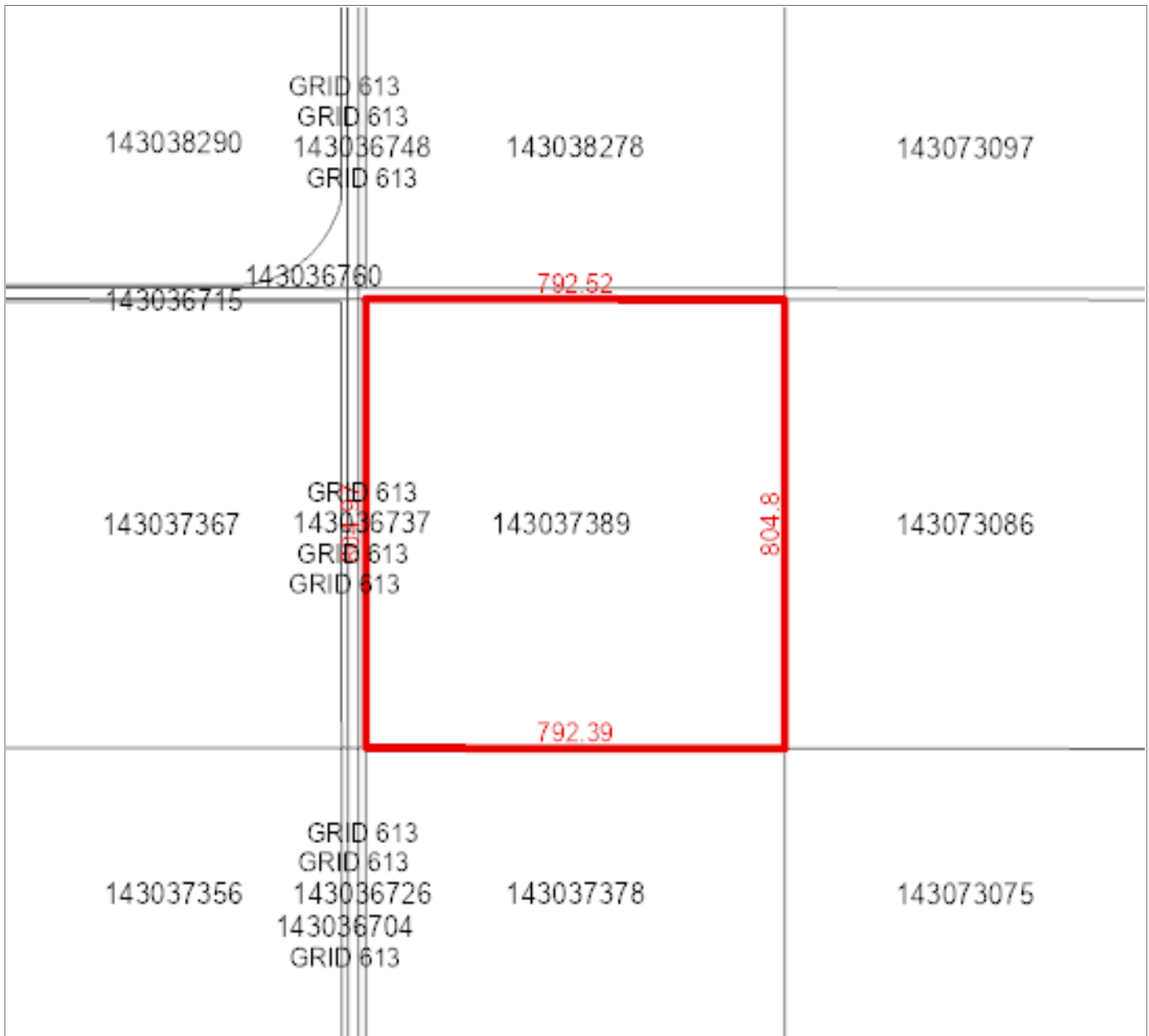

Owner Name(s) : DURHAM CREEK ENERGY LTD.

Municipality : RM OF ARLINGTON NO. 079

Title Number(s) : 158888176

Parcel Class : Parcel (Generic)

Land Description : NW 24-07-20-3 Ext 0

Source Quarter Section : NW-24-07-20-3

Commodity/Unit : Not Applicable

Area : 63.784 hectares (157.61 acres)

Converted Title Number : 99SC06475

Ownership Share : 1:1

Property Report

Print Date: 04-Nov-2025

Page 1 of 2

Municipality Name: RM OF ARLINGTON (RM)

Assessment ID Number : 079-000224200

PID: 200357002



Civic Address:

Legal Location: Qtr NW Sec 24 Tp 07 Rg 20 W 3 Sup

Supplementary:

Title Acres: 157.24

School Division: 211

Neighbourhood: 079-200

Overall PUSE: 2000

Call Back Year:

Reviewed: 05-Feb-2000

Change Reason:

Year / Frozen ID: 2025/-32560

Predom Code:

Method in Use: C.A.M.A. - Cost

AGRICULTURAL ARABLE LAND

Acres	Land Use	Productivity Determining Factors		Economic and Physical Factors		Rating	
45.00	K - [CULTIVATED]	Soil association 1	AD - [ARDILL]	Topography	T1 - Level / Nearly Level	\$/ACRE	1,787.50
		Soil texture 1	CL - [CLAY LOAM]	Stones (qualities)	S1 - None to Few	Final	47.54
		Soil texture 2		Phy. Factor 1	10% reduction due to SA2 - [90 : Salinity - Moderate]		
		Soil profile 1	OR10 - [CHERN-ORTH (CA 9-12)]	Natural hazard	NH: Natural Hazard Rate: 0.98		
		Soil association 2	KN - [KELSTERN]				
		Soil texture 3	CL - [CLAY LOAM]				
		Soil texture 4					
		Soil profile 2	Z-M - [CHERN SOLONETZ MOD]				
		Top soil depth	3-5				
83.00	K - [CULTIVATED]	Soil association 1	AD - [ARDILL]	Topography	T1 - Level / Nearly Level	\$/ACRE	2,004.16
		Soil texture 1	CL - [CLAY LOAM]	Stones (qualities)	S1 - None to Few	Final	53.30
		Soil texture 2	L - [LOAM]				
		Soil profile 1	OR10 - [CHERN-ORTH (CA 9-12)]	Natural hazard	NH: Natural Hazard Rate: 0.98		
		Top soil depth	3-5				
19.00	K - [CULTIVATED]	Soil association 1	RO - [ROBSART]	Topography	T1 - Level / Nearly Level	\$/ACRE	938.89
		Soil texture 1	CL - [CLAY LOAM]	Stones (qualities)	S1 - None to Few	Final	24.97
		Soil texture 2		Phy. Factor 1	50% reduction due to SA5 - [50 : Salinity - Severe]		
		Soil profile 1	Z-M - [CHERN SOLONETZ MOD]	Natural hazard	NH: Natural Hazard Rate: 0.98		
		Top soil depth	3-5				

AGRICULTURAL WASTE LAND

Acres	Waste Type
7	RAVINE
3	WS & SALINE-WASTE

Property Report

Municipality Name: RM OF ARLINGTON (RM)	Assessment ID Number : 079-000224200	PID: 200357002
---	--------------------------------------	----------------

Assessed & Taxable/Exempt Values (Summary)

Description	Appraised Values	Adjust Reason	Liability Subdivision	Tax Class	Percentage of value	Taxable	Adjust Reason	Exempt	Adjust Reason	Tax Status
Agricultural	\$264,700		1	Other Agricultural	55%	\$145,585				Taxable
Total of Assessed Values:	\$264,700				Total of Taxable/Exempt Values:	\$145,585				