

## ANNUAL LEASE INFORMATION FOR TRIPLE OFF HWY 59

### PARCEL 1: SE-3-74-11-W6TH & DECRPTIVE PLAN 1124027 BLOCK 1 LOT 1

CANADIAN NATURAL RESOURCES LIMITED. \$ 4,100.00  
(Surface Lease dated: August 2, 2002)

### PARCEL 2: NE-14-74-11-W6TH

- -

### PARCEL 3: SE-23-74-8-W6TH

CANADIAN NATURAL RESOURCES LIMITED. \$ 5,875.00  
(Surface Lease dated: September 29, 1994)

**GRAND TOTAL OF 3 PARCELS** **\$ 9,975.00**

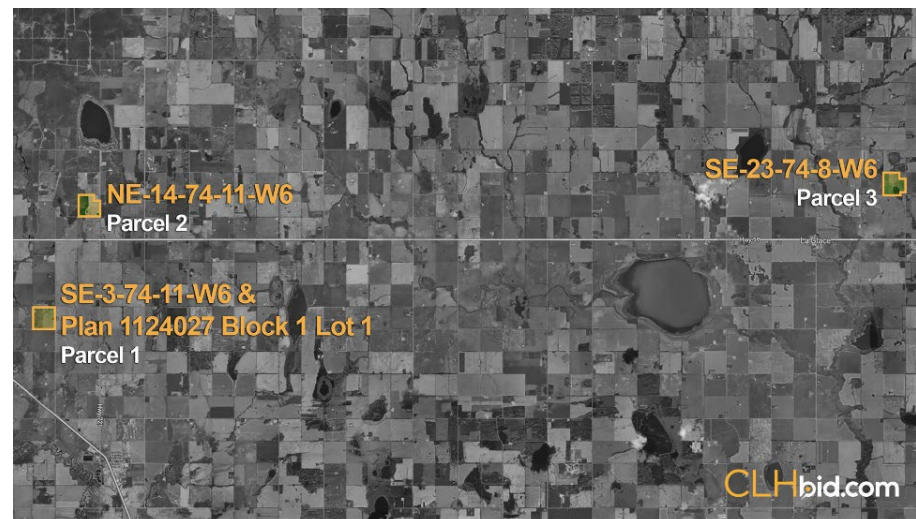

This statement is based on information provided to us. The information is believed to be correct, but its accuracy cannot be guaranteed. Errors and/or omissions discovered prior and after auction shall be adjusted directly between the parties. E. & O.E.