

Plug&Play

Manual for installing the
KPN TV+ Soundbox.



Before you start

The KPN TV+ Soundbox is easy to install yourself.
We will explain it step by step.

Having trouble? We're here to help.

Our experts are ready to help you at phone number 0800 0402
(free of charge). If you need extra help, a technician will visit you.

We have also made a video in which the installation steps are
described and read aloud.

**Scan the QR code
for the video.**



Check the 6 points before you start:

- 1.** Is the modem Experia Box or KPN Box 12 or 14 or Fritz!box successfully connected?
- 2.** Is today the connection date mentioned in the email or letter?
- 3.** Is there a free power outlet at the place where you want to place the KPN TV+ Soundbox?
- 4.** On the back of the modem you will find a sticker with the network name and password. You need this information if you are going to connect via Wi-Fi. Take a photo of it. Have you changed your Wi-Fi details? Then use those details.
- 5.** To use the KPN TV+ Soundbox, you need the subscription number and PIN code. You have received these by email and SMS.
- 6.** To use Google Assistant (Hey Google), you need a Google Account. You can then give voice commands without a remote control. For example, "Hey Google, go to NPO 1."

In the box of the KPN TV+ you will find the following components

<p>Photo KPN TV+ Soundbox</p> 	<p>The KPN TV+ Soundbox</p>
<p>Photo adapter</p> 	<p>Adapter to connect it</p>
<p>Photo Remote Control</p> 	<p>The remote control. There are 2 batteries attached here. The back of the remote control can be opened and this is where the batteries should go.</p>

Photo Ultra HDMI cable

With the Ultra HDMI cable you connect the TV to the KPN TV+ Soundbox

Photo Ethernet cable

The ethernet cable with yellow plugs at the ends.

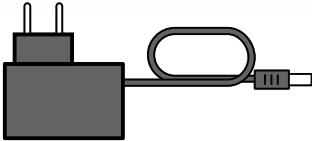
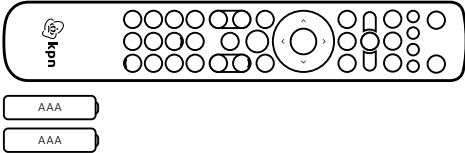
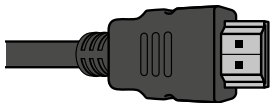
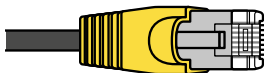
What does the KPN TV+ Soundbox look like?

Below is a photo of the KPN TV+ Soundbox



Top of the KPN TV+ Soundbox

On the top of the KPN TV+ Soundbox you can feel two buttons. The first button is a slider for the microphone. With this, you turn the Google Assistant on or off. You turn it on by sliding the button down. Up is off. The second round button is the On/Off button.

Below is a photo of the connection points



**On the back of the KPN TV+ Soundbox are the connection points.
From left to right**

- 1.** The first connection point is the 12V DC connection for the power adapter.
- 2.** The 2nd connection point is an ethernet port.
- 3.** The 3rd connection point is a flat port for the HDMI cable.
- 4.** The 4th connection point is a USB port.
- 5.** The 5th is a small hole. This is the reset hole.

STEP 1:

Connecting the KPN TV+ Soundbox

You can connect the KPN TV+ Soundbox in two ways. The first option is with the ethernet cable to the modem. The second option is via Wi-Fi. This is only possible if your modem is a KPN Box 12, KPN Box 14, or a Fritz!box.

Option 1. Connecting the KPN TV+ with a cable

Three points of attention:

- 1.** For the best picture quality; use the supplied Ultra HDMI cable.
- 2.** Keep your subscription number and PIN code that you received by email and SMS at hand.
- 3.** Keep your Google Account details at hand. You need these if you want to use the Google Assistant (Hey Google) function of your KPN TV+ Soundbox.

Connecting the KPN TV+ Soundbox

- 1.** Check if your TV is turned off.
- 2.** Connect the ethernet cable with yellow plugs to the second connection point or the ethernet port of your KPN TV+ Soundbox and any yellow ethernet port of the modem.
- 3.** Connect the supplied HDMI cable to the 3rd connection point or HDMI port of the KPN TV+ Soundbox and the other end to an HDMI port on your TV.
- 4.** Connect the cable of the power adapter to the first connection point or 12V DC of the KPN TV+ Soundbox and plug it into the power outlet.

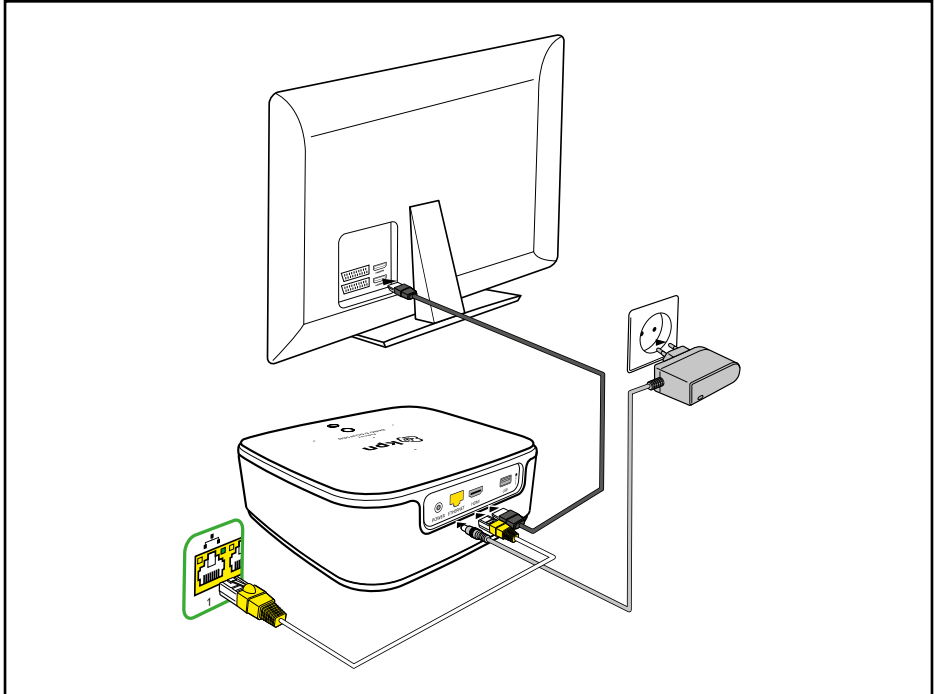

Option 2. Connecting the KPN TV+ Soundbox via Wi-Fi.

Five points of attention:

- 1.** For the best picture quality; use the supplied Ultra HDMI cable.
- 2.** Your modem is a KPN Box 12, 14 or a Fritz!Box
- 3.** Keep your Wi-Fi name and password at hand.
- 4.** Keep your subscription number and PIN code that you received by email and SMS at hand.
- 5.** Also keep your Google Account details at hand. You need these if you want to use the Google Assistant (Hey Google) function of your KPN TV+ Soundbox.

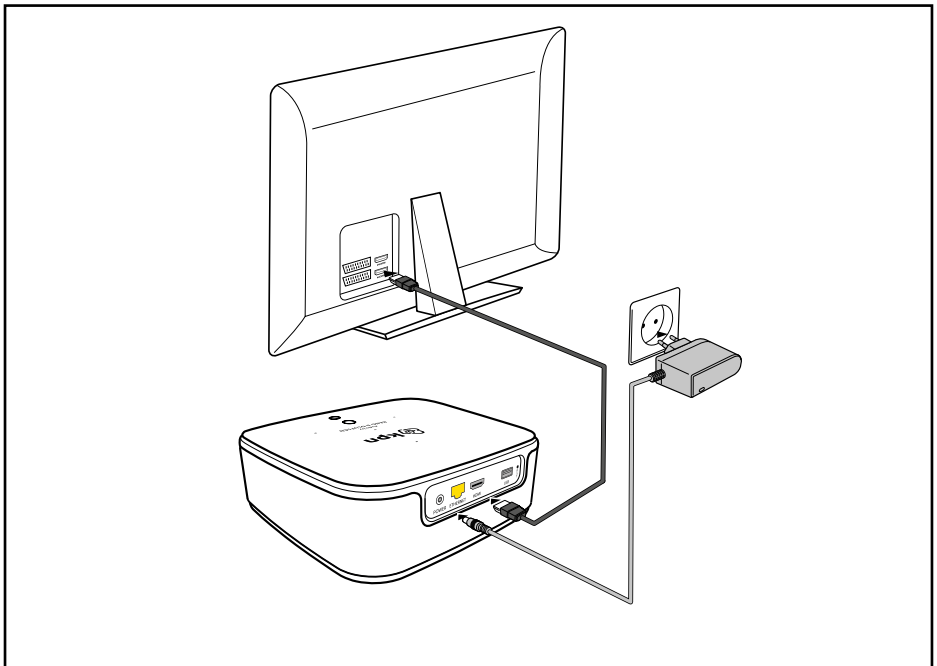

Connecting the KPN TV+ Soundbox

- 1.** Check if your TV is turned off.
- 2.** Connect the supplied HDMI cable to the 3rd connection point or HDMI port of your KPN TV+ Soundbox and the other end to an HDMI port on your TV.
- 3.** Connect the cable of the power adapter to the first connection point **12V DC** of the KPN TV+ Soundbox and plug it into the power outlet.

Step 3.

Activating the KPN TV+ Soundbox

- 1.** Place the KPN TV+ Soundbox in the middle in front of the TV for the best sound experience.
- 2.** Turn on your TV.
- 3.** No picture? Then select the correct HDMI source with your TV's remote control. This button differs per TV type (/AV/EXT).
- 4.** The KPN TV+ Soundbox is starting up.
- 5.** In the meantime, insert the batteries into the supplied remote control. On the back of the remote control there is a cover that you can slide down to insert the batteries.
- 6.** After starting up, you will receive instructions via your TV screen. Follow the on-screen instructions using the reading app or reader.

Extra information about Accessibility

1. Subtitles

Press the Home button on the remote control. Use the round arrow key to go up. Go to Settings and select Accessibility in the menu. In this menu, select Subtitles.

Tip: Subtitles remain on even when you change channels.

2. Talkback function:

By enabling the Talkback function, the text on the screen will be read aloud. If you press and hold the number 5 for 3 seconds, you turn the talkback function on or off.

3. Google Assistant.

On the remote control, row 7, the 3rd button is the Google Assistant button. If you hold this button, you can give commands to your KPN TV+ Soundbox. Always start the sentence with Hey Google. An example of a command: Hey Google, go to NPO 2.

Did you enter your Google account details during installation?

Then turn on the slider on top of the KPN TV+ Soundbox. You can then give voice commands without a remote control.

Congratulations! You're now connected.

We recommend downloading the MijnKPN app. This app tells you everything about the status of your modem. In addition, the MijnKPN app answers all your questions and you get nice gifts under “For you”

Scan the QR code.

